



# Sundram Fasteners Limited

## RETAIL PRICE LIST

NO.SF/SOCKET/02/2026

SOCKET PRODUCTS-STANDARD APPLICATION

Effective 1st April 2026

## SOCKET PRODUCTS

Marketing Office	Registered Office
<p>Padi, CTH Road, Chennai - 600 050, India Tel: +91-44 2625 8460 Fax: +91-44 2625 7493</p>	<p>98A, 7<sup>th</sup> Floor, Dr. Radhakrishnan Salai, Auras Corporate Centre, Mylapore, Chennai – 600 004, India Tel: +91-44 2847 8500 Fax: +91-44 2847 8508</p>

Manufacturing Plants			
Padi Hex & HNF Units	Pondy Unit	Krishnapuram Unit	Uttarakhand Unit
<p>Padi, CTH Road, Chennai - 600 050, India Tel: +91-44 2625 8460 Fax: +91-44 2625 7493 GST No.: 33AAACS8779D1Z7</p>	<p>Korkadu, Villianur (Via) Puducherry – 605 110, India Tel: +91-413 2666440 Fax: +91-413 2666441 GST No.: 34AAACS8779D1Z5</p>	<p>126, 133-139, NH 45B, Madurai Taluk, Virudhunagar Dist. Aviyur – 626 115, India Tel: +91-4566 255466/7 Fax: +91-4566 255448 GST No.: 3AAACS8779D1Z7</p>	<p>Plot No. 60, Sector 11, Integrated Industrial Estate Pantnagar, Sidcul, Rudrapur Udham Singh Nagar, Uttarakhand 263 153 GST No.: 05AAACS8779D1Z6</p>
<b>WEF &amp; INFRA UNIT</b>			
<p>135/3, 136-1, Mandagapattu Road, Mitta Mandagapattu Village Villupuram Dist. 605 106 India GST No.: 33AAACS58779D1Z7</p>			
<p>CIN No. L359999TN1962PLC004943 GST No.: 33AAACS58779D1Z7 Website: www.sundram.com E-mail: marketing@fasteners.sfl.co.in</p>			



Intertek





## GENERAL CONDITIONS FOR SALE

### (RELATED TO PRICE LIST NO.SF/SOCKET/02/2026)

All quotations, purchase orders or requests are subject to the following terms and conditions of sale. Any qualifications to these conditions made by the Buyer will not apply unless expressly accepted in writing by Sundram Fasteners Limited (hereinafter, called as "SFL"). These General Terms and Conditions of Sale shall not be applicable where SFL and Buyer had entered into Product Sale/Purchase/Supply Agreement. In the event of any dispute, ambiguity in interpretation or claim between SFL and the Buyer the Product Sale/Purchase/Supply Agreement and its specific terms shall apply first. To the extent that the individual Product Sale/Purchase/Supply Agreement and its specific terms are silent, the General Terms and Conditions herein shall apply. If the General Terms and Conditions of Sale are silent, the general rules of the governing law shall apply and prevail.

#### 1. ORDER AND ACCEPTANCE

All orders placed by the Buyer shall be subject to SFL's acceptance. SFL shall be at liberty to accept or refuse any order in full or in part without assigning any reasons whatsoever. Orders once accepted by SFL shall not be cancelled by the Buyer unless consented to or by SFL in writing. None of these terms and conditions may be added to, modified, superseded or otherwise altered, except by a written instrument signed by an authorized signatory of SFL. SFL's failure to object to any of the terms and conditions which may be contained in any document of Buyer shall not be construed as a waiver of these conditions or as acceptance of any such terms and conditions.

#### 2. PRICES AND PAYMENT

- 2.1 Prices prevailing on the date of dispatch of Goods will become applicable irrespective of the fact that Purchase order/delivery order/advance payment for the same been accepted/issued by SFL.
- 2.2 SFL reserves the right to revise the prices of Goods without any further advance notice to the Buyer or without assigning any reasons thereof.
- 2.3 SFL shall not be responsible for costs, charge, expenses, losses etc., if any, incurred by the Buyer.
- 2.4 The Prices are exclusive of GST as applicable on the Goods supplied. SFL shall collect TCS as applicable on the Goods supplied to Buyer.
- 2.5 Any taxes, cess or duties levied by Central, State, Municipal, Local or any other authority, in effect or hereinafter imposed, on the sale, transportation or delivery of the Products delivered hereunder shall be paid by Buyer, and, if directly paid by SFL, reimbursed to SFL by Buyer with retrospective or prospective effect.
- 2.6 The Cheque/Drafts/Pay Orders not accepted unless otherwise specifically agreed in writing. The Cheque/Drafts/Pay orders should be drawn by the Buyer in favour of Sundram Fasteners Limited. SFL shall not be liable to loss or theft of Cheque/Drafts/Pay orders etc., in transit.
- 2.7 Payment terms are net thirty (30) days from the date of the invoice or as mutually agreed in writing.
- 2.8 Any payments not made within due date shall be subject to a late payment charge for the period of delay beyond due date, penal interest at 18 % per annum.
- 2.9 SFL reserves its right to appropriate and adjust any sums due to the Buyer against any dues recoverable from the Buyer including delayed payment charges, if any.
- 2.10 All stipulations as to time of payment of the purchase price of Goods are the essence of the Contract.

#### 3. LOSS OR DAMAGE

Unless otherwise agreed, the risk in the Goods shall pass from SFL to the Buyer the moment they are delivered by SFL to the Buyer or to a Carrier or any other party including Warehouse operated/identified for the purpose (whether named by the Buyer or not) including risk associated with any Goods subsequently returned to SFL. SFL accepts no liability for loss or damage to Goods once handed over to the Buyer or Carrier any other party including Warehouse operated/identified for the purpose instructed/chosen by Buyer.

#### 4. PACKING AND TRANSPORTATION

- 4.1 Unless otherwise specified by the Buyer, SFL will select the most economical method and route of shipment. In the event that the Buyer is unable or unwilling to take delivery of all or any part of the Goods, SFL shall place them into storage with all costs, including storage, insurance, demurrage, and transportation at the Buyer's expense.
- 4.2 Packing will be in accordance with SFL/Industry standard practice and Prices quoted are for packing in cartons. SFL retains ownership of any re-usable packaging.

#### 5. DELIVERY AND ACCEPTANCE

- 5.1 The delivery dates are tentative and no responsibility is accepted by SFL for delay in delivery or failure to deliver as per delivery schedule due to circumstances beyond SFL's control. Delivery/Despatch may be made in one lot or several lots and if made in several lots payment should be made in terms of the payment clause.
- 5.2 Goods supplied shall be deemed to have been supplied as per the Buyer's specifications unless the Buyer, within 48 hours from the receipt of the Goods give SFL a written notice of any claim, that the Goods are not of stated description or specification to enable SFL to investigate and take appropriate action.
- 5.3 SFL will not be responsible for any shortage/damages notices after delivery has been taken by the Buyer and not reported on the back side of "Lorry Receipt" of Transporter.
- 5.4 The Buyer shall provide SFL with the appropriate tax forms/declarations along with payment and shall indemnify SFL against any losses, charges, expenses for non- submissions of the forms.
- 5.5 The Goods shall be dispatched at such times and in such convenient lots and quantities as SFL shall decide. SFL shall be entitled to cancel an order in whole or in part even if it has been partly executed. Each lot dispatched against a single order shall be considered as a separate contract and failure of dispatch of any one lot or of the balance lots shall not violate the contract as to other lots. The order shall be deemed to have been completed on the date of dispatch in respect of the products actually dispatched in part/full.
- 5.6 SFL shall not be responsible for delays in dispatch of the Goods for any reason whatsoever and the conditions of dispatch and delivery timing of the same. SFL shall not be liable to make good the loss, if any suffered by the Buyer for delay in dispatch or delivery of the Goods.
- 5.7 If the Buyer failed to take delivery of the Goods at the rate, date and time specified herein when the delivery becomes due, then SFL will have the option to cancel the delivery and to claim damages, if any.
- 5.8 Claims by Buyer for shortages or errors in delivery must be made within five (5) days after the delivery of the Goods. Goods are sold subject to the standard manufacturing practices of SFL. Goods purchased on the basis of weight are subject to customary quantity variations recognized by practice in the industry.
- 5.9 If Buyer requests deferral of deliveries, SFL's agreement to defer delivery shall not excuse Buyer from its obligation to pay for the Goods at the same times and in the same quantities as the original delivery schedule, including interest due pursuant to these terms and conditions. In addition to adhering to the original payment schedule, Buyer shall pay such storage charges as SFL may assess for storing the Goods awaiting delivery. If Buyer requests deferral prior to commencement of production, SFL may require progress payments in connection with expenses for materials and services incurred by SFL in anticipation of production.
- 5.10 In no case shall delay or non-delivery of the whole or part of the order be a valid ground for the Buyer to reject or withhold payment for the Goods.

#### 6. WARRANTY

- 6.1 All Goods sold subject to the conditions that SFL's liabilities are limited to the replacement of Goods proved to have been defective in material and/or workmanship, when they are sent back to SFL, but SFL will not be responsible for failure of Goods supplied which have been subject to improper use and/or any process or processes.
- 6.2 SFL accepts no responsibility for any contingent or resulting liabilities or loss arising through any defective Goods.
- 6.3 Any claim for replacement will arise only if the Goods are returned within 30 days from the date of Supply.



- 6.4 All other warranties, express or implied, including but not limited to the implied warranties of merchantability and fitness for a particular purpose, are hereby disclaimed.
- 6.5 Any claims for failure of Goods to conform to specifications, shortages, or any other cause shall be deemed waived and released by Buyer unless such claim is made in writing within thirty (30) days from the date of receipt of Goods.
- 6.6 SFL's decision on the cause for any such defects is final and binding.
- 6.7 SFL will not be responsible for failure of Goods supplied which are manufactured to the print, design, technical specification of the Buyer or sample/prototype approved by Buyer and/or any process or processes prescribed by Buyer.

#### 7. LIMITATION OF LIABILITY

SFL's liability to Buyer, whether in contract, in tort, under any warranty, in negligence or otherwise, shall not exceed in any case the return of the amount of the purchase price paid by Buyer and under no circumstances SFL be liable for special, in direct or consequential damages. The price stated for the Goods is consideration for limiting SFL's liability. No action, regardless of form, arising out of the transactions under the invoice may be brought by Buyer more than one (1) year after the date of the invoice. Without limitation of the foregoing, in no event will SFL be responsible or liable for (a) penalties or penalty clauses of any description, or (b) indemnification of Buyer or others for costs, damages or expenses arising out of or related to the Goods.

#### 8. INDEMNIFICATION

Buyer shall save and hold SFL harmless from any claims, demands, liabilities, costs, expenses or judgments arising in whole or in part, directly or indirectly, out of breach of obligations, non-compliance any statute/act/rules, negligence, any act or omission, lack of care by Buyer or Buyer's customers, agents, employees or invitees involving the handling, use, possession or resale of the Goods supplied by SFL whether used alone or in combination with other Products. This indemnification shall include all costs, attorney's fees and other expenses paid or incurred by or imposed upon SFL in connection with the defense of any such claim.

#### 9. FORCE MAJEURE

SFL shall not be liable in any way for any damage, loss, cost or expense arising out of or in connection with any delay, restriction, interference or failure in performing any obligation towards supply or delivery of Goods caused by any circumstance beyond its reasonable control, including, without limitation, acts of God, laws and regulations, administrative measures, orders or decrees of any court, earthquake, flood, fire, explosion, war, terrorism, riot, sabotage, accident, epidemic, strike, lockout, slowdown, labour disturbances, geo-political events, business exigencies, difficulty in obtaining necessary labour or raw materials, lack of or failure of transportation, breakdown of plant or essential machinery, emergency repair or maintenance, breakdown or shortage of utilities, delay in delivery or defects in Goods supplied by suppliers or subcontractors ("Force Majeure"). Any failure in performing any obligations shall not entitle the Buyer to cancel the Order.

#### 10. INTELLECTUAL PROPERTY RIGHTS

- 10.1 The sale of Goods to Buyer shall not, by implication or otherwise, convey any license or intellectual property right relating to the Goods to Buyer.
- 10.2 When Goods are manufactured to Buyer's drawings and/or specifications, the responsibility to ensure that these do not result in infringement of any patent or trademark will lie entirely with the Buyer concerned and the Buyer will be solely responsible for the consequence in case of any such infringement.
- 10.3 SFL owns and retains all right, title and interest in and to any patents, copyrights, mask works, trade secrets, trademarks and other intellectual property rights in and to the Goods. The Buyer is not permitted to use any SFL's trademark, logo or trade name in its letter head, business cards, printed materials, business communication letters or in connection with any Goods, other than with respect to resale of Goods pre-marked or packaged by or on behalf of SFL without prior written consent of SFL.
- 10.4 SFL shall not be liable for any loss or damage for infringement of Intellectual Property Rights.

#### 11. CONFIDENTIALITY

All information disclosed by SFL which is either expressly identified as confidential or by its nature is implicitly confidential will be kept in strict confidence by the Buyer and not used by the Buyer.

#### 12. APPLICABLE LAW, JURISDICTION & ARBITRATION

- 12.1 Any dispute which may arise from and for any Goods supplied to Buyer shall be governed by the Indian laws and subject to the exclusive jurisdiction of the Courts at Chennai.
- 12.2 Any dispute in connection with or arising between the parties fail to amicably resolve shall be referred to arbitration of a sole arbitrator to be appointed jointly by the parties in accordance with the Indian Arbitration and Conciliation Act, 1996 or statutory modification or enactment thereof. The award of the arbitrator shall be final and binding on the Parties. The place of arbitration shall be Chennai, India, and the language of arbitration proceedings shall be English. Each party irrevocably and unconditionally submits to the jurisdiction of the Courts in Chennai, India, alone to determine any question that may arise other than a matter as provided for hereinabove.

#### 13. MISCELLANEOUS

- 13.1 All notices or documents addressed to the Buyer shall be deemed to have been validly served if delivered at/or sent by post to their last known address. SFL will not be responsible for any demurrage etc., on consignment due to public holidays, postal delays, etc. or any other reasons beyond SFL's control.
- 13.2 In case the Buyer fails to make payment on or before Due Date, the Buyer shall be fully responsible for all the consequential losses to SFL including loss of Goods, interest, freight, taxes, duties and any other charges required to be borne by SFL.
- 13.3 If the Buyer fails to make the payment when it becomes due or if there is any breach by the Buyer of any terms and conditions, SFL may without prejudice to the other rights or remedies cancel this order forthwith or refuse to make further deliveries; in which SFL shall not be held responsible in anyway.
- 13.4 SFL shall have lien on the Goods delivered/supplied to the Buyer as to the unpaid purchase price of Goods (whether in possession or not in possession) and SFL shall be entitled to exercise the lien to recover the unpaid purchase price by taking back the Goods and shall be entitled to sell the same to any other Buyer and adjust the sum so realised against the unpaid purchase price without prejudice to SFL's other rights and remedies to recover the outstanding dues and/or other dues.
- 13.5 SFL reserves its right to appropriate and adjust any sums due to the Buyer against any dues recoverable from the Buyer including delayed payment charges, if any.
- 13.6 The rights and liabilities are not assignable by Buyer in whole or part without prior written consent of SFL.
- 13.7 Any provision hereof prohibited by law shall be ineffective to the extent of such prohibition and without invalidating the remaining provision hereof.
- 13.8 No waiver by SFL of a breach of any provision hereof shall constitute a waiver of any other breach of such provision or any other provision.
- 13.9 Buyer shall be responsible for compliances of law as applicable.
- 13.10 The price mentioned in the Invoice supersedes the list circulated and all the previous price lists and any other price communication.
- 13.11 The prices are for Zinc phosphate, Trivalent (Chrome free) Finish.
- 13.12 The Buyer will adhere to the minimum ordering quantities, i.e. standard packing.
- 13.13 Revision in price if any will be intimated from time to time in the form of Sales Bulletins.

Please quote correct SFL Part Number and Description of items while ordering. For any grievance, claim or clarification please write to - vasudevan.r2@sfl.co.in (Email-ID) and also contact the SFL's Marketing Dept.



## SFL Retail Claim Policy 2026-27

1st April 2026

This Claim Policy document provides the guidelines on reporting the discrepancy claims by SFL Retail Customers for the goods dispatched from SFL Plants across India

Claim Types – The below are the various types of problems for which a customer can register a formal complaint

- Consignment not received (A)
- Partial Consignment received (B)
- Secondary Carton Shortage (C)
- Open Box Receipt (D)
- Quantity Shortage (E)
- Invoice / LR Not received (F)
- Wrong Consignment Received (H)

### CLAIM LODGING PROCESS:

**Process for Lodging Discrepancy Complaints** – The complaints can be lodged in the prescribed complaint format provided by SFL. The claim sheet can be either scanned or emailed as an excel sheet to the earmarked SFL Claim Desk and the respective Marketing personnel at SFL.

SFL Claim Desk                      [claimsfld@sfl.co.in](mailto:claimsfld@sfl.co.in)

**Timeline for Registering Complaints** – All complaints need to be lodged in the prescribed complaint format within 15 days from receipt of material since all consignments are door delivered at customer end by SFL, which is mandatory as per GST Norms. If any claims are lodged after the stipulated days specified above claims will not be processed.

### CLAIM SETTLEMENT PROCESS:

#### Short/Excess Receipt complaints:

- The first step in order to start the claims process is to register a complaint in the format provided. (refer annexure A)
- Customer should compulsorily provide their Unique Claim reference number for every claim reported to SFL
- **\*\*Customer should compulsorily provide the photos of the DA labels pasted on the Master Cartons/ MRP Labels pasted on the Primary Cartons without which claims will not be processed**
- Within 7 working days, SFL will respond back to the customer on whether the claim has been accepted or rejected with valid proof
- For Claims accepted , SFL will register the claim as appropriate shortage and to raise an invoice on the excess receipt materials if any reported by the customer and the **Claim registration**



- number (CMR/MRN No.) and excess claim order acknowledgement will be notified to the customer
- **\*\*In case of Wrong / Excess receipt reported by the customer, customer has the option to notify the acceptance of wrong / excess receipt parts.**
- **\*\*Customer has the option to return the wrong/excess received parts, by notifying the return in SFL Claim Format**
- **\*\*Customer need to return materials only to the concerned SFL Plant from where supplies were received by them**
- **\*\*Materials to be despatched on Door Delivery mode only on “To Pay” basis through the same SFL Transporter through whom they had received the supplies**
- **\*\*Debit Note/Invoice raised by them on the respective SFL Plant should accompany the materials**
- **\*\*Materials should strictly accompany with valid e way bills as per GST Norms which is mandatory**
- **\*\*Customer should share the Debit Note/Invoice copy raised on SFL by duly sharing the same in soft form to SFL Claims Desk along with the duly filled in Claim Form**
- **\*\*In the absence of valid Debit Note/Invoice on SFL, SFL will not entertain the settlement of credit notes for the short supplied materials**
- An unique complaint reference number (MRN No.) will be communicated to the customer within 3 working days upon receipt of the materials into SFL Plant along with the copies of the debit note/invoice copy of the returned material if any raised on SFL
- SFL will communicate the Credit Note Details and excess claim invoice details (in case of excess reported ) within 15 working days to the customer

#### **Material Returns:**

- **\*\*Any materials returned by the customer should be notified to SFL Area Executive/Manager & HO and obtain their approval and then register the same in the complaint format provided. (refer annexure A)**
- **\*\*In the absence of non approval from the SFL Area Executive/Manager & HO, SFL will not entertain any claim settlements against the material returns**
- SFL will respond to the customer duly authorizing the material returns only in case of valid reason for material return provided by the customer
- **\*\*Customer need to return materials only to the concerned SFL Plant from where supplies were received by them**
- **\*\*Materials to be despatched on Door Delivery mode only on “To Pay” basis through the same SFL Transporter through whom they had received the supplies**
- **\*\*Debit Note/Invoice raised by them on the respective SFL Plant should accompany the materials**
- **\*\*Materials should strictly accompany with valid e way bills as per GST Norms which is mandatory**



- **\*\*Customer should share the Debit Note/Invoice copy raised on SFL by duly sharing the same in soft form to SFL Claims Desk along with the duly filled in Claim Form**
- **\*\*In the absence of valid Debit Note/Invoice on SFL, SFL will not entertain the settlement of credit notes for the short supplied materials**
- An unique complaint reference number (MRN No.) will be communicated to the customer within 3 working days upon receipt of the materials into SFL Plant along with the copies of the debit note/invoice copy of the returned material if any raised on SFL
- SFL will communicate the Credit Note Details and excess claim invoice details (in case of excess reported ) within 15 working days to the customer

#### **Documentation Requirements for Type of Complaints:**

Customer need to provide different types of documentation required for each claim type to facilitate smooth registration and settlement of the claims

- Consignment not received (A) – Complaint through Mail reporting non receipt of consignments against specific invoice/LR is sufficient
- **\*\*Partial Consignment received (B) – While taking consignment delivery customer should write the number of boxes received on the LR Copy duly signed and stamped by the customer.**
- **\*\*Secondary Carton Shortage (C) – Complaint sufficient. Customer to indicate if the cartons were received in open / damaged condition. It is mandatory to provide the photo of the carton boxes received in open/damaged condition**
- **\*\*Open Box Receipt (D) Customer should write open boxes and number of short boxes on front of the LR Copy. It is mandatory to provide the photo of the carton boxes received in open/damaged condition**
- **\*\*Secondary Carton inner quantity Shortage (E) – It is mandatory to provide the photo of the Primary/Secondary carton boxes received which has short materials**
- Invoice / LR Not received (F) – Complaint Sufficient
- **\*\*\*Wrong Consignment Received (H) – Complaint Required. Customer should compulsorily either refuse accepting the wrongly received consignments at the time of delivery being attempted by the transporter or can notify SFL Claims Desk on Wrong Consignment receipt by providing a photo of the labels pasted on the Master cartons for which SFL will organize pick up of wrongly delivered consignment. In any case customer should not absorb/inward the wrongly delivered consignment and should inform SFL by lodging complaint with SFL Claims Desk**



**R.Vasudevan**

GM – Marketing

**Sundram Fasteners Limited**

CTH Road - Padi,  
Chennai 600 050  
Tamilnadu, India.  
E Mail: vasudevan.r2@sfl.co.in  
Mobile: 98407 06124  
Phone: +91-44-26258460 Extn: 435

**1st April 2026**

Dear Customer,

Our price list number **SF/SOCKET/02/2026** effective **1st April 2026** is given in this booklet.

To ensure correctness price list, we would be pleased if you could communicate your suggestions and improvements of the same.

We are proceeding with limited print hence physical circulation will be restricted with limited copies, while e-price list will be made available.

We welcome your suggestions to upgrade the content of this price list and request you to send in the same to [vasudevan.r2@sfl.co.in](mailto:vasudevan.r2@sfl.co.in)

Finally, we reserve the right to change any part of this price list without prior notice.

Thanking you and assuring you of our best attention always.

Yours truly,

**R.Vasudevan**

General Manager - Marketing



### OUR DISTRIBUTORS AND THEIR BRANCHES

Distributors	Branches at:
<b>India Motor Parts &amp; Accessories, Ltd.</b> SUNDARAM TOWERS' 45 & 46, Whites Road, Chennai - 600 014 Tel: +91-44-28523996/28524097 Fax: +91-44-28523009 Fax: +91-44-28523009	Agra, Agartala, Ahmedabad, Asansol, Aurangabad, Ajmer, Amritsar, A T Road (Guwahati), Bikaner, Bangalore, Baroda, Ballari, Bhubaneswar, Bhilwara, Chandigarh, Chennai, Coimbatore, Cuttack, Dankuni, Deharadun, Dhanbad, Dindigul, Erode, Ernakulam, Gandhidham, Gorakhpur, Guwahati, Hissar, Hosur, Hubli, Hyderabad, Hyderabad-LB Nagar, Indore, Jaipur, Jammu, Jodhpur, Jalandhar, Jabalpur, Jamshehpur, Jeypore, Jalgaon, Kannur, Kanpur, Kolkata, Kozhikode, Kota, Kolhapur, Kottayam, Kadapa, Kalaburagi, Karimnagar, Kumbakonam, Kurnool, Lucknow, Ludhiana, Madurai, Malda, Mangalore, Mettupalayam, Meerut, Morigate (Delhi), Muzaffarpur, Mysuru, Nagpur, Navi Mumbai, Nanded, Patna, Patna Exib Road, Pune, Purnea, Rajkot, Ranchi, Raipur, Rajamahendravaram, Redhills, Sambalpur, Salem, Sasaram, Shimoga, Silchar, Silliguri, Singaperumal Kovil, Srinagar, Surat, Tinsukia, Tirunelveli, Tirupathi, Trichy, Trivandram, Thrissur, Udaipur, Varanasi, Vellore, Vijayapura, Vijayawada, Villupuram, Visakhapatnam
<b>Jullundur Motor Agency (Delhi) Ltd.</b> 458-1/16, Sohna Road, Opp. New Court, Gurgaon - 122 001. Tel: 0124-4233867-68-69-70	Agra, Allahabad, Alwar, Amritsar, Asansol, Alampur, Azamgarh, Baddi, Bareilly, Bangalore, Bathinda, Bhilwara, Bhopal, Bhubaneswar, Bikaner, Chandigarh, Chennai, Cuttack, Coimbatore, Cochin, Dehradun, Ghaziabad, Gorakhpur, Gurgaon, Guwahati, Haldwani, Indore, Jabalpur, Jaipur, Medinipur, Muzaffarpur, Jammu, Jamshehpur, Jodhpur, Jalandhar, Kanpur, Kashmere Gate (Delhi), Kolkata, Kota, Lucknow, Ludhiana, Madurai, Mysore, Mangalore, Namakkal, Nagercoil, Nashik, Ranchi, Patiala, Pathankot, Patna, Purnea, Raipur, Rourkela, Salem, Saharanpur, Silchar, Siliguri, Tinsukia, Udaipur, Varanasi.
<b>JMA Marketing Limited</b> 2749 Mirza Umrao Street, Behind Minerva Cinema Kashmere Gate, Delhi-110 006. Tel: 011-41831717	Ahmedabad, Aurangabad, Baroda, Belgaum, Bellary, Delhi, Dhule, Goa, Hubli, Hyderabad, Kolhapur, Latur Mumbai, Nagpur, Nasik, Nigdi, Pune, Rajkot, Shimoga, Surat, Solapur, Vashi, Vishakhapatnam, Vijaywada, Warangal
<b>Madras Auto Service</b> A Division of T.S.Santhanam & Family Pvt. Ltd Plot No.6. S.P.(Developed Plot) Industrial Estãe, Guindy, Chennai - 600 032 Phone: 91-44-690698515	Agartala, Ahmednagar, Allahabad, Alwar, Amravati, Anantapur, Aurangabad, Balangir, Bangalore, Bangalore II, Bardhaman, Bareily, Belgaum, Bellary, Berhampore, Bhopal, Bhubaneswar, Bijapur, Bikaner, Bilaspur, Calicut, Cannanore, Chandigarh, Chennai, Chennai II, Coimbatore, Cuddalore, Cuddapah, Cuttack, Davanagere, Delhi, Dhule, Dumka, Ernakulam, Erode, Feelkhana, Gaya, Gazhiabad, Goa, Gorakhpur, Gulbarga, Guntur, Guwahati, Guwahati II, Gwalior, Hassan, Hissar, Hosur, Hubli, Hyderabad, Indore, Jabalpur, Jaipur, Jalandhar, Jammu, Jamshehpur, Jodhpur, Jorhat, Kanpur, Karimnagar, Kolhapur, Kolhapur II, Kolkata, Kolkata Central Market, Kottayam, Krpuram, Kukatpally, Kumbakonam, Kurnool, Latur, Lucknow, Ludhiana, Madurai, Malda, Mandi, Mangalore, Miryalaguda, Mumbai, Mumbai II, Muzaffarpur, Mysore, Nagpur, Nagpur II, Namakkal, Nashik, Nellore, Patna, Patna II, Pollachi, Pondicherry, Poonamallee, Pune, Pune II, Purnea, Raipur, Rajamundry, Ranchi, Redhills, Rourkela, Salem, Satna, Shimoga, Sikar, Silchar, Siliguri, Siliguri Town, Solapur, Srinagar, Tambaram, Tirunelveli, Tirupati, Trichur, Trichy, Trivandrum, Tumkur, Udaipur, Uppal, Varanasi, Vellore, Vijayawada, Vijayawada II, Villupuram, Vizag, Warangal, Yeswantpur
<b>Partap Singh &amp; Sons</b> 516/517, Parekh Market, JSS Road Opera House, Mumbai - 400 004. Tel: +91-22-43005002 Fax: +91-22-43005003	Agra, Ahemdagar, Ahmedabad, Amritsar, Aurangabad, Bangaluru, Baroda, Bhatinda, Bhiwandi, Bhopal, Bhubaneswar, Chakan, Chennai, Coimbatore, Dehradun, Delhi, Dhulia, Gandhidham, Gorakhpur, Gurgaon, Guwahati, Gwalior, Hisar, Hyderabad, Jabalpur, Jaipur, Jalandhar, Jalandhar City, Jammu, Jamshehpur, Jodhpur, Kalamboli, Kanpur, Kolhapur City, Kolhapur Shirol, Kolkata, Latur, Ludhiana, Madurai, Manimajra, Nagdevi, Nagpur Wadi, Nanded, Nashik, Nigdi, Opera House, Pathankot, Patna, Prayagraj, Ponda, Pune, Raipur, Rajkot, Saharanpur, Sangli, Satna, Siliguri, Solapur, Surat, Trissur, Udaipur, Ulasnagar, Vapi, Varanasi, Vashi, Vishnupuri
<b>The Associated Auto Parts Pvt. Ltd.</b> 445, Dr.Bhadkamkar Marg, (Lamington Road), Mumbai - 400 004. Tel: +91-22-23822354, 23822355	Ahmedabad, Ahmednagar, Ambikapur, Amaravati, Aurangabad, Bhopal, Chandrapur, Chimbli Phata (Pune), Dhule, Gandhidham, Indore, Jaipur, Jodhpur, Jabalpur, Jalgaon, Kolhapur, Navi Mumbai, Nasik, Nanded, Nagpur, Ponda (Goa), Pune, Rajkot, Raipur, Surat, Vasai, Sangli, Solapur, Vadodara.
<b>TVS Mobility Pvt. Ltd</b> 8th Floor, A8 & A9, Thiru. Vi.Ka Industrial Estate Guindy, Chennai - 600 032 Phone: 91-44-22508676	Bhopal, Calicut, Cochin, Coimbatore, Dharmapuri, Dindigul, Erode, Haldwani, Indore, Jabalpur, Jaipur, Jodhpur, Kannur, Kanpur, Kollam, Kottayam, Lucknow, Madhavaram, Madurai, Malapuram, Mangaluru, Nagercoil, Namakkal, Palakkad, Pollachi, Pondicherry, Poonamalle, Pudukottai, Salem, Tirunelveli, Tirupur, Trichur, Trichy, Trivandrum, Varanasi, Vellore, Vijayawada, Villupuram
<b>Lucas Indian Service Limited</b> 28, Poomagal Main Road, Behind Olympia Park, Ekkattuthangal, Guindy, Chennai - 600 032 Tel. +91-44-22255032 Extn 611	Bhubaneswar, Guwahati, Kolkata, Patna, Ranchi, Siliguri.



## INDEX

Sl.No.	Description	Page No.
1	Socket Product Technical Data Sheet	10
<b>METRIC &amp; INCH SERIES - Socket Head Cap Screws/Bolts</b>		
2	Socket Head Cap Screws/Bolts - (M3-M12) Grade 12.9, 10.9	12
3	Socket Head Cap Screws/Bolts - (M14-M24) Grade 12.9, 10.9	13
4	Socket Head Cap Screw / Bolts (M16-24 Above 200mm length) (M27-M42) Grade 12.9, 10.9	14
5	Socket Head Cap Screws/Bolts - BSW - (3/16" - 7/16")	15
6	Socket Head Cap Screws/Bolts - BSW - (1/2" - 1")	16
7	Socket Head Cap Screws/Bolts - BSF/UNF - (3/16" - 7/16")	17
8	Socket Head Cap Screws/Bolts - BSF/UNF - (1/2" - 1")	18
9	Socket Head Cap Screws/Bolts - UNC - (3/16" - 7/16")	19
10	Socket Head Cap Screws/Bolts - UNC - (1/2" - 1")	20
<b>METRIC &amp; INCH SERIES - Socket CSK, Set Screws, Button Head &amp; Lower Head Cap Screws</b>		
11	Socket Countersunk Head Cap Screw - (M3-M20) Grade 12.9, 10.9	21
12	Socket Countersunk Head Cap Screw - BSW - (1/4" - 5/8")	22
13	Socket Countersunk Head Cap Screw - UNC - (1/4" - 5/8")	23
14	Socket Countersunk Head Cap Screw - BSF/UNF	24
15	Socket Set Screws - Knurled Cup Point (M3-M12) Grade 12.9, 10.9	25
16	Socket Set Screws - Flat, Cone, Dog, Plain Cup Point (M4-M12) Grade 12.9, 10.9	26
17	Socket Set Screws - Knurled Cup Point - BSW/BSF	27
18	Socket Button Head Cap Screw - (M3-M12) Grade 12.9, 10.9	28
19	Low Head Socket Head Cap Screw - (M4-M16) Grade 12.9, 10.9	29
<b>SHB / SHS - Grade 8.8</b>		
20	Socket Head Cap Screws/Bolts - (M3-M12)	30
21	Socket Head Cap Screws/Bolts - (M14-M24)	31
22	Socket Head Cap Screw / Bolts (M16-24 Above 200mm length) (M27-M36)	32
23	Socket Countersunk Head Cap Screw - (M3-M20)	33
24	Socket Button Head Cap Screw - (M3-M10)	34
25	Low Head Socket Head Cap Screw - (M4-M16)	35
<b>SOCKET KEYS</b>		
26	Socket Keys - Metric Series	36
27	Socket Keys T Handle Hex (long)	37
28	Socket Keys - Inch Series	38
29	Socket Keys - T Handle Hex Inch Series	39



# Socket Products

## Technical Data Sheet

### Socket Countersunk Head Screws BS Inch Series

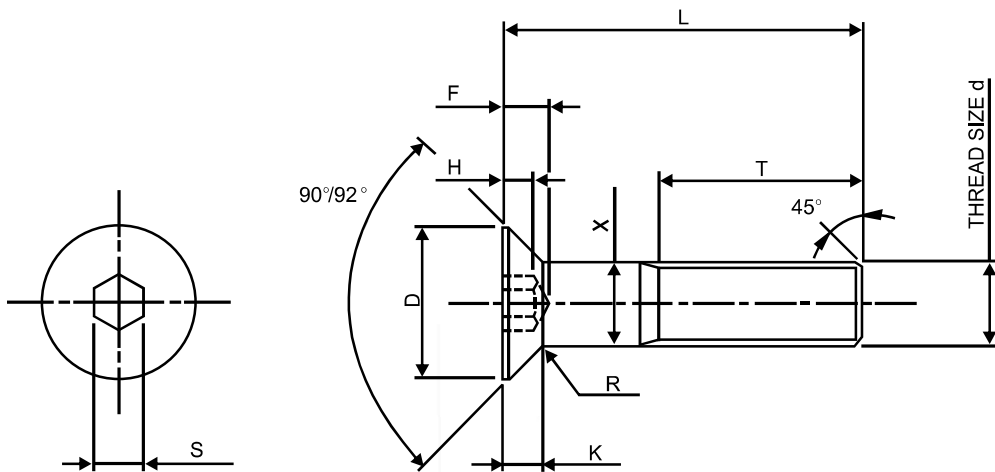

**D-MAX THEORETICAL SHARP CORNERS**

### D-MAX THEORETICAL SHARP CORNERS

THREAD SIZE $\emptyset$	D	X	F	K	H	R	T	S
	Max	Max	Max	Ref	Min	Ref	Min	Nom
3/16	0.356	0.187	0.097	0.085	0.065	0.025	1.000	3/32
1/4	0.475	0.250	0.132	0.113	0.085	0.025	1.000	5/32
5/16	0.596	0.312	0.159	0.142	0.105	0.025	1.125	3/16
3/8	0.712	0.375	0.187	0.169	0.125	0.025	1.250	7/32
7/16	0.833	0.437	0.211	0.198	0.142	0.025	1.375	1/4
1/2	0.951	0.500	0.248	0.226	0.165	0.025	1.500	5/16
5/8	1.190	0.625	0.318	0.283	0.220	0.025	1.750	3/8

(All dimensions in inches)

1. Material : Special grade alloy steel
2. Hardness : 36 to 45 HRc
3. Thread fit : Medium Class as per BS:84



# Suggested Hexagon Keys

## METRIC SERIES(In mm)

Sl.No	Diameter	SHCS	SHCB	CSK	BUTTON	SSS	LHCS
1	M3	2.5	2.5	2	2	1.5	
2	M4	3	3	2.5	2.5	2	2.5
3	M5	4	4	3	3	2.5	3
4	M6	5	5	4	4	3	4
5	M8	6	6	5	5	4	5
6	M10	8	8	6	6	5	7
7	M12	10	10	8	8	6	8
8	M14	12	12				10
9	M16	14	14	10	10		12
10	(M18)	14	14				12
11	M20	17	17	12			14
12	(M22)	17	17				
13	M24	19	19				
14	M27	19	19				
15	M30	22	22				
16	M33	24	24				
17	M36	27	27				
18	M42	32	32				

## INCH SERIES (In inch)

Sl.No	Diameter	SHCS	SHCB	CSK	SSS	
					BSF/BSW	UNF/UNC
1	3/16	5/32	5/32		3/32	
2	1/4	3/16	3/16	5/32	1/8	1/8
3	5/16	7/32	7/32	3/16	5/32	5/32
4	3/8	5/16	5/16	7/32	3/16	3/16
5	7/16	5/16	5/16			
6	1/2	3/8	3/8	5/16	1/4	1/4
7	5/8	1/2	1/2	5/16		
8	3/4	9/16	9/16			
9	7/8	9/16	9/16			
10	1	5/8	5/8			



# Socket Head Cap Screws/Bolts

## Metric Series M3 - M12

Recommended Retail Prices in Rupees Per 100 Pieces

Effective 1st April 2026



Diameter	M3	M4	M5	M6	M8	M10	M12
Length	Key						
(mm)	2.5	3	4	5	6	8	10
5	1580	1385					
6	1360	1385	1610	1805			
8	1010	1045	1115	1250	1515		
10	845	825	635	725	1385	1575	
12	845	755	640	835	1060	1575	
(14)	885	790	725	800	930	1460	
15			725	800	930	1460	
16	885	640	725	800	930	1460	4275
(18)	885	840	785	835	975	1335	3815
20	885	680	670	835	975	1335	3815
(22)	915	875	820	930	1090	1465	3320
25	915	705	820	930	1090	1465	3320
30	1075	1020	950	1050	1175	1615	3320
35		1125	1045	1145	1285	1730	3405
40		1235	1125	*1240	1385	1845	3420
45		1405	1220	*1335	*1485	1995	3485
50		1740	1315	*1430	*1540	*2120	3560
55		2770	2230	*1540	*1690	*2295	*3760
60			2865	2840	*1820	*2470	*3975
65			5680	2935	1940	2665	*4180
70			6795	3045	2080	2865	*4400
75				3400	2190	3040	*4605
80				3860	3295	4690	*5510
85				3920	3800	5340	*6225
90				3920	3800	5340	*6225
95				4430	4515	6275	*7195
100				4430	4515	6275	*7195
105				5290	5620	7400	*8635
110				5290	5620	7400	8635
115				6940	6565	7490	9935
120				6940	6565	7490	9935
125				8380	8060	10300	12070
130				8380	8060	10300	12070
135				9020	8660	11520	13440
140				9020	8660	11520	13440
145					9355	12795	14830
150					9355	12795	14830
155							24430
160							24430
165							26865
170							26865
175							26865
180							26865
185							29075
190							29075
195							29075
200						25680	29075

1. Specification : Generally conforming to IS:2269, DIN 912, ISO:4762
2. Threads : 12.9 Grade 5.96g as per ISO 261, ISO 965-2; ISO 965-3
3. Material : Special grade alloy steel  
8.8 & 10.9 Low Carbon boron steel, Medium carbon boron steel, Special alloy steel
4. Mechanical Properties : 8.8, 10.9, 12.9 As per ISO 898-1
5. Note : Sizes in brackets are non-preferred standards. Shaded sizes are fully threaded.
6. Finish : Zinc Phosphate (Grey/Black) SST Life of 72 Hours for Red Rust



# Socket Head Cap Screws/Bolts

## Metric Series M14 - M24

Recommended Retail Prices in Rupees Per 100 Pieces

Effective 1st April 2026



1. Specification : Generally conforming to IS:2269, DIN 912, ISO:4762
2. Threads : 12.9 Grade 5g6g as per ISO 261, ISO 965-2; ISO 965-3
3. Material : Special grade alloy steel  
8.8 & 10.9 Low Carbon boron steel, Medium carbon steel, Medium carbon boron steel, Special alloy steel
4. Mechanical Properties : 8.8, 10.9, 12.9 As per ISO 898-1
5. Note : Sizes in brackets are non-preferred standards. Shaded sizes are fully threaded.
6. Finish : Zinc Phosphate (Grey/Black) SST Life of 72 Hours for Red Rust

Diameter	M14	M16	M18	M20	M22	M24
Length	Key					
(mm)	12	14	14	17	17	19
5						
6						
8						
10						
12						
(14)						
16		10825				
(18)						
20	9545	8390				
(22)	8610	8390				
25	8610	8390		20465		
30	8610	8390	22515	20465		
35	7245	7055	22800	20730		
40	7415	7230	19955	18155		21885
45	7540	7350	20100	18280	25995	22445
50	7720	7510	20270	18425	23555	21505
55	7815	7630	20395	18535	26470	24180
60	8290	*8060	20550	18670	27215	24860
65	8400	*8185	20730	18840	30310	27680
70	9065	8830	22140	20120	29410	28195
75	9575	9340	23575	*21435	34410	29870
80	10040	9770	24030	*21855	34410	31405
85	10265	9990	24510	22290	36075	32940
90	10265	9990	24510	22290	36075	32940
95	12715	12400	25705	23375	38050	34740
100	12715	12400	25705	23375	38050	34740
105	13825	13465	28445	25850	41355	37780
110	13825	13465	28445	25850	41355	37780
115	14935	14550	31160	28350	44700	40825
120	14935	14550	31160	28350	44700	40825
125	17295	16845	33895	30820	58775	43880
130	17295	16845	33895	30820	58775	43880
135	18510	18025	36605	33280	68665	46915
140	18510	18025	36605	33280	68665	46915
145	19730	19205	39320	35755	91535	49980
150	19730	19205	39320	35755	91535	49980
155	22165	38220	47995	45820	130910	81120
160	23265	38220	47995	45820	130910	81120
165	26200	42555	54825	52320	140040	86795
170	30655	42555	54825	52320	140040	86795
175		42555	54825	52320	140040	86795
180	31195	42555	54825	52320	140040	86795
185		47025	57155	54560	149915	92910
190		47025	57155	54560	149915	92910
195		47025	57155	54560	149915	92910
200		47025	57155	54560	149915	92910



# Socket Headcap Screws/Bolts

Metric Series M16-M24 (Above 200mm length)

**Metric Series M27-M42 Grade 12.9, 10.9**

Recommended Retail Prices in Rupees Per 100 Pieces

**Effective 1st April 2026**



Diameter	(M16)	(M20)	(M22)	(M24)	(M27)	M30	(M33)	M36	M42
Length	Key								
(mm)	14	17	17	19	19	22	24	27	32
45						58560			
50						58560			
55						58560			
60						51310			
65						51310			
70					53340	51310			
(75)					53340	51310	77105		
80					53340	53340	80285	95930	
90					58560	58560	86945	104610	
100					62595	62595	91010	107520	
110					66380	66380	95930	113600	
120					70430	70430	104610	118235	245220
130					71115	75360	109540	122280	264835
140					78245	78245	116495	135025	264835
150					83180	83180	122280	139965	292430
160					130980	130980	162550	188915	347750
(170)					144880	144880	179935	210355	347750
180					144880	144880	179935	210355	369080
(190)					157630	157630	195580	228030	369080
200					157630	157630	195580	228030	399855
(210)	49190	57920	157330	96165	196455	195580	242505	281910	399855
220	49190	61310	164725	99425	196455	195580	242505	281910	501630
(230)	51370	75400	171270	103380	217590	210355	261335	289725	522875
240	51370	98055	177815	107320	217590	210355	261335	289725	522875
(250)	53530	108345	184345	109605	248670	225130	273215	310300	557710
260	53530	118605	190875	92635	237015	225130	273215	310300	557710
(270)	55695	129555	197405	114430	252925	239900	288280	330860	592565
280	55695	140495	203950	117690	252925	239900	288280	330860	592565
(290)	57880	145515	211230	122090	268860	254670	310870	351425	627425
300	57880	150530	218510	126500	268860	254670	310870	351425	627425
360								431160	
380								432850	
400								434970	
580								659700	

1.	Specification	:	Generally conforming to IS:2269, ISO:4762, DIN 912
2.	Threads	:	ISO Metric, 5g6g for 12.9; 6g 8.8 & 10.9 as per ISO 261, ISO 965-2, ISO 965-3
3.	Material	:	12.9 - Special grade alloy steel
		:	8.8 & 10.9 Low Carbon boron steel, Medium carbon steel, Medium carbon boron steel, Special alloy steel
4.	Mechanical Properties	:	Property class as per ISO 898-1
5.	Note	:	Sizes in brackets are non-preferred standards.
6.	Finish	:	Zinc Phosphate (Grey/Black) SST Life of 72 Hours for Red Rust



## Socket Head Cap Screws/Bolts Inch Series BSW (3/16" - 7/16")

Recommended Retail Prices in Rupees Per 100 Pieces  
Effective 1st April 2026



		Screws		Bolt		
Diameter	3/16"	1/4"	1/4"	5/16"	3/8"	7/16"
Length (Inch)	Key					
	5/32"	3/16"	3/16"	7/32"	5/16"	5/16"
3/8	970	880	935	1185		
1/2	970	880	935	1175	1900	
5/8	910	835	900	1045	1900	
3/4	970	880	935	1085	1545	4575
7/8	1030	930	985	1130	1715	4575
1	1065	980	1045	1210	1715	4005
1-1/4	1175	1105	1170	1315	1885	4005
1-1/2	1345	1220	1295	1460	2095	4080
1-3/4	1615	1495	1585	1740	2495	4365
2		1495	1585	1740	2495	4365
2-1/4		2985	3165	2075	2975	5010
2-1/2		2985	3165	2075	2975	5010
2-3/4		3220	3410	2450	3565	5640
3		3455	3670	2450	3565	5640
3-1/4		4140	4380	4260	5450	7650
3-1/2		4140	4380	4260	5450	7650
4		4550	4830	5040	6410	8860
4-1/2				7870	9405	11110
5				9810	11635	13625
5-1/2				12120	13990	15525
6				12120	14380	15525
6-1/2						
7						
7-1/2						
8						
8-1/2						
9						
10						

- |    |                       |   |  |
|----|-----------------------|---|--|
| 1. | Specification         | : | Generally conforming to BS:2470                                |
| 2. | Threads               | : | BS Fine, Medium fit as per BS:84, UNF ,Class 2A as per BS 1580 |
| 3. | Material              | : | Special grade alloy steel                                      |
| 4. | Mechanical Properties | : | As per BS:2470   |
| 5. | Note                  | : | Shaded sizes are fully threaded.                               |
| 6. | Finish                | : | Zinc Phosphate (Grey/Black) SST Life of 72 Hours for Red Rust  |



## Socket Head Cap Screws/Bolts

### Inch Series BSW (1/2" - 1")

Recommended Retail Prices in Rupees Per 100 Pieces

**Effective 1st April 2026**

Diameter	1 / 2"	5 / 8"	3 / 4"	7 / 8"	1"
Length (Inch)	Key				
	3 / 8"	1 / 2"	9 / 16"	9 / 16"	5 / 8"
3/8					
1/2	4270				
5/8					
3/4	4270	10270			
7/8	4270	8755			
1	3715	8755	22890		
1-1/4	3715	7625	22890		
1-1/2	3800	7885	20150	30295	28915
1-3/4	4040	8395	20635	31435	30005
2	4040	8395	20635	31435	30005
2-1/4	4660	9110	21075	33895	32380
2-1/2	4660	9110	21075	33895	32380
2-3/4	5240	10010	23975	38175	36440
3	5240	10010	23975	38175	36440
3-1/4	7115	10705	24930	42105	40195
3-1/2	7115	10705	24930	42105	40195
4	8230	13850	26135	44410	42380
4-1/2	10330	14695	31705	52180	49815
5	12665	16620	34475	56075	53540
5-1/2	13960	20610	37230	60000	57260
6	14450	21490	39990	63900	60990
6-1/2		45210	52455	107095	102230
7		47595	53660	111305	105885
7-1/2		49530	54905	114910	109690
8		52600	55960	118760	113355
8-1/2			59000		116600
9			63385		123965
10					

1. Specification	:	Generally conforming to BS:2470
2. Threads	:	BS Fine, Medium fit as per BS:84, UNF ,Class 2A as per BS 1580
3. Material	:	Special grade alloy steel
4. Mechanical Properties	:	As per BS:2470
5. Note	:	Shaded sizes are fully threaded.
6. Finish	:	Zinc Phosphate (Grey/Black) SST Life of 72 Hours for Red Rust



## Socket Head Cap Screws/Bolts Inch Series BSF/UNF (3/16" - 7/16")

Recommended Retail Prices in Rupees Per 100 Pieces

**Effective 1st April 2026**



	Screws		Bolts			
Diameter	3/16"	1/4"	1/4"	5/16"	3/8"	7/16"
Length (Inch)	Key					
	5/32"	3/16"	3/16"	7/32"	5/16"	5/16"
3/8	1175	1085	1145	1465		
1/2	1175	1085	1145	1460	2335	
5/8	1100	1025	1100	1280	2335	
3/4	1175	1085	1145	1330	1895	5620
7/8	1275	1130	1200	1370	2115	5620
1	1325	1200	1280	1480	2115	4915
1-1/4	1450	1350	1440	1615	2315	4915
1-1/2	1660	1495	1585	1795	2565	5015
1-5/8					3060	
1-3/4	1975	1855	1970	2115	3060	5350
2		1855	1970	2115	3060	5350
2-1/4		3660	3885	2530	3640	6160
2-1/2		3660	3885	2530	3640	6160
2-3/4		3940	4180	3025	4385	6950
3		4240	4500	3025	4385	6950
3-1/4		5085	5395	5230	6710	9410
3-1/2		5085	5395	5230	6710	9410
4		5585	5925	6190	7865	10875
4-1/2				9685	11570	13650
5				12050	14300	16745
5-1/2				13490	17190	19090
6				14900	17670	19090
6-1/2						
7						
7-1/2						
8						
8-1/2						
9						
10						

- |    |                       |   |  |
|----|-----------------------|---|--|
| 1. | Specification         | : | Generally conforming to BS:2470                                |
| 2. | Threads               | : | BS Fine, Medium fit as per BS:84 UNF, class 2A as per BS: 1580 |
| 3. | Material              | : | Special grade alloy steel                                      |
| 4. | Mechanical Properties | : | As per BS:2470   |
| 5. | Note                  | : | Shaded sizes are fully threaded.                               |
| 6. | Finish                | : | Zinc Phosphate (Grey/Black) SST Life of 72 Hours for Red Rust  |
| 7. | Pitch                 | : | for 3/16 Dia -Only BSW/BSF                                     |



## Socket Head Cap Screws/Bolts Inch Series BSF/UNF (1/2" - 1")

Recommended Retail Prices in Rupees Per 100 Pieces

**Effective 1st April 2026**



Diameter	1 / 2"	5 / 8"	3 / 4"	7 / 8"	1"
Length (Inch)	Key				
	3 / 8"	1 / 2"	9 / 16"	9 / 16"	5 / 8"
3/8					
1/2					
5/8					
3/4	5235				
7/8	5235	10775			
1	4560	10775	26860		
1-1/4	4560	9370	26860		
1-1/2	4665	9700	23660	35565	33960
1-3/4	4995	10325	24220	37005	35240
2	4995	10325	24220	37005	35240
2-1/4	5730	11205	24740	39805	38010
2-1/2	5730	11205	24740	39805	38010
2-3/4	6455	12305	28160	44825	42780
3	6455	12305	28160	44825	42780
3-1/4	8745	13165	29265	49420	47175
3-1/2	8750	13165	29265	49420	47175
3-3/4	10120				
4	10120	17030	30685	52145	49765
4-1/2	12690	18070	37225	61285	58490
5	15595	20465	40480	65845	62860
5-1/2	17165	25350	43710	70440	67250
6	17760	26445	46955	75025	71625
6-1/2		55600	61605	125765	120045
7		56160	63010	130695	124340
7-1/2		58560	64470	134955	128805
8		60910	65705	139465	133115
8-1/2		64700	69280		136930
9			74425		145580
10					

1.	Specification	:	Generally conforming to BS:2470
2.	Threads	:	BS Fine, Medium fit as per BS:84, UNF ,Class 2A as per BS 1580
3.	Material	:	Special grade alloy steel
4.	Mechanical Properties	:	As per BS:2470
5.	Note	:	Shaded sizes are fully threaded.
6.	Finish	:	Zinc Phosphate (Grey/Black) SST Life of 72 Hours for Red Rust



## Socket Head Cap Screws/Bolts Inch Series UNC (3/16" - 7/16")

Recommended Retail Prices in Rupees Per 100 Pieces

**Effective 1st April 2026**



		Screws		Bolts			
Diameter	3/16"	1/4"	1/4"	5/16"	3/8"	7/16"	
Length (Inch)	Key						
	5/32"	3/16"	3/16"	7/32"	5/16"	5/16"	
3/8	1165	1060	1125	1440			
1/2	1165	1060	1125	1430	2285		
5/8	1095	1005	1065	1250	2285		
3/4	1165	1060	1125	1295	1860	5530	
7/8	1235	1120	1185	1355	2085	5530	
1	1290	1170	1250	1460	2085	4830	
1-1/4	1430	1325	1400	1585	2255	4830	
1-1/2	1620	1475	1565	1760	2530	4920	
1-3/4	1935	1820	1930	2085	2985	5250	
2		1820	1930	2085	2985	5250	
2-1/4		3595	3815	2495	3585	6045	
2-1/2		3595	3815	2495	3585	6045	
2-3/4		3885	4120	2950	4310	6810	
3		4160	4400	2950	4310	6810	
3-1/4		4990	5285	5120	6580	9245	
3-1/2		4990	5285	5120	6580	9245	
4		5465	5795	6080	7710	10675	
4-1/4					11355		
4-1/2				9510	11355	13385	
5				11830	14030	16440	
5-1/2					16860	18730	
6					17360	19235	
6-1/2							
7							
7-1/2							
8							
8-1/2							
9							
10							

1.	Specification	:	Generally conforming to BS:2470
2.	Threads	:	UNC 2A as per BS:1580
3.	Material	:	Special grade alloy steel
4.	Mechanical Properties	:	As per BS:2470
5.	Note	:	Shaded sizes are fully threaded.
6.	Finish	:	Zinc Phosphate (Grey/Black) SST Life of 72 Hours for Red Rust



## Socket Head Cap Screws/Bolts Inch Series UNC (1/2" - 1")

Recommended Retail Prices in Rupees Per 100 Pieces

**Effective 1st April 2026**



Diameter	1 / 2"	5 / 8"	3 / 4"	7 / 8"	1"
Length (Inch)	Key				
	3 / 8"	1 / 2"	9 / 16"	9 / 16"	5 / 8"
3/8					
1/2					
5/8					
3/4	5140	12410			
7/8	5140	10575			
1	4485	10575	26365		
1-1/4	4485	9185	26365		
1-1/2	4570	9520	23230	34895	33325
1-3/4	4885	10125	23780	36230	34580
2	4885	10125	23780	36230	34580
2-1/4	5610	11000	24295	39055	37300
2-1/2	5610	11000	24295	39055	37300
2-3/4	6330	12075	27620	43985	41995
3	6330	12075	27620	43985	41995
3-1/4	8580	12925	28725	48495	46310
3-1/2	8580	12925	28725	48495	46310
3-3/4	9935				48850
4	9935	16725	30115	51185	48850
4-1/2	12445	17745	36505	60140	57390
5	15295	20080	39720	64620	61695
5-1/2	16840	24875	42885	69135	65995
6	17415	25935	46090	73620	70270
6-1/2		54560	60450	123405	117805
7		56160	61830	128255	110935
7-1/2		57455	63260	132435	126400
8		59785	64470	136850	130625
8-1/2		63495	67975	136850	134355
9			73045		142855

1. Specification	:	Generally conforming to BS:2470
2. Threads	:	UNC 2A as per BS:1580
3. Material	:	Special grade alloy steel
4. Mechanical Properties	:	As per BS:2470
5. Note	:	Shaded sizes are fully threaded.
6. Finish	:	Zinc Phosphate (Grey/Black) SST Life of 72 Hours for Red Rust



# Socket Countersunk Head Cap Screws

Metric Series M3 - M20

Recommended Retail Prices in Rupees Per 100 Pieces

Effective 1st April 2026

Diameter	M3	M4	M5	M6	M8	M10	M12	M16	M20
Length	Key								
(mm)	2	2.5	3	4	5	6	8	10	12
6	1315								
8	1315	730	1055	1360					
10	1405	730	595	880					
12	1510	615	615	720	1140				
16	1710	820	820	895	1140	1840			
20	1915	885	885	960	1215	1515			
25	2105	1025	1025	1115	1400	1745	3175		
30		1240	1240	1340	1590	2000	3625	6170	
35		2550	1645	1780	1815	2285	4075	6650	
40		2735	2550	1780	2075	2615	4530	7110	7620
45		3090	2900	3140	3140	2955	4970	7590	8925
50		3630	3630	3920	3605	3315	5420	8080	8925
55					4305	3760	5880	8525	8510
60					4825	4160	6330	9010	10240
65							7125	9910	10905
70							7670	10415	11560
75							8250	10925	12875
80							8880	11475	12875
85							9540	13010	14200
90							10280	13010	14200
95							11055	15730	17015
100							11900	15730	18230
110							13795	20900	21870
120							15925	25085	26730
130								27865	29155

- |                          |   |   |
|--------------------------|---|---|
| 1. Specification         | : | Generally conforming to ISO 10642                             |
| 2. Threads               | : | 12.9 Grade 5g6g as per ISO 261, ISO 965-2; ISO 965-3          |
| 3. Material              | : | Special grade alloy steel                                     |
| 4. Mechanical Properties | : | Property class 12.9 as per IS:1367-3, ISO 898-1               |
| 5. Note                  | : | All sizes are fully threaded.                                 |
| 6. Finish                | : | Zinc Phosphate (Grey/Black) SST Life of 72 Hours for Red Rust |



# Socket Countersunk Head Cap Screws

## Inch Series BSW (1/4" - 5/8")

Recommended Retail Prices in Rupees Per 100 Pieces  
Effective 1st April 2026

Diameter	1/4"	5/16"	3/8"	1/2"	5/8"
Length	Key				
(Inch)	5/32"	3/16"	7/32"	5/16"	3/8"
3/8	880				
1/2	880	1275			
5/8	960	1275	1965		
3/4	1025	1215	1780	3910	
7/8	1110	1315	1915	4345	
1	1195	1400	2060	4890	
1 - 1/4	1365	1590	2360	5420	
1 - 1/2	1235	2125	3175	6065	
2			3555	6800	8635
2 1/4					8355
2 1/2				7615	9965
2 3/4					9690
3					11610

- |                          |   |
|--------------------------|---|
| 1. Specification         | : (Please refer to SFL technical data sheet. Page10)            |
| 2. Threads               | : BS Whitworth, Medium Fit as per BS:84                         |
| 3. Material              | : Special grade alloy steel                                     |
| 4. Mechanical Properties | : Hardness 36-44 Hrc  |
| 5. Note                  | : All size are fully threaded                                   |
| 6. Finish                | : Zinc Phosphate (Grey/Black) SST Life of 72 Hours for Red Rust |
- These are not popular items. We will take up forging. after we get sufficient orders to meet out Economic batch run quantity.



# Socket Countersunk Head Cap Screws

## Inch Series UNC (1/4" - 5/8")

Recommended Retail Prices in Rupees Per 100 Pieces  
Effective 1st April 2026

Diameter	1/4"	5/16"	3/8"	1/2"	5/8"
Length	Key				
(Inch)	5/32"	3/16"	7/32"	5/16"	3/8"
3/8	1450				
1/2	1450	1875			
5/8	1580	1875	2475		
3/4	1700	2015	2680	4770	
7/8	1820	2160	2850	5480	
1	1945	2225	3280	5960	
1 1/4	2230	2615	3430	6675	
1 1/2		2870	3935	7380	
2			4800	8115	8635
2 1/4				8400	8770
2 1/2				8935	9965
2 3/4				9355	10180
3				9820	11610

- |  |   |   |
|--|---|---|
| 1. Specification   | : | Generally conforming to BS:2470                               |
| 2. Threads   | : | UNC 2A as per BS: 1580  |
| 3. Material  | : | Special grade alloy steel                                     |
| 4. Mechanical Properties   | : | Hardnesss 36 HRc Min  |
| 5. Note  | : | All sizes are fully threaded.                                 |
| 6. Finish  | : | Zinc Phosphate (Grey/Black) SST Life of 72 Hours for Red Rust |
| These are not popular items. We will take up forging after we get sufficient orders to meet our Economic batch run quantity. |   |   |



# Socket Countersunk Head Cap Screws Inch Series BSF/UNF

Recommended Retail Prices in Rupees Per 100 Pieces

Effective 1st April 2026

Diameter	1/4"	5/16"	3/8"	1/2"
Length	Key			
(Inch)	5/32"	3/16"	7/32"	5/16"
3/8	1475			
1/2	1475	1915		
5/8	1620	1915	2530	
3/4	1735	2060	2735	4865
7/8	1855	2205	2885	5590
1	1985	2265	3340	6070
1 - 1/4	2275	2655	3495	6805
1 - 1/2		3155	4015	7530
2			4800	8275
2 - 1/2				9105
3				10010

- |                          |   |  |
|--------------------------|---|--|
| 1. Specification         | : | BSF/UNF: Generally conforming to BS: 2470                      |
| 2. Threads               | : | BS Fine, Medium fit as per BS:84 UNF, class 2A as per BS: 1580 |
| 3. Material              | : | Special grade alloy steel                                      |
| 4. Mechanical Properties | : | Hardness 36 HRc Min  |
| 5. Note                  | : | All sizes are fully threaded.                                  |
| 6. Finish                | : | Zinc Phosphate (Grey/Black) SST Life of 72 Hours for Red Rust  |
- These are not popular items. We will take up forging after we get sufficient orders to meet our Economic batch run quantity.



**Socket Set Screws**  
**Metric Series M3 - M12**  
**Knurled Cup Point**  
 Recommended Retail Prices in Rupees Per 100 Pieces  
 Effective 1st April 2026

Diameter	M3	M4	M5	M6	M8	M10	M12
<b>Length</b>	<b>Key</b>						
<b>(mm)</b>	<b>1.5</b>	<b>2</b>	<b>2.5</b>	<b>3</b>	<b>4</b>	<b>5</b>	<b>6</b>
<b>3</b>	<b>455</b>						
<b>4</b>	<b>430</b>	<b>430</b>					
<b>5</b>	<b>435</b>	<b>435</b>	<b>305</b>	<b>550</b>			
<b>6</b>	<b>440</b>	<b>440</b>	<b>305</b>	<b>330</b>	<b>370</b>		
<b>8</b>	<b>445</b>	<b>445</b>	<b>305</b>	<b>370</b>	<b>370</b>	<b>420</b>	
<b>10</b>	<b>465</b>	<b>390</b>	<b>335</b>	<b>300</b>	<b>375</b>	<b>420</b>	<b>1095</b>
<b>12</b>	<b>500</b>	<b>500</b>	<b>350</b>	<b>390</b>	<b>390</b>	<b>460</b>	<b>790</b>
<b>15</b>				<b>420</b>			
<b>16</b>	<b>515</b>	<b>515</b>	<b>355</b>	<b>420</b>	<b>435</b>	<b>515</b>	<b>855</b>
<b>19</b>						<b>565</b>	
<b>20</b>				<b>440</b>	<b>460</b>	<b>565</b>	<b>900</b>
<b>22</b>					<b>745</b>		
<b>25</b>				<b>530</b>	<b>530</b>	<b>665</b>	<b>1015</b>
<b>30</b>				<b>725</b>	<b>750</b>	<b>960</b>	<b>1175</b>
<b>35</b>					<b>875</b>	<b>1105</b>	<b>1340</b>
<b>40</b>							
<b>45</b>							
<b>50</b>							
<b>55</b>							
<b>60</b>							
<b>65</b>							
<b>70</b>							

- |                          |   |
|--------------------------|---|
| 1. Specification         | : Generally conforming to ISO 4029 (Without Knurling details)   |
| 2. Threads               | : 12.9 Grade 5g6g as per ISO 261, ISO 965-2; ISO 965-3          |
| 3. Material              | : Special grade alloy steel                                     |
| 4. Mechanical Properties | : Property class 45H as per ISO 898-5                           |
| 5. Finish                | : Zinc Phosphate (Grey/Black) SST Life of 72 Hours for Red Rust |



# Socket Set Screws

## Metric Series M4 - M12

Flat Point, Cone Point, Dog Point, Plain Cup Point

Recommended Retail Prices in Rupees Per 100 Pieces

**Effective 1st April 2026**

Diameter	M4	M5	M6	M8	M10	M12
<b>Length</b>	<b>Key</b>					
<b>(mm)</b>	<b>2</b>	<b>2.5</b>	<b>3</b>	<b>4</b>	<b>5</b>	<b>6</b>
<b>4</b>		<b>435</b>				
<b>5</b>		<b>435</b>				
<b>6</b>	<b>620</b>	<b>435</b>	<b>480</b>			
<b>8</b>	<b>635</b>	<b>440</b>	<b>505</b>	<b>505</b>	<b>585</b>	
<b>10</b>	<b>670</b>	<b>465</b>	<b>530</b>	<b>530</b>	<b>585</b>	<b>1115</b>
<b>12</b>	<b>705</b>	<b>495</b>	<b>550</b>	<b>555</b>	<b>645</b>	<b>1115</b>
<b>16</b>	<b>740</b>	<b>505</b>	<b>590</b>	<b>605</b>	<b>740</b>	<b>1210</b>
<b>20</b>			<b>625</b>	<b>655</b>	<b>795</b>	<b>1275</b>
<b>25</b>			<b>750</b>	<b>750</b>	<b>955</b>	<b>1460</b>
<b>30</b>			<b>1005</b>	<b>1065</b>	<b>1365</b>	<b>1665</b>
<b>35</b>				<b>1240</b>	<b>1575</b>	<b>1920</b>

1. Specification : Generally conforming to IS:6094, ISO:4026, ISO 4027, ISO 4028, ISO 4029

2. Threads : 5g6g as per ISO 261, ISO 965-2, ISO 965-3

3. Material : Special grade alloy steel

4. Mechanical Properties : Property class 45H; as per ISO 898-5



FLAT  
6094  
913



CONE  
6094  
914



DOG  
6094  
915



PLAIN CUP  
6094  
916

5. Finish : Zinc Phosphate (Grey/Black) SST Life of 72 Hours for Red Rust



# Socket Set Screws

## Inch Series BSW/BSF

### Knurled Cup Point

Recommended Retail Prices in Rupees Per 100 Pieces  
Effective 1st April 2026

Diameter	3/16"	1/4"	5/16"	3/8"	1/2"
Length	Key				
(Inch)	3/32"	1/8"	5/32"	5/16"	1/4"
3/16	330				
1/4	330	330			
5/16	330	370	370		
3/8	370	375	375	420	
1/2	380	390	390	460	790
5/8	390	420	435	515	855
3/4		440	460	565	900
1		530	565	665	1015
1 1/4		725	750	960	1305
1 1/2					
1 3/4					
2					
2 1/2					
3					

- |    |                       |  |
|----|-----------------------|--|
| 1. | Specification         | : Generally conforming to BS:2470                                |
| 2. | Threads               | : BS Fine, Medium fit as per BS:84, UNF ,Class 2A as per BS 1580 |
| 3. | Material              | : Special grade alloy steel                                      |
| 4. | Mechanical Properties | : As per BS:2470   |
| 5. | Finish                | : Zinc Phosphate (Grey/Black) SST Life of 72 Hours for Red Rust  |
| 6. | Note                  | : All sizes are fully threaded                                   |
| 7. | Finish                | : BSW/BSF/UNC/UNF on Enquiry                                     |



# Socket Button Head Cap Screws

Metric Series M3 - M12

Recommended Retail Prices in Rupees Per 100 Pieces

Effective 1st April 2026



Diameter	M3	M4	M5	M6	M8	M10	M12
Length	Key						
(mm)	2	2.5	3	4	5	6	8
6	1165	755	1215				
8	1380	755	1160	1410			
10	1485	755	805	975	1555		
12	1590	805	835	785	1260		
16	1800	870	910	1045	1065	2020	
20	1990	925	965	1125	1340	1660	
25	2185	1085	1125	1310	1535	1920	5060
30		1300	1355	1500	1760	2190	
35			1545	1705	1985	2505	6325
40			1730	1955	2255	2875	6325
45				2375	2605	3340	
50					2870	3690	
60					4085		

1.	Specification	:	Generally conforming to ISO :7380-1
2.	Threads	:	5g6g as per ISO 261; ISO 965-2;ISO 965-3
3.	Material	:	Special grade alloy steel
4.	Mechanical Properties	:	Property class 12.9 as per ISO 898-1
5.	Note	:	All sizes are fully threaded.
6.	Finish	:	Zinc Phosphate (Grey/Black) SST Life of 72 Hours for Red Rust



# Lowhead Socket Headcap Screws

## Metric Series M4 - M16

Recommended Retail Prices in Rupees Per 100 Pieces

Effective 1st April 2026

Diameter	M4	M5	M6	M8	M10	M12	(M14)	(M16)
Length (mm)	Key							
	2.5	3	4	5	7	8	10	12
5								
6	1660							
8	1260	1285	1390					
10	995	895	940	1555				
12	905	905	940	1185				
(14)	950	825	895	1045				
16	950	825	895	1045	1635			
(18)	1005	895	940	1085	1490			
20	1005	895	940	1085	1490	3995		
(22)	1045	955	1045	1200	1640	3480		
25	1045	955	1045	1200	1640	3480	9035	
30		1100	1170	1325	1800	3480	9035	6950
35			1280	1440	1945	3555	7595	7395
40				1555	2080	3585	7770	7395
45						3650	7915	7475
50						3725	8090	7855

1. Specification : Generally conforming to DIN 7984
2. Material : 8.8 & 10.9 Grade Low Carbon boron Steel, Medium Carbon Steel.  
Medium carbon Boron Steel, Special grade alloy steel
3. Mechanical Properties : Property class 12.9 as per ISO 898-1
4. Tensile Load requirement : 80% of the values specified in DIN EN ISO 898-1
5. Note : Sizes in brackets are non-preferred standards.
6. Plating Finish : Zinc Phosphate (Grey/Black) SST Life of 72 Hours for Red Rust
7. Thread Fit : 6g for 8.8 as per ISO 261 ; ISO 965-2
8. Supply and Forging based on mutual discussion only.



# Socket Head Cap Screws/Bolts

Grade 8.8

Metric Series M3 - M12

Recommended Retail Prices in Rupees Per 100 Pieces

Effective 1st April 2026



Diameter	M3	M4	M5	M6	M8	M10	M12
Length	Key						
(mm)	2.5	3	4	5	6	8	10
5	1670	1470					
6	1445	1470	1700	1900			
8	1075	1105	1185	1310	1595		
10	900	880	670	755	1465		
12	900	800	675	885	1125	1665	
(14)	935	825	775	855	985	1535	
16	935	675	775	855	985	1535	4520
(18)	935	895	820	885	1020	1410	4025
20	935	720	705	885	1020	1410	4025
(22)	970	920	865	985	1145	1540	3515
25	970	750	865	985	1145	1540	3515
30	1140	1090	1000	1110	1250	1690	3515
35		1185	1095	1200	1355	1830	3605
40		1300	1190	*1305	1465	1955	3625
45		1485	1290	*1410	*1565	2105	3685
50		1840	1395	*1510	*1640	*2245	3770
55		2930	2365	*1640	*1800	*2420	*3980
60			3030	2990	*1930	*2610	*4200
65			5990	3110	2040	2825	*4420
70			7185	3225	2190	3030	*4660
75				3590	2320	3220	*4860
80				3860	3485	4960	*5820
85				4155	4020	5645	*6585
90				4155	4020	5645	*6585
95				4680	4765	6630	*7625
100				4680	4765	6630	*7625
105				5600	5950	7835	*9135
110				5600	5950	7835	9135
115				7340	6940	7925	10520
120				6940	6940	7925	10520
125				8865	8530	10900	12775
130				8865	8530	10900	12775
135				10015	9155	12180	14215
140				10015	9155	12180	14215
145					9890	13530	15690
150					9890	13530	15690
155							25835
160							25835
165							28420
170							28420
175							28420
180							28420
185							30740
190							30740
195							30740
200							30740

1. Specification : Generally conforming to IS:2269, DIN 912, ISO 4762  
 2. Threads : 8.8 Grade 6g as per ISO 261, ISO 965-2; ISO 965-3  
 3. Material : Low & Medium Carbon Boron Steel  
 4. Mechanical Properties : 8.8 As per ISO 898-1  
 5. Note : Sizes in brackets are non-preferred standards. Shaded sizes are fully threaded.  
 6. Finish : Zinc Phosphate (Grey/Black) SST Life of 72 Hours for Red Rust



# Socket Head Cap Screws/Bolts

Grade 8.8

Metric Series M14 - M24

Recommended Retail Prices in Rupees Per 100 Pieces

Effective 1st April 2026



Diameter	M14	M16	M18	M20	M22	M24
Length (mm)	Key					
	12	14	14	17	17	19
5						
6						
8						
10						
12						
(14)						
16						
(18)						
20	10100	8870				
(22)	9110	8870				
25	9110	8870		21640		
30	9110	8870	23805	21640		
35	7660	7465	24115	21915		
40	7850	7645	21110	19195		23145
45	7990	7775	21255	19340		23740
50	8170	7940	21435	19485	24900	22740
55	8265	8050	21565	19610	27995	25565
60	8765	*8530	21725	19735	28785	26295
65	8880	*8655	21915	19930	32055	29270
70	9590	9335	23415	21285	31100	29815
75	10125	9875	24925	*22670	36390	31580
80	10610	10335	25415	*23115	36390	33220
85	10850	10555	25930	23575	38155	34840
90	10850	10555	25930	23575	38155	34840
95	13460	13105	27195	24715	40250	36735
100	13460	13105	27195	24715	40250	36735
105	14620	14235	30090	27350	43745	39955
110	14620	14235	30090	27350	43745	39955
115	15790	15380	32950	29970	47280	43185
120	15790	15380	32950	29970	47280	43185
125	18290	17815	35850	32595	62160	46410
130	18290	17815	35850	32595	62160	46410
135	19570	19070	38715	35205	72625	49620
140	19570	19070	38715	35205	72625	49620
145	20875	20320	41590	37810	96815	52855
150	20875	20320	41590	37810	96815	52855
155	23445	40420	50760	48470	138450	85800
160	24600	40420	50760	48470	138450	85800
165		45010	57980	55335	148125	91805
170		45010	57980	55335	148125	91805
175		45010	57980	55335	148125	91805
180		45010	57980	55335	148125	91805
185		49740	60460	57700	158560	98265
190		49740	60460	57700	158560	98265
195		49740	60460	57700	158560	98265
200		49740	60460	57700	158560	98265

1. Specification : Generally conforming to IS:2269, DIN 912, ISO:4762
2. Threads : 8.8 Grade 6g as per ISO 261, ISO 965-2; ISO 965-3
3. Material : Low & Medium Carbon Boron Steel
4. Mechanical Properties : 8.8 As per ISO 898-1
5. Note : Sizes in brackets are non-preferred standards. Shaded sizes are fully threaded.
6. Finish : Zinc Phosphate (Grey/Black) SST Life of 72 Hours for Red Rust



## Socket Headcap Screws/Bolts

Metric Series M16-M24 (Above 200mm length)

Metric Series M27-M36

Grade 8.8

Recommended Retail Prices in Rupees Per 100 Pieces

Effective 1st April 2026



Diameter	(M16)	(M20)	(M22)	(M24)	(M27)	M30	(M33)	M36
Length	Key							
(mm)	14	17	17	19	19	22	24	27
45						61930		
50						61930		
55						61930		
60						54275		
65						54275		
70					56420	54275		95955
(75)					56420	54275	81550	
80					56420	56420	84910	101455
90					61930	61930	91965	110645
100					66220	66220	96255	113720
110					70210	70210	101455	120140
120					74490	74490	110645	125060
130					75210	79700	115865	129340
140					82775	82775	123210	142810
150					87975	87975	129340	148045
160					138535	138535	171925	199815
(170)					153240	153240	190315	222495
180					153240	153240	190315	222495
(190)					166715	166715	206865	241185
200					166715	166715	206865	241185
(210)	52035	61260	166400	101720	207785	206865	256495	298170
220	52035	64830	174235	105160	207785	206865	256495	298170
(230)	54325	79735	181150	109340	230140	222495	276420	306440
240	54325	103710	188065	113505	230140	222495	276420	306440
(250)	56615	114580	194970	115925	263020	238120	288975	328205
260	56615	125445	201895	97975	250685	238120	288975	328205
(270)	58925	137035	208795	121035	267535	253750	304910	349955
280	58925	148600	215710	124480	267535	253750	304910	349955
(290)	61215	153915	223415	129125	284380	269365	328810	371705
300	61215	159220	231125	133795	284380	269365	328810	371705

1. Specification	:	Generally conforming to IS:2269, ISO:4762, DIN 912
2. Threads	:	ISO Metric, 5g6g for 12.9; 6g 8.8 & 10.9 as per ISO 261, ISO 965-2, ISO 965-3
3. Material	:	Low & Medium Carbon Boron Steel
4. Mechanical Properties	:	Property class as per ISO 898-1
5. Note	:	Sizes in brackets are non-preferred standards.
6. Finish	:	Zinc Phosphate (Grey/Black) SST Life of 72 Hours for Red Rust
	:	Zinc Phosphate & oil/ Zinc White Trivalent / Zinc Iridescent
	:	Trivalent Passivation prices will be enquiry



# Socket Countersunk Head Cap Screws

Metric Series M3 - M20

Grade 8.8

Recommended Retail Prices in Rupees Per 100 Pieces

Effective 1st April 2026



Diameter	M3	M4	M5	M6	M8	M10	M12	M16	M20
Length	Key								
(mm)	2	2.5	3	4	5	6	8	10	17
6	1390								
8	1390	770	1115	1445					
10	1485	770	630	930					
12	1595	730	645	750	1200				
16	1810	875	875	940	1200	1945			
20	2015	935	935	1005	1285	1595			
25	2225	1095	1095	1175	1480	1850	3360		
30		1305	1305	1405	1685	2110	3830	6530	
35		2695	1740	1865	1920	2420	4310	7030	
40		2890	2695	1875	2180	2770	4775	7520	8000
45		3270	3070	3320	2450	3130	5265	8025	9370
50		3835	3835	4150	3815	3510	5735	8530	9370
55					4550	3980	6220	9020	8940
60						4395	6695	9530	10755
65							7545	10495	11455
70							8110	11025	12130
75							8730	11565	13530
80							9395	12140	13530
85							10095	13760	14915
90							10875	13760	14915
95							11695	16640	17870
100							12590	16640	19140
110								20900	22960
120									28065
130									30620

- |                          |   |
|--------------------------|---|
| 1. Specification         | : Generally conforming to ISO:2269, DIN 912, ISO:4762           |
| 2. Threads               | : ISO Metric , 6G as per IS: 4218                               |
| 3. Material              | : Low & Medium Carbon boran Steel                               |
| 4. Mechanical Properties | : Property class 8.8 as per IS:1367                             |
| 5. Note                  | : Sizes in Brackets are non-preferred standards                 |
| 6. Finish                | : Zinc Phosphate (Grey/Black) SST Life of 72 Hours for Red Rust |



# Socket Button Head Cap Screws

Grade 8.8

**Metric Series M3 - M10**

Recommended Retail Prices in Rupees Per 100 Pieces

**Effective 1st April 2026**



Diameter	M3	M4	M5	M6	M8	M10
Length	Key					
(mm)	2	2.5	3	4	5	6
6	1235	800	1285			
8	1465	800	1220	1495		
10	1570	800	845	1020	1650	
12	1680	845	885	830	1325	
16	1895	915	955	1105	1130	2125
20	2105	980	1015	1180	1425	1760
25	2310	1145	1190	1385	1630	2025
30		1370	1435	1580	1850	2320
35			1640	1810	2100	2650
40			1830	2050	2390	3040
45				2510	2760	3530
50					3035	3905

1.	Specification	:	Generally conforming to ISO :7380-1
2.	Threads	:	5g6g as per ISO 261; ISO 965-2;ISO 965-3
3.	Material	:	Low & Medium Carbon Boron Steel
4.	Mechanical Properties	:	Property class 8.8 as per ISO 898-1
5.	Tensile Load Requirement	:	80% of the values specified in ISO 898-1
6.	Note	:	All sizes are fully threaded.
7.	Finish	:	Zinc Phosphate (Grey/Black) SST Life of 72 Hours for Red Rust



# Low Head Socket Head Cap Screws

Metric Series M4 - M16

Grade 8.8

Recommended Retail Prices in Rupees Per 100 Pieces

Effective 1st April 2026

Diameter	M4	M5	M6	M8	M10	M12	M14	M16
Length	Key							
(mm)	2.5	3	4	5	7	8	10	12
5								
6	1745							
8	1325	1350	1465					
10	1050	935	985	1635				
12	950	950	985	1255				
(14)	995	875	940	1100				
16	995	875	940	1100	1715			
(18)	1060	935	985	1130	1570			
20	1060	935	985	1130	1570	4195		
(22)	1100	1000	1100	1270	1725	3650		
25	1100	1000	1100	1270	1725	3650	9490	
30		1155	1235	1390	1885	3650	9490	7295
35			1345	1510	2040	3740	7990	7765
40				1635	2180	3765	8160	7765
45						3835	8310	7850
50						3915	8490	8250

1.	Specification	:	Generally conforming to IS:2269, DIN 912, ISO:4762
2.	Threads	:	ISO Metric, 6g as per IS:4218
3.	Material	:	Low & Medium Carbon Boron steel
4.	Mechanical Properties	:	Property class 8.8 as per IS:1367
5.	Note	:	Sizes in brackets are non-preferred standards.
6.	Finish	:	Zinc Phosphate (Grey/Black) SST Life of 72 Hours for Red Rust



# SOCKET KEYS - Metric Series

Recommended Retail Prices in Rupees Per 100 Pieces

Effective 1st April 2026



Sl.No.	Part No.	Size	Description	Qty. per box	Piece per 100 nos. Rs. P.
1	070000150-0200	1.5 mm	Hex Socket Key	100	1515
2	070000200-0200	2.0 mm	Hex Socket Key	100	1515
3	070000250-0200	2.5 mm	Hex Socket Key	100	1210
4	070000300-0200	3.0 mm	Hex Socket Key	100	1210
5	070000400-0200	4.0 mm	Hex Socket Key	100	2385
6	070000500-0200	5.0 mm	Hex Socket Key	100	3080
7	070000600-0200	6.0 mm	Hex Socket Key	50	4090
8	070000700-0200	7.0 mm	Hex Socket Key	50	12235
9	070000800-0200	8.0 mm	Hex Socket Key	25	7485
10	070000900-0200	9.0 mm	Hex Socket Key	25	19115
11	070001000-0200	10.0 mm	Hex Socket Key	25	12235
12	070001200-0200	12.0 mm	Hex Socket Key	10	19115
13	070001400-0200	14.0 mm	Hex Socket Key	10	27245
14	070001700-0200	17.0 mm	Hex Socket Key	10	46365
15	070001900-0200	19.0 mm	Hex Socket Key	10	63970
16	070002200-0200	22.0 mm	Hex Socket Key	5	111805
17	070002400-0200	24.0 mm	Hex Socket Key	5	144505
18	070002700-0200	27.0 mm	Hex Socket Key	5	252745
19	070003200-0200	32.0 mm	Hex Socket Key	4	444475
20	070003600-0200	36.0 mm	Hex Socket Key	4	675540
21	071000150-0200	1.5 mm	Hex Socket Key (Long)	25	2570
22	071000200-0200	2.0 mm	Hex Socket Key (Long)	25	2895
23	071000250-0200	2.5 mm	Hex Socket Key (Long)	25	2895
24	071000300-0200	3.0 mm	Hex Socket Key (Long)	25	2895
25	071000400-0200	4.0 mm	Hex Socket Key (Long)	10	4485
26	071000500-0200	5.0 mm	Hex Socket Key (Long)	10	5560
27	071000600-0200	6.0 mm	Hex Socket Key (Long)	5	6970
28	071000800-0200	8.0 mm	Hex Socket Key (Long)	5	9655
29	071001000-0200	10.0 mm	Hex Socket Key (Long)	5	18380
30	078000000-0200		Hex Socket Key (Metric - Norm) Set	10	38180



# SOCKET KEYS - T Handle Hex Metric Series

Recommended Retail Prices in Rupees Per 100 Pieces

Effective 1st April 2026



Sl.No.	Part No.	Size	Description	Qty. per box	Piece per 100 nos. Rs. P.
1	072000150-0200	1.5 mm	T Handle Hex Socket Key (Long)	25	5120
2	072000200-0200	2.0 mm	T Handle Hex Socket Key (Long)	25	5755
3	072000250-0200	2.5 mm	T Handle Hex Socket Key (Long)	25	5755
4	072000300-0200	3.0 mm	T Handle Hex Socket Key (Long)	25	5755
5	072000400-0200	4.0 mm	T Handle Hex Socket Key (Long)	10	6710
6	072000500-0200	5.0 mm	T Handle Hex Socket Key (Long)	10	7780
7	072000600-0200	6.0 mm	T Handle Hex Socket Key (Long)	10	10460
8	072000800-0200	8.0 mm	T Handle Hex Socket Key (Long)	10	14110
9	074000150-0200	1.5 mm	T Handle Hex Socket Key (Short)	25	3860
10	074000200-0200	2.0 mm	T Handle Hex Socket Key (Short)	25	3860
11	074000250-0200	2.5 mm	T Handle Hex Socket Key (Short)	25	3860
12	074000300-0200	3.0 mm	T Handle Hex Socket Key (Short)	25	3860
13	074000400-0200	4.0 mm	T Handle Hex Socket Key (Short)	25	4485
14	074000500-0200	5.0 mm	T Handle Hex Socket Key (Short)	25	5230
15	074000600-0200	6.0 mm	T Handle Hex Socket Key (Short)	10	7280
16	074000800-0200	8.0 mm	T Handle Hex Socket Key (Short)	10	10935



# SOCKET KEYS - INCH Series

Recommended Retail Prices in Rupees Per 100 Pieces

Effective 1st April 2026



Sl.No.	Part No.	Size	Description	Qty. per box	Piece per 100 nos. Rs. P.
1	080000400-0200	1/16 inch	Hex Socket Key	100	1565
2	080000500-0200	5/64 inch	Hex Socket Key	100	1565
3	080000600-0200	3/32 inch	Hex Socket Key	100	1565
4	080000800-0200	1/8 inch	Hex Socket Key	100	1565
5	080000900-0200	9/64 inch	Hex Socket Key	100	2775
6	080001000-0200	5/32 inch	Hex Socket Key	100	1855
7	080001200-0200	3/16 inch	Hex Socket Key	100	2380
8	080001400-0200	7/32 inch	Hex Socket Key	50	3370
9	080001600-0200	1/4 inch	Hex Socket Key	50	4705
10	080002000-0200	5/16 inch	Hex Socket Key	25	7715
11	080002400-0200	3/8 inch	Hex Socket Key	25	12055
12	080003200-0200	1/2 inch	Hex Socket Key	10	22975
13	080003600-0200	9/16 inch	Hex Socket Key	10	29505
14	080004000-0200	5/8 inch	Hex Socket Key	10	41055
15	081000400-0200	1/16 inch	Hex Socket Key (Long)	25	2570
16	081000500-0200	5/64 inch	Hex Socket Key (Long)	25	2570
17	081000600-0200	3/32 inch	Hex Socket Key (Long)	25	2570
18	081000800-0200	1/8 inch	Hex Socket Key (Long)	25	2570
19	081001000-0200	5/32 inch	Hex Socket Key (Long)	10	2895
20	081001200-0200	3/16 inch	Hex Socket Key (Long)	10	3750
21	081001400-0200	7/32 inch	Hex Socket Key (Long)	10	4815
22	081001600-0200	1/4 inch	Hex Socket Key (Long)	5	6835



# SOCKET KEYS - T Handle Hex Inch Series

Recommended Retail Prices in Rupees Per 100 Pieces

Effective 1st April 2026



Sl.No.	Part No.	Size	Description	Qty. per box	Piece per 100 nos. Rs. P.
23	082000400-0200	1/16 inch	T Handle Hex Socket Key (Long)	25	5120
24	082000500-0200	5/64 inch	T Handle Hex Socket Key (Long)	25	5755
25	082000600-0200	3/32 inch	T Handle Hex Socket Key (Long)	25	5755
26	082000800-0200	1/8 inch	T Handle Hex Socket Key (Long)	25	5755
27	082001000-0200	5/32 inch	T Handle Hex Socket Key (Long)	10	6400
28	082001200-0200	3/16 inch	T Handle Hex Socket Key (Long)	10	6930
29	082001400-0200	7/32 inch	T Handle Hex Socket Key (Long)	10	7980
30	082001600-0200	1/4 inch	T Handle Hex Socket Key (Long)	10	10650
31	084000400-0200	1/16 inch	T Handle Hex Socket Key (Short)	25	3860
32	084000500-0200	5/64 inch	T Handle Hex Socket Key (Short)	25	3860
33	084000600-0200	3/32 inch	T Handle Hex Socket Key (Short)	25	3860
34	084000800-0200	1/8 inch	T Handle Hex Socket Key (Short)	25	3860
35	084001000-0200	5/32 inch	T Handle Hex Socket Key (Short)	25	4180
36	084001200-0200	3/16 inch	T Handle Hex Socket Key (Short)	25	4705
37	084001400-0200	7/32 inch	T Handle Hex Socket Key (Short)	10	5445
38	084001600-0200	1/4 inch	T Handle Hex Socket Key (Short)	10	7155
39	084002000-0200	5/16 inch	T Handle Hex Socket Key (Short)	10	9995
40	088000000-0200		Hex Socket Key (Inch-Norm) Set	10	41070

**Specification :**

Inch Series : Generally conforming to BS:2470

Material : High grade alloy steel

**Mechanical Properties :**

Hardness : 50 HRc (3/8" & BELOW SIZE)

Hardness : 45 Hrc (Above 3/8"SIZE)

Finish : Zinc Phosphate (Grey/Black) SST Life  
of 72 Hours for Red Rust

**Note :**

- Size stamped in plastic 'T' handle for easy identification
- Metric keys will have red plastic handle
- Inch key will have blue plastic handle

Metric Series : IS 3082: ISO 2936: DIN 911

Material : Special grade alloy steel

**Mechanical Properties:**

Hardness : 50 HRc (1.5mm to 8mm)

: 48 HRc (9mm to 14mm)

: 45 HRc (15mm to 36mm)

Finish : Zinc Phosphate (Grey/Black) SST Life  
of 72 Hours for Red Rust





**Chennai HO**

**C.Rajagopalan,**  
President  
9840670546 / (044)26258460 Ext.491  
rajagopalan.c@sfl.co.in

**P.Ramasubramanian**  
Executive Vice President - Marketing  
9840719892 / (044)26258460 Ext.480  
ramasubramanian.p@sfl.co.in

**North Zone**

<u>Executive Name, Location</u>	<u>State</u>	<u>Mobile Number</u>	<u>Email Id</u>
<b>Auto</b>			
<b>Amit Kumar Roushan</b> , Delhi	<b>Delhi</b>	9677113353	amitkumar.roshan@sfl.co.in
<b>Manu Kumar Sharma</b> , Varanasi	<b>Uttar Pradesh</b>	9384020766	manukumar.sharma@sfl.co.in
<b>Navin Krishna</b> , Kanpur	<b>Uttar Pradesh</b>	9935521232	navin.krishna@sfl.co.in
<b>Vineet Purohit</b> , Jaipur	<b>Rajasthan</b>	9384020771	vineet.purohit@sfl.co.in
<b>Industrial</b>			
<b>Vikas Malhotra</b> , Dehi NCR	<b>Delhi</b>	9871794185	vikas.malhotra@sfl.co.in

**Retail HO Team**

**R.Vasudevan, Chennai**  
GM - Retail Marketing  
9840706124 / (044)26258460 Ext.435  
vasudevan.r2@sfl.co.in

**V.Sadagopan, Chennai**  
9790900117 / (044)26258460 Ext.614  
sadagopan.v@sfl.co.in

**S.Ganesan, Chennai**  
9677063522 / (044)26258460 Ext.571  
ganesan.s@sfl.co.in

**G.Karthik Raja, Chennai**  
7550022002 / (044)26258460 Ext.408  
karthikraja.g@sfl.co.in

**K.Viruthika, Chennai**  
7550079001/(044)26258460 Ext.613  
viruthika.k@sfl.co.in

**Vigneshwaran G, Chennai**  
8925981987  
vigneshwaran.g@sfl.co.in

**East Zone**

<u>Executive Name, Location</u>	<u>State</u>	<u>Mobile Number</u>	<u>Email Id</u>
<b>Auto</b>			
<b>Akshaya Kumar Ray</b> , Kolkata	<b>West Bengal</b>	9677114845	akshayakumar.ray@sfl.co.in
<b>Ashis Ranjan Dalabehera</b> , Cuttack	<b>Odisha</b>	8925967754	ashisranjan.dalabehera@sfl.co.in
<b>Rajat Dey</b> , Guwahati	<b>NorthEast</b>	9864023336	rajat.dey@sfl.co.in
<b>S.Selvakumar</b> , Chennai	<b>East</b>	7338854264	selvakumar.s2@sfl.co.in
<b>Vivek Ranjan</b> , Patna	<b>Bihar &amp; Jharkhand</b>	8925967789	vivek.ranjan@sfl.co.in
<b>Raja Ram Ghosh</b> , Kolkata	<b>West Bengal</b>	8925968506	rajarmghosh@sfl.co.in
<b>Industrial</b>			
<b>Sumit Lahiri</b> , Kolkata	<b>West Bengal</b>	9401726521	sumit.lahiri@sfl.co.in

**West Zone**

<u>Executive Name, Location</u>	<u>State</u>	<u>Mobile Number</u>	<u>Email Id</u>
<b>Auto</b>			
<b>D.Murugan</b> , Nasik	<b>Maharashtra</b>	9552574432	murugan.d@sfl.co.in
<b>Harshid Garg</b> , Indore	<b>Madhya Pradesh</b>	9384020769	harshid.garg@sfl.co.in
<b>Pranshu Arora</b> , Ahmedabad	<b>Gujarat</b>	9384020767	pranshu.arora@sfl.co.in
<b>Sharad Jain</b> , Raipur	<b>Chattisgarh</b>	9384020770	sharad.jain@sfl.co.in
<b>Industrial</b>			
<b>Kaushal Shah</b> , Ahmedabad	<b>Gujarat</b>	9150938887	kaushal.shah@sfl.co.in
<b>Rajeev Suhane</b> , Pune	<b>Maharashtra</b>	9384020768	rajeev.suhane@sfl.co.in
<b>Sanjay B. Kolekar</b> , Mumbai	<b>Maharashtra</b>	7845889619	sanjaykolekar.b@sfl.co.in
<b>Sharad Jain</b> , Raipur	<b>Chattisgarh</b>	9384020770	sharad.jain@sfl.co.in

**TPL**

**S. Selvakumar, Chennai**  
7338854264  
selvakumar.s2@sfl.co.in

**Thiyagarajan SN, Chennai**  
9944202682  
thiyagarajan.sn@tvsp.in

**PA. Venkatesan, Chennai**  
8754536132  
venkatesan.pauldurai@tvsp.in

**Rengarajan.K**  
8438889837  
rengarajan.k@tvsp.in

**South Zone**

<u>Executive Name, Location</u>	<u>State</u>	<u>Mobile Number</u>	<u>Email Id</u>
<b>Auto</b>			
<b>Satheesh kumar.R</b> , Ernakulam	<b>Kerala</b>	8925974568	satheeshkumar.r@sfl.co.in
<b>S.Selvakumar</b> , Chennai	<b>Tamil Nadu</b>	7338854264	selvakumar.s2@sfl.co.in
<b>Syed Vazeeruddin</b> , Vijayawada	<b>Andhra &amp; Telangana</b>	9384016499	syed.vazeeruddin@sfl.co.in
<b>J.Praveen Kumar</b> , Bangalore	<b>Karnataka</b>	7418849555	praveenkumar.j@sfl.co.in
<b>Industrial</b>			
<b>G.Kumaran</b> , Bangalore	<b>Karnataka</b>	9886423351	kumaran.g@sfl.co.in
<b>Syed Vazeeruddin</b> , Vijayawada	<b>Andhra &amp; Telangana</b>	9384016499	syed.vazeeruddin@sfl.co.in
<b>N.Srikanth</b> , Chennai	<b>Tamil Nadu</b>	7418411121	srikanth.n@sfl.co.in