

Painter

INNOVATION
BEYOND
PERFECTION

Catalogue / Price List
1st April, 2025

ELEPHANT

Discount Structure :

1.% Discount on payment within in 30 days of date of invoice.
 2.% Discount on payment against material or within in 7 days of date of invoice.
 3.% Discount on payment against P.I (Proforma Invoice).
- Minimum Order Quantity 50,000/- for any Discount Structure.

Note :

- Com all not be responsible for any breakage of material in transportation.
- Company will only responsible for manufacturing defect (Within 7 Days of Sale) of any product, Company will not give any guarantee warranty of any product.
- Company shell not be responsible for any replacement of product, However if there is any manufacturing defect in our new product then company will liable to provide spare parts on FOC basis.
- Price list may change without prior notice.
- List price and M.R.P. on product may be differ.
- Bilty charge 100/-

- New Product
- Old Price
- Reduce
- Increase



Exclusive Range of Spray Guns...

Conventional
Spray Gun

Professional
Spray Gun

H 827 &
Texture Gun

Automatic Gun
& Paint Tank

Airless &
Putty Sprayer

Pen Gun &
Mini Air Compressor

Electric,
Protective &
Lubricative Gun

Air Blow Gun,
Gas Valve &
Ball Valve

Foam Gun &
Pressure Cleaning Gun

Pressure
Cleaning Gun

Other Spray
Gun

Spray Gun Cup &
Accessories



2100/-

PS-01



1900/-

PS-02



1250/-

PS-03



1580/-

PR-01



1520/-

PR-02



1900/-

H-827



3100/-

PT-01



3500/-

PM-01



10500/-

PL-02

Note : 50/- Extra On Net Cost for Nozzle Size 2.0 mm and 2.5 mm.

Model No.	Operating Pressure	Cup Capacity	Nozzle Size (mm)	Feed	Air Inlet	Weight	Std. Packing
PS-01	20-50 psi	600 ml	1.3, 1.5, 1.7, 2.0, 2.5	Gravity	1/4"	710 gm	20 Pcs.
PS-02	20-40 psi	100 / 300 ml	1.2	Gravity	1/4"	410 gm	30 Pcs.
PS-03	20-40 psi	100 ml	0.9	Gravity	1/4"	325 gm	30 Pcs.
PR-01	30-60 psi	600 ml	1.4, 1.7, 2.0, 2.5	Gravity	1/4"	650 gm	20 Pcs.
PR-02	30-50 psi	300 ml	1.2	Gravity	1/4"	410 gm	30 Pcs.
H-827	20-40 psi	600 ml	1.4	Gravity	1/4"	650 gm	20 Pcs.
PT-01	50-60 psi	600 ml	1.3	Gravity	1/4"	905 gm	10 Pcs.
PM-01	50-65 psi	600 ml	1.5	Gravity	1/4"	735 gm	10 Pcs.
PL-02	50-60 psi	600 ml	1.3	Gravity	1/4"	910 gm	1 Pc.

Note : We Shall Not Be Responsible For Any Breakage/Damage In Transit. However, All Spare Parts Remain Available At Extra Cost.

All Spare Parts Available

P-1



6500/-

PF-01



6500/-

PF-02



8500/-

PJ-01

ITALCO



9000/-

SHINE-2

ITALCO



11000/-

GLOSS-2

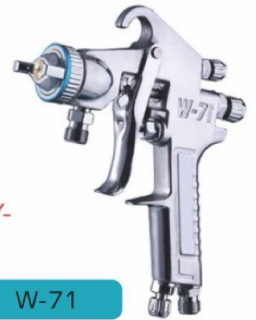

5500/-

W-71



5700/-

W-77



7500/-

W-101



without cup - 2800/-
with cup - 3000/-

SF-12

Note : 100/- Extra On Net Cost for Nozzle Size above 1.7 mm.

Model No.	Operating Pressure	Cup Capacity	Nozzle Size (mm)	Feed	Air Inlet	Weight	Std. Packing
PF-01	30-40 psi	600 ml	1.3, 1.5, 1.7, 2.0, 2.5	Gravity	1/4"	680 gm	10 Pcs.
PF-02	20-30 psi	300 ml	0.5, 0.8, 1.0, 1.2	Gravity	1/4"	460 gm	10 Pcs.
PJ-01	30-40 psi	600 ml	1.2, 1.3, 1.4, 1.5, 1.6, 1.7, 1.8, 2.0, 2.5, 3.0	Gravity	1/4"	660 gm	10 Pcs.
SHINE-2	50-60 psi	600 ml	1.4	Gravity	1/4"	855 gm	1 Pc.
GLOSS-2	50-65 psi	600 ml	1.3	Gravity	1/4"	835 gm	1 Pc.
W-71	40-50 psi	-	1.0, 1.3, 1.5, 1.8	Pressure	1/4"	460 gm	5 Pcs.
W-77	40-50 psi	-	1.5, 2.0, 2.5	Pressure	1/4"	540 gm	5 Pcs.
W-101	30-40 psi	-	0.8, 1.0, 1.3, 1.5, 1.8	Pressure	1/4"	350 gm	5 Pcs.
SF-12	40-60 psi	800 ml	1.7	Suction	1/4"	925 gm	10 Pcs.

Note : We Shall Not Be Responsible For Any Breakage/Damage In Transit. However, All Spare Parts Remain Available At Extra Cost.

All Spare Parts Available

P-2

Aurita



2100/-

H-827

POWER



1300/-

H-827

SUPER AUTO



1200/-

H-827

POWER



950/-

H-2000

POWER



750/-

S-990

POWER



1000/-

W-71 LIGHT

1850/-



TG-16

POWER



1750/-

TG-17

1450/-



TG-22

Model No.	Operating Pressure	Cup Capacity	Nozzle Size (mm)	Feed	Air Inlet	Weight	Std. Packing
AURITA	20-40 psi	600 ml	1.3	Gravity	1/4"	640 gm	20 Pcs.
POWER	20-40 psi	600 ml	1.3	Gravity	1/4"	560 gm	20 Pcs.
SUPER AUTO	20-40 psi	600 ml	1.4	Gravity	1/4"	520 gm	20 Pcs.
H-2000	20-40 psi	100 ml	0.8	Gravity	1/4"	260 gm	20 Pcs.
S-990	40-50 psi	600 ml	1.5	Gravity	1/4"	430 gm	20 Pcs.
W-71 LIGHT	40-50 psi	600 ml	1.3, 1.5, 1.7, 2.0	Suction	1/4"	460 gm	20 Pcs.
TG-16	80-100 psi	2 Ltr.	-	Gravity	5/16"	905 gm	9 Pcs.
TG-17	80-100 psi	2 Ltr.	-	Gravity	1/4"	735 gm	12 Pcs.
TG-22	80-100 psi	3.5 Ltr.	4.0, 6.0, 8.0	Gravity	1/4"	480 gm	6 Pcs.

Note : We Shall Not Be Responsible For Any Breakage/Damage In Transit. However, All Spare Parts Remain Available At Extra Cost.

All Spare Parts Available

P-3

VOYLET



2575/-

H-827

VOYLET



1350/-

F-2

VOYLET



1650/-

K-3

VOYLET



3100/-

HOPPER GUN

VOYLET



2000/-

F-75

VOYLET



2200/-

W-71 S

AIR GUNSA



15700/-

AIR GUNSA

POWER



800/-

R-2

2500/-



NG-24

Model No.	Operating Pressure	Cup Capacity	Nozzle Size (mm)	Feed	Air Inlet	Weight	Std. Packing
H-827	20-40 psi	600 ml	1.3, 1.4, 1.5, 1.7, 2.0, 2.5	Gravity	1/4"	640 gm	10 Pcs.
F-2	30-50 psi	125 ml	0.5	Gravity	1/4"	560 gm	10 Pcs.
K-3	20-40 psi	600 ml	0.5	Gravity	1/4"	520 gm	10 Pcs.
HOPPER GUN	30-50 psi	6000 ml	4.0, 6.0, 8.0	Gravity	1/4"	1.920 kg	6 Pcs.
F-75	40-50 psi	600 ml	1.5	Gravity	1/4"	500 gm	10 Pcs.
W-71 S	40-50 psi	600 ml	1.5	Suction	1/4"	500 gm	10 Pcs.
AIR GUNSA	40-50 psi	600 ml	1.3	Gravity	1/4"	517 gm	1 Pc.
R-2	30-40 psi	200 ml	1.0	Gravity	1/4"	220 gm	10 Pcs.
NG-24	40-80 psi	1000 ml	-	Suction	1/4"	780 gm	10 Pcs.

Note : We Shall Not Be Responsible For Any Breakage/Damage In Transit. However, All Spare Parts Remain Available At Extra Cost.

All Spare Parts Available

P-4



11000/-

WA-101



11500/-

WA-200



6200/-

ST-6



2400/-

DN-18

Prona



17500/-

MRS-F
RELEASE AGENT



6000/-

PT-02



10 ltr. 26000/-
20 ltr. 32000/-
60 ltr. 70000/-

PTA-10 / 20 / 60
WITH AGITATOR



10 ltr. 18000/-
20 ltr. 26000/-

PT-10 / 20
MANUAL

without gun - 10500/-
with gun - 14500/-



PT-08

Model No.	Operating Pressure	Nozzle Size (mm)	Feed	Air Inlet	Weight
WA-101	40-50 psi	0.8, 1.0, 1.2, 1.3, 1.5, 1.8,	Pressure	1/4"	280 gm
WA-200	40-50 psi	1.3, 1.5, 1.8, 2.0, 2.5	Pressure	1/4"	310 gm
ST-6	40-50 psi	0.5, 1.0, 1.3, 2.0	Pressure	6 mm	270 gm
DN-18	30-50 psi	1.0	Pressure	1/4"	400 gm
MRS-F	20-30 psi	0.3, 0.5	Pressure	4 mm	250 gm

Model No.	Capacity	Working Pressure (bar)	Paint Output	Weight
PT-02	2 Ltr.	3.5-4	1/4"	1.5 Kg
PTA-10/20/60	10/20/60 Ltr.	1.4-2.1	1/4"	14.85 / 21.95 / 40.40 Kg
PT-10/20	10/20 Ltr.	1.4-2.0	1/4"	13.65 / 21.35 Kg
PT-08	10 Ltr.	1.4-2.0	1/4"	12.30 Kg

All Spare Parts Available

P-5



24000/-

Paint

P-150



34000/-

Paint

P-4500



40000/-

Paint

AS-1200



45000/-

Paint

R-450



63000/-

Paint / Putty

AS-2800



225000/-

Paint / Putty

AS-4000



6500/-

PG-01

RONGPENG



7000/-

Tip Size : 517

818-C



3000/-

818-L

Model No.	Voltage	Motor Power	Max. Flow Rate	Viscosity (Pa.s)	Max. Pressure	Weight
P-150	220 V	650 W	1.1 L/min	2.5-5.0	2900 psi	6.5 Kg.
P-4500	230 V	900 W	1.8 L/min	2.5-5.0	3200 psi	15 Kg.
AS-1200	220 V	1000 W	2.0 L/min	2.5-5.0	2900 psi	14.5 Kg.
R-450	220 V	900 W	2.0 L/min	2.5-5.0	3300 psi	15.5 Kg.
AS-2800	220 V	2500 W	3.2 L/min	10-15	2900 psi	18 Kg.
AS-4000	220 V	4000 W	10 L/min	20-100	2900 psi	60 Kg.

Model No.	Operating Pressure	Feed	Air Inlet	Weight	Std. Packing
PG-01	7200 psi	Pressure	1/4"	777 gm	1 Pc.
818-C	500 psi	Pressure	1/4"	560 gm	1 Pc.
818-L	3600 psi	Pressure	1/4"	566 gm	1 Pc.

All Spare Parts Available

P-6



1700/-

AB-17



1800/-

AB-19



2700/-

AB-21



9500/-

AS-182



11300/-

AS-186 (3 Ltr.)



950/-

1050/-

AC-02 / AC-03
AIR CONTROLLER



800/-

3 Meter
PGH-01



200/-

50/-

Nut Nipple 1/4" (Male)

CONNECTOR



200/-

200/-

0.3 mm
Needle | Nozzle

Model No.	Operating Pressure	Cup Capacity	Nozzle Size (mm)	Feed	Air Inlet	Weight	Std. Packing
AB-17	10-30 psi	2 ml	0.3	Gravity	6 mm	70 gm	30 Pcs.
AB-19	10-30 psi	7 ml	0.3	Gravity	6 mm	100 gm	30 Pcs.
AB-21	10-30 psi	40 75 ml	0.3	Gravity	6 mm	155 gm	10 Pcs.
Model	Voltage	Power	Speed	Air Flow Capacity	Length of Cable	Noise	Weight
AS-182	220 V	1/6 HP	1450-1700	23 L/min	2 Mtr.	47 db	3.2 Kg.
AS-186	220 V	1/6 HP	1450-1700	23 L/min	2 Mtr.	47 db	5.0 Kg.



2800/-

EGH-10



4200/-

EGH-11



850/-

FG-05
FOUNDRY



900/-

UBC-22
UNDER BODY COATING

POWER



900/-

UBC-23
UNDER BODY COATING



4000/-

PDC-01
PRESSURE DAI CAST



1150/-

OSG-07
OIL SPRAY



1150/-

SBG-09
SAND BLASTING



10000/-

PSM-02
PLASTER SMOOTHING MACHINE

Model No.	Voltage	Cup Capacity	Nozzle Size (mm)	Feed	Power	Cable Length	Weight	Std. Packing
EGH-10	220V-240 V	1200 ml	2.0	Suction	550 W	2.0 Mtr.	1.3 Kg	6 Pcs.
EGH-11	230V-240 V	1500 ml	1.8	Suction	650 W	2.0 Mtr.	1.8 Kg	6 Pcs.
Model No.	Operating Pressure	Cup Capacity	Feed	Air Inlet	Weight	Std. Packing		
FG-05	40-80 psi	-	Pressure	8 mm	320 gm	10 Pcs.		
UBC-22	80-90 psi	-	Suction	1/4"	335 gm	10 Pcs.		
UBC-23	80-150 psi	-	Suction	1/4"	300 gm	20 Pcs.		
PDC-01	40-80 psi	-	Pressure	8 mm	510 gm	5 Pcs.		
OSG-07	40-80 psi	600 ml	Suction	1/4"	630 gm	16 Pcs.		
SBG-09	50-100 psi	600 ml	Gravity	1/4"	530 gm	21 Pcs.		
Model No.	Voltage	Power	Free Speed	Thickness	Weight	Std. Packing		
PSM-02	230V-50Hz	750 W	280-2800 R/min	48 mm	6 Kg	10 Pcs.		

All Spare Parts Available

P-8



425/-

ABG-04



425/-

Brass Thread

ABG-05 P



POWER

165/-

Brass Thread

ABG-06



POWER

175/-

ABG-07



POWER

75/-

Brass Thread

AG-ASB



POWER

190/-

DG-10+1



1/2" - 235/-

1/4", 3/8", 1/2", 3/4", 1", 1.5", 2"

LH-01



300/-

1/2"

300/-

1/2"

GV-M | GV-F



1/2" - 300/-

BF-01

Note : Ball Valve available in all sizes, Price against order.

Model No.	Max. Pressure	Air Inlet	Weight	Std. Packing
ABG-04	8-10 Bar	1/4"	220 gm	50 Pcs.
ABG-05 P	8-10 Bar	1/4"	140 gm	50 Pcs.
ABG-06	8-10 Bar	1/4"	90 gm	100 Pcs.
ABG-07	8-10 Bar	1/4"	90 gm	100 Pcs.
AG-ASB	8-10 Bar	1/4"	55 gm	100 Pcs.
DG-10+1	8-10 Bar	1/4"	125 gm	100 Pcs.

Note : We Shall Not Be Responsible For Any Breakage/Damage In Transit. However, All Spare Parts Remain Available At Extra Cost.



Model No.	Connection	Air Pressure	Weight	Std. Packing
FG-21	1/4"	30-70 psi	640 gm	14 Pcs.
FG-23	Connector Type	50-100 psi	460 gm	30 Pcs.
FG-27	Connector Type	50-100 psi	400 gm	20 Pcs.
FG-26	Push Type	50-100 bar	60 gm	50 Pcs.
FG-01	Connector Type	75-90 psi	250 gm	30 Pcs.
FG-02	Connector Type	75-90 psi	325 gm	30 Pcs.

Model No.	Operating Pressure	Nozzle Size (mm)	Body Material	Weight	Std. Packing
PCG-06 A	50-100 Bar	2.0	Aluminium	530 gm	20 Pcs.
PCG-06 B	50-100 Bar	2.0	Brass	770 gm	20 Pcs.
PCG-10 S.S.	50-100 Bar	2.2	Stainless Steel	520 gm	50 Pcs.

Note : We Shall Not Be Responsible For Any Breakage/Damage In Transit. However, All Spare Parts Remain Available At Extra Cost.

All Spare Parts Available

POWER



500/-

CWG-01

POWER



775/-

CWG-02

POWER



750/-

CWG-03

1200/-



3/8"

PCG-13 TM

1500/-



14mm / 22mm

PCG-11 T

2500/-



PCG-12 TL

475/-



PCG-15

280/-



2.0, 2.5, 3.0 MM

SWN-08

POWER



550/-

ACWG - 10mm

Comp. Operated

Model No.	Max. Pressure	Air Inlet	Weight	Std. Packing
CWG-01	30-70 psi	3/8"	420 gm	20 Pcs.
CWG-02	30-70 psi	3/8"	520 gm	20 Pcs.
CWG-03	30-70 psi	3/8"	420 gm	20 Pcs.
Model No.	Operating Pressure	Weight	Std. Packing	
PCG-13 TM	220 Bar	550 gm	10 Pcs.	
PCG-11 T	220 Bar	520 gm	10 Pcs.	
PCG-12 TL	220 Bar	820 gm	10 Pcs.	
PCG-15	220 Bar	260 gm	10 Pcs.	
SWN-08	50-100 psi	110 gm	50 Pcs.	
ACWG	30-70 psi	350 gm	10 Pcs.	

Note : We Shall Not Be Responsible For Any Breakage/Damage In Transit. However, All Spare Parts Remain Available At Extra Cost.

All Spare Parts Available

P-11

OTHER BRAND

SPRAY GUN

1 Pint - 785/-
1/2 Pint - 735/-



ONIDA

890/-



NOVA-1

850/-



NOVA-1/2

890/-



POWER - 1

850/-



POWER - 1/2

800/-



POWER OIL GUN

490/-



POWER-1/4

515/-



USA INDIA-1/4

540/-



J.K. INDIA-1/4

3000/-



SUPER SPRAY

3700/-



AC-30

3750/-



AC-60



235/-

600 ML MALE



235/-

600 ML FEMALE



400/-

600 ML S.S.



200/-

600 ML M.S.



350/-

300 ML S.S.



150/-

300 ML M.S.



600ml-1360/-
1000ml-1500/-

600 ML SUCTION



200/-

300 ML MALE



180/-

100 ML MALE



180/-

100 ML S.S.



180/-

100 ML ALU.



300/-

MF 80 - FILTER



1200/-

ACWG-01



250/-

ACWG-02



1100/-

818-C TIP



875/-

818-L TIP

209, 210, 211, 311, 313, 315, 413, 415, 419, 513, 515, 517, 519, 521, 619, 621

211, 311, 315, 413, 415, 419, 513, 517, 519, 521, 619, 621



4000/-

Length: 15 Mtr.
Connection Size: 1/4" F

ASH-01
AIRLESS SPRAY HOSE



800/-

ATG-01
AIRLESS TIP GUARD



700/-

AE-01
AIRLESS EXTENSION



250/-

AGF-01
AIRLESS GUN FILTER

Exclusive Range of Garage Equipment...

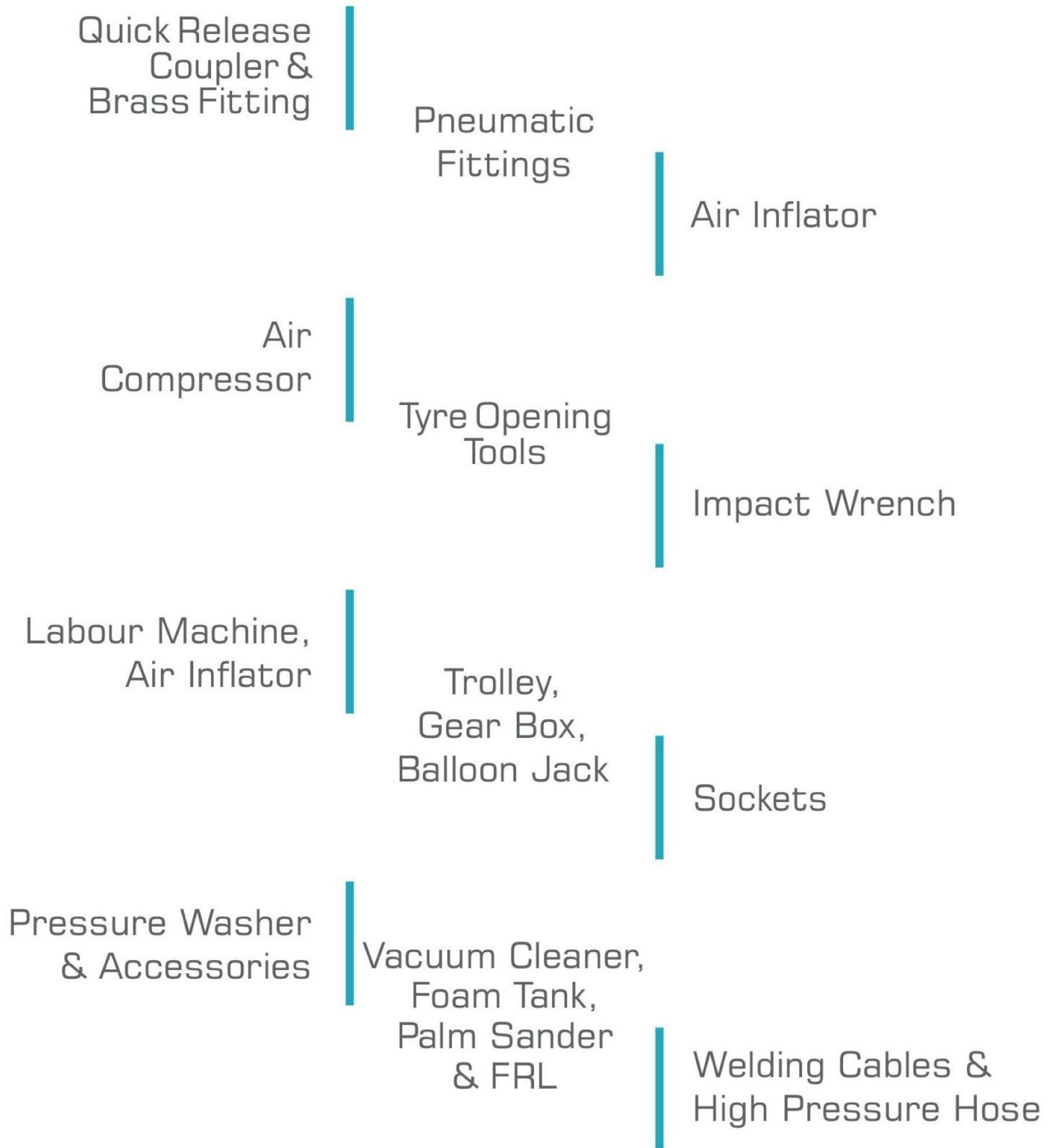



MODEL	PNEUMATIC COUPLING - REGULAR QUALITY MADE OF STEEL							
SIZE	PH	PP	PM	PF	SH	SP	SM	SF
1/4" /20	13/-	13/-	13/-	13/-	50/-	50/-	50/-	50/-
3/8" /30	25/-	25/-	25/-	25/-	60/-	60/-	60/-	60/-
1/2" /40	34/-	34/-	34/-	34/-	70/-	70/-	70/-	70/-



MODEL	PNEUMATIC COUPLING (HIGH QUALITY - JAPANESE STANDARD) STEEL BODY - ONE TOUCH							
SIZE	JPH	JPP	JPM	JPF	JSH	JSP	JSM	JSF
1/4" /20	34/-	34/-	34/-	34/-	180/-	180/-	180/-	180/-
3/8" /30	60/-	60/-	60/-	60/-	200/-	200/-	200/-	200/-
1/2" /40	65/-	65/-	65/-	65/-	210/-	210/-	210/-	210/-

1 HEX SOCKET

Code No.	Size	Rate/Pc.
HS 001	1/8	24/-
HS 002	1/4	46/-
HS 003	1/4	37/-
HS 004	1/4	74/-
HS 005	1/4	109/-
HS 006	3/8	62/-
HS 007	3/8	107/-
HS 008	1/2	87/-
HS 009	3/4	294/-
HS 010	3/4	265/-
HS 011	3/4	242/-
HS 012	1	340/-
HS 013	1	265/-



2 OLIVE UNION ONLY (BSP)

Code No.	Tube ID	Rate/Pc.
OUO 001	1/8	19/-
OUO002	3/16	19/-
OUO 003	1/4	30/-
OUO 004	5/16	30/-
OUO 005	3/8	49/-
OUO 006	1/2	82/-
OUO 007	5/8	145/-
OUO 008	3/4	182/-
OUO 009	1"	58/-



3 COMPRESSION ADAPTOR MALE X FEMALE

Code No.	Male(Bsp)	Female(Npt)	Rate
CAMF 001	1/8	1/4	56/-
CAMF 002	1/4	1/4	56/-
CAMF 003	1/4	3/8	80/-
CAMF 004	3/8	1/4	76/-



M.O.Q. : 25 Nos. Each

4 HOSE NIPPLE MALE

(BSP X HOSE)

Code No.	Size		Rate/Pc.
HNM 001	1/8	1/8	21/-
HNM 002	1/8	1/4	23/-
HNM 003	1/8	5/16	27/-
HNM 004	1/8	3/8	32/-
HNM 005	1/8	1/2	48/-
HNM 006	1/4	1/8	31/-
HNM 007	1/4	1/4	30/-
HNM 008	1/4	5/16	31/-
HNM 009	1/4	3/8	37/-
HNM 010	1/4	1/2	44/-
HNM 011	3/8	1/4	48/-
HNM 012	3/8	5/16	48/-
HNM 013	3/8	3/8	46/-
HNM 014	3/8	1/2	59/-
HNM 015	1/2	1/4	62/-
HNM 016	1/2	5/16	62/-
HNM 017	1/2	3/8	62/-
HNM 018	1/2	1/2	62/-
HNM 019	1/2	5/8	90/-
HNM 020	1/2	3/4	102/-



5 HOSE NIPPLE FEMALE

(FEMALE X HOSE)

Code No.	Size		Rate/Pc.
HNF 001	1/8	1/8	33/-
HNF 002	1/8	1/4	34/-
HNF 003	1/8	5/16	34/-
HNF 004	1/8	3/8	44/-
HNF 005	1/4	1/8	57/-
HNF 006	1/4	1/4	53/-
HNF 007	1/4	5/16	53/-
HNF 008	1/4	3/8	55/-
HNF 009	1/4	1/2	59/-
HNF 010	3/8	1/4	67/-
HNF 011	3/8	5/16	67/-
HNF 012	3/8	3/8	67/-
HNF 013	3/8	1/2	67/-
HNF 014	1/2	1/4	105/-
HNF 015	1/2	5/16	105/-
HNF 016	1/2	3/8	107/-
HNF 017	1/2	1/2	107/-



6 STRAIGHT JOINT NIPPLE (HOSE)

Code No.	Size	Rate/Pc.
SJN 001	3/16	18/-
SJN 002	1/4	19/-
SJN 003	5/16	29/-
SJN 004	3/8	37/-
SJN 005	1/2	62/-
SJN 006	3/4	150/-



7 TEE JOINT NIPPLE (HOSE)

Code No.	Tube ID	Rate/Pc.
TJN 001	3/16	56/-
TJN 002	1/4	47/-
TJN 003	5/16	60/-
TJN 004	3/8	76/-
TJN 005	1/2	125/-
TJN 006	5/8	202/-
TJN 007	3/4	310/-
TJN 008	1	508/-



8 Y JOINT NIPPLE (HOSE)

Code No.	Size	Rate/Pc.
YJN 001	1/4	60/-
YJN 002	5/16	66/-
YJN 003	3/8	88/-
YJN 004	1/2	125/-



9 CROSS JOINT NIPPLE (HOSE)

Code No.	Size	Rate/Pc.
CJN 001	1/4	76/-
CJN 002	5/16	90/-
CJN 003	3/8	112/-
CJN 004	1/2	178/-



10 HEX PLUG (BSP)

Code No.	Size	Rate/Pc.
HHP 001	1/8	17/-
HHP 002	1/4	28/-
HHP 003	3/8	58/-
HHP 004	1/2	103/-
HHP 005	3/4	186/-
HHP 006	1	207/-



11 OLIVE ELBOW MALE (BSP)

Code No.	Tube ID	Rate/Pc.
OEM 001	1/8	45/-
OEM 002	3/16	45/-
OEM 003	1/4	54/-
OEM 004	5/16	54/-
OEM 005	3/8	97/-
OEM 006	1/2	157/-
OEM 007	5/8	215/-
OEM 008	3/4	310/-
OEM 009	1"	525/-



15 OLIVE TEE MALE (BSP)

Code No.	Tube ID	Rate/Pc.
OTM 001	1/8	58/-
OTM 002	3/8	58/-
OTM 003	1/4	74/-
OTM 004	5/16	74/-
OTM 005	3/8	120/-
OTM 006	1/2	207/-
OTM 007	5/8	290/-
OTM 008	3/4	345/-
OTM 009	1"	665/-



12 UNION ELBOW FEMALE (BSP)

Code No.	Size	Rate/Pc.
UEF 001	1/8	60/-
UEF 002	1/4	88/-
UEF 003	3/8	142/-
UEF 004	1/2	228/-
UEF 005	3/4	470/-
UEF 006	1	650/-



16 UNION TEE FEMALE (BSP)

Code No.	Size	Rate/Pc.
UTF 001	1/8	80/-
UTF 002	1/4	109/-
UTF 003	3/8	152/-
UTF 004	1/2	268/-
UTF 005	3/4	530/-
UTF 006	1	780/-



13 FOUR WAY MALE (BSP)

(OD X BSPT X OD)

Code No.	Size	Rate/Pc.
FWM 001	1/8	97/-
FWM 002	3/16	97/-
FWM 003	1/4	114/-
FWM 004	5/16	114/-
FWM 005	3/8	175/-
FWM 006	1/2	278/-
FWM 007	3/4	470/-



17 REDUCING UNION ONLY (BSP)

Code No.	Size		Rate/Pc.
RUO 001	1/8	3/16	22/-
RUO 002	1/8	1/4	30/-
RUO 003	1/8	5/16	32/-
RUO 004	1/8	3/8	50/-
RUO 005	1/8	1/2	88/-
RUO 006	1/4	5/16	30/-
RUO 007	1/4	3/8	48/-
RUO 008	1/4	1/2	85/-
RUO 009	1/4	3/4	190/-
RUO 010	1/4	1	278/-
RUO 011	3/8	5/16	52/-
RUO 012	3/8	1/2	83/-
RUO 013	3/8	5/8	150/-
RUO 014	3/8	3/4	185/-
RUO 015	3/8	1	278/-
RUO 016	1/2	5/16	86/-
RUO 017	1/2	5/8	148/-
RUO 018	1/2	3/4	185/-
RUO 019	1/2	1	276/-



14 UNION FOUR FEMALE (BSP)

Code No.	Size	Rate/Pc.
UWF 001	1/8	109/-
UWF 002	1/4	155/-
UWF 003	3/8	244/-
UWF 004	1/2	375/-
UWF 005	3/4	550/-



18 PU ELBOW ASSEMBLY

(BSP X TUBEOD)

Code No.	Size	Rate/Pc.
PUE 001	1/8 6mm	78/-
PUE 002	1/8 8mm	82/-
PUE 003	1/4 6mm	82/-
PUE 004	1/4 8mm	86/-
PUE 005	1/4 10mm	152/-
PUE 006	1/4 12mm	162/-
PUE 007	3/8 10mm	152/-
PUE 008	3/8 12mm	162/-
PUE 009	1/2 10mm	221/-
PUE 010	1/2 12mm	235/-



21 EQUAL PU ELBOW ASSEMBLY

(TUBEOD X TUBEOD)

Code No.	Size	Rate/Pc.
EPUE 001	6mm 6mm	95/-
EPUE 002	8mm 8mm	105/-
EPUE 003	10mm 10mm	178/-
EPUE 004	12mm 12mm	200/-



22 EQUAL PU CONNECTOR ASSEMBLY

(TUBEOD X TUBEOD)

Code No.	Size	Rate/Pc.
EPUC 001	6 mm 6 mm	76/-
EPUC 002	8 mm 8 mm	97/-
EPUC 003	10 mm 10 mm	140/-
EPUC 004	12 mm 12 mm	215/-



19 PU CONNECTOR ASSEMBLY

(BSP X TUBEOD)

Code No.	Size	Rate/Pc.
PUC 001	1/8 6 mm	41/-
PUC 002	1/8 8 mm	45/-
PUC 003	1/4 6 mm	44/-
PUC 004	1/4 8 mm	46/-
PUC 005	1/4 10 mm	92/-
PUC 006	1/4 12 mm	113/-
PUC 007	3/8 6 mm	82/-
PUC 008	3/8 8 mm	88/-
PUC 009	3/8 10 mm	103/-
PUC 010	3/8 12 mm	128/-
PUC 011	3/8 14 mm	155/-
PUC 012	1/2 8 mm	134/-
PUC 013	1/2 10 mm	155/-
PUC 014	1/2 12 mm	174/-
PUC 015	1/2 16 mm	205/-



23 PU CONNECTOR FEMALE ASSEMBLY

(FEMALE X TUBEOD)

Code No.	Size	Rate/Pc.
PUF 001	1/8 6 mm	52/-
PUF 002	1/8 8 mm	58/-
PUF 003	1/4 6 mm	68/-
PUF 004	1/4 8 mm	74/-
PUF 005	1/4 10 mm	100/-



20 EQUAL PU TEE ASSEMBLY

(TUBEOD X TUBEOD X TUBEOD)

Code No.	Size	Rate/Pc.
EPUT 001	6 mm 6 mm 6 mm	122/-
EPUT 002	8 mm 8 mm 8 mm	148/-
EPUT 003	10 mm 10 mm 10 mm	242/-
EPUT 004	12 mm 12 mm 12 mm	295/-



24 PT MALE TEE BRANCH

Model	Size	Rate/Pc.
06-01	6 x 1/8"	36/-
06-02	6 x 1/4"	43/-
06-03	6 x 3/8"	55/-
06-04	6 x 1/2"	78/-
08-01	8 x 1/8"	46/-
08-02	8 x 1/4"	49/-
08-03	8 x 3/8"	58/-
08-04	8 x 1/2"	85/-
10-01	10 x 1/8"	61/-
10-02	10 x 1/4"	61/-
10-03	10 x 3/8"	67/-
10-04	10 x 1/2"	87/-
12-01	12 x 1/8"	74/-
12-02	12 x 1/4"	74/-
12-03	12 x 3/8"	79/-
12-04	12 x 1/2"	88/-



PNEUMATIC FITTINGS

OTHER BRAND

PNEUMATIC FITTINGS

25 PUC - EQUAL UNION

Size	Rate/Pc.
6	8/-
8	9/-
10	14/-
12	17/-



29 PZA - UNION CROSS

Size	Rate/Pc.
6	24/-
8	27/-
10	39/-
12	44/-



26 PUT - EQUAL TEE

Size	Rate/Pc.
6	15/-
8	17/-
10	23/-
12	29/-



30 PUL - EQUAL ELBOW

Size	Rate/Pc.
6	11/-
8	12/-
10	17/-
12	21/-



27 PY - EQUAL Y

Size	Rate/Pc.
6	15/-
8	17/-
10	29/-
12	34/-



31 PG - UNEQUAL UNION

Size	Rate/Pc.
6-4	11/-
8-6	11/-
10-8	15/-
12-8	18/-



28 PC CONNECTOR

Model	Size	PC
06-01	6 x 1/8"	20/-
06-02	6 x 1/4"	20/-
06-03	6 x 3/8"	36/-
06-04	6 x 1/2"	52/-
08-01	8 x 1/8"	20/-
08-02	8 x 1/4"	20/-
08-03	8 x 3/8"	36/-
08-04	8 x 1/2"	52/-
10-01	10 x 1/8"	34/-
10-02	10 x 1/4"	34/-
10-03	10 x 3/8"	38/-
10-04	10 x 1/2"	52/-
12-01	12 x 1/8"	47/-
12-02	12 x 1/4"	47/-
12-03	12 x 3/8"	49/-
12-04	12 x 1/2"	52/-



32 PCF CONNECTOR

Model	Size	PCF
06-01	6 x 1/8"	32/-
06-02	6 x 1/4"	47/-
06-03	6 x 3/8"	69/-
06-04	6 x 1/2"	100/-
08-01	8 x 1/8"	41/-
08-02	8 x 1/4"	49/-
08-03	8 x 3/8"	70/-
08-04	8 x 1/2"	100/-
10-01	10 x 1/8"	66/-
10-02	10 x 1/4"	61/-
10-03	10 x 3/8"	75/-
10-04	10 x 1/2"	100/-
12-01	12 x 1/8"	78/-
12-02	12 x 1/4"	88/-
12-03	12 x 3/8"	95/-
12-04	12 x 1/2"	100/-



M.O.Q. : 25 Nos. Each

E-5



250/-

52 gm

NM-01
OPEN END



250/-

52 gm

NM-02
CLOSE END



140/-

28 gm

NM-03



240/-

66 gm

NM-04



100/-

30 gm

NM-05

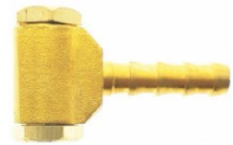

175/-

59 gm

NM-06



225/-

NM-07



250/-

NM-13

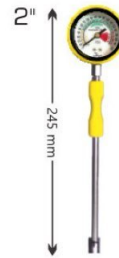

400/-

NM-08



365/-

NM-09



300/-

NM-10



600/-

NM-11



550/-

NM-12



525/-

NM-14



16/-

12x0.1mm x 11-12 Mtr.

TT-01

M.O.Q. : 10 Nos. Each

E-6



PU HOSE



PU COIL

Model No.	Size - O.D. x I.D. (mm)	Standard Length Meters / Roll	Price
ELP-0425	4x2.5	200	14/-
ELP-0604	6x4	100	22/-
ELP-0805	8x5	100	38/-
ELP-0855	8x5.5	100	35/-
ELP-0806	8x6	100	30/-
ELP-1065	10x6.5	100	50/-
ELP-1080	10x8	100	42/-
ELP-1280	12x8	100	72/-
ELP-1612	16x12	50	115/-

PU COIL

Model No.	Size - O.D. x I.D. (mm)	Price (10 Mtr.)
ELP-0604C	6x4	425/-
ELP-0805C	8x5	525/-
ELP-1065C	10x6.5	700/-
ELP-1208C	12x8	825/-

Also, Available with End Fittings, with 125/- Extra On 8x5 mm Coils & 150/- Extra on 12x8 mm Coils on Net. Prices. (end Fittings Contains Both Size Springs & Brass Fittings)

Pu Coils are Available In 4 Sizes - 5, 10, 15, 20 Meter.

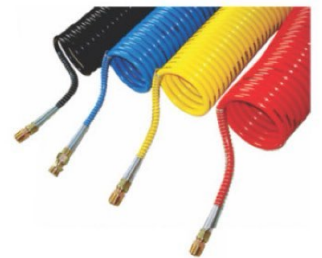



PU HOSE



PU COIL

Model No.	Size - O.D. x I.D. (mm)	Standard Length Meters / Roll	Price
PWR-0425	4x2.5	200	8/-
PWR-0604	6x4	100	11/-
PWR-0805	8x5	100	20/-
PWR-0855	8x5.5	100	18/-
PWR-0806	8x6	100	17/-
PWR-1065	10x6.5	100	29/-
PWR-1080	10x8	100	24/-
PWR-1280	12x8	100	38/-
PWR-1612	16x12	50	70/-

PU COIL

Model No.	Size - O.D. x I.D. (mm)	Price (10 Mtr.)
PWR-0604C	6x4	300/-
PWR-0805C	8x5	325/-
PWR-1065C	10x6.5	450/-
PWR-1208C	12x8	500/-

Also, Available with End Fittings, with 125/- Extra On 8x5 mm Coils & 150/- Extra on 12x8 mm Coils on Net. Prices.
(end Fittings Contains Both Size Springs & Brass Fittings)

Pu Coils are Available In 4 Sizes - 5, 10, 15, 20 Meter.

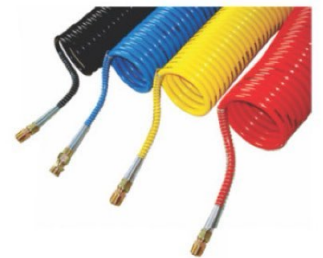



PU HOSE

Model No.	Size - O.D. x I.D. (mm)	Standard Length Meters / Roll	Price
WINGS-0425	4x2.5	200	7/-
WINGS-0604	6x4	100	10/-
WINGS-0805	8x5	100	15/-
WINGS-0855	8x5.5	100	14/-
WINGS-0806	8x6	100	13/-
WINGS-1065	10x6.5	100	23/-
WINGS-1080	10x8	100	21/-
WINGS-1280	12x8	100	32/-
WINGS-1612	16x12	50	68/-

AIR CONTROL SWITCH & DRAIN VALVE

450/-



KB-1 / KB-4

1050/-
1230/-



ACS-15/15V

1800/-



DV-01



Model No.	HP	Speed	Air Flow	Max. Pressure	Tank Volume	Weight (N.W)	Std. Packing
AC-08 DC	1.2	2800 rpm	65 L/min	8 bar	8 Ltr.	13 kg	1 Pc.
AC-30 DC	1.5	2800 rpm	75 L/min	8 bar	30 Ltr.	18 kg	1 Pc.
AC-50 DC	2	2800 rpm	95 L/min	8 bar	50 Ltr.	25 kg	1 Pc.
AC-30 C	2	2850 rpm	200 L/min	8 bar	30 Ltr.	22 kg	1 Pc.
AC-50 C	2	2850 rpm	200 L/min	8 bar	50 Ltr.	32 kg	1 Pc.
AC-100LT	2	1050 rpm	170 L/min	8 bar	100 Ltr.	64 kg	1 Pc.
AC-150LT	3	1050 rpm	250 L/min	8 bar	150 Ltr.	84 kg	1 Pc.
PC-30	2	2850 rpm	138 L/min	8 bar	30 Ltr.	20 kg	1 Pc.
PC-50	2	2850 rpm	138 L/min	8 bar	50 Ltr.	29 kg	1 Pc.

Note : We Shall Not Be Responsible For Any Breakage/Damage In Transit. However, All Spare Parts Remain Available At Extra Cost.

Oil : 15W-40

All Spare Parts Available

E-10



9000/-
10.5 Kg
TBB-01
TYRE BEAD BREAKER



7000/-
11.5 Kg
BBG-01
TYRE BEAD BLASTER



8000/-
12 Kg
BBG-02
TYRE BEAD BLASTER



9800/-
12.5 Kg
TV-01
TYRE VULCANIZER



18,000/-
19 Kg
TV-02
TYRE VULCANIZER



10,000/-
14 Kg
TMDT-01
MOUNTING DISMOUNTING TOOL

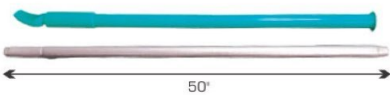

2800/-
11 Kg
H-01
HAMMER

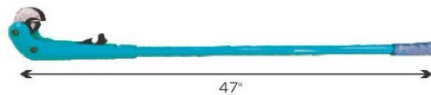

2600/-
6.5 Kg
P-01
PLIER



10,000/-
13 Kg
PH-01
PNEUMATIC HAMMER

All Spare Parts Available



IW 02-E



IW 02-C



IW 02-127



IW 02-L



IW 02



IW 02-CM



IW 02-BR420



IW 02-A6



IW 02-X8

Model No.	Max. Torque	Free Speed	Size	Bolt Capacity	Mechanism	Air Inlet	Air Pressure	Air Consumption	Weight	Std. Packing
IW02-E	550 N.m.	11000 rpm	1/2"	13 mm	Twin Hammer	1/4"	6-8 Kg	0.22 m ³ /min	1.4 Kg	5 Pcs.
IW02-C	520 N.m.	9300 rpm	1/2"	14 mm	Twin Hammer	1/4"	6-8 Kg	0.38 m ³ /min	1.7 Kg	5 Pcs.
IW02-127	520 N.m.	9300 rpm	1/2"	14 mm	Twin Hammer	1/4"	6-8 Kg	0.38 m ³ /min	1.6 Kg	5 Pcs.
IW02-L	680 N.m.	8000 rpm	1/2"	18 mm	Twin Hammer	1/4"	6-8 Kg	0.24 m ³ /min	2.7 Kg	5 Pcs.
IW02	850 N.m.	7500 rpm	1/2"	18 mm	Twin Hammer	1/4"	6-8 Kg	0.25 m ³ /min	3.1 Kg	5 Pcs.
IW02-CM	900 N.m.	8000 rpm	1/2"	18 mm	Twin Hammer	1/4"	6-8 Kg	0.25 m ³ /min	2.2 Kg	5 Pcs.
IW02-BR 420	980 N.m.	7000 rpm	1/2"	18 mm	Twin Hammer	1/4"	6-8 Kg	0.38 m ³ /min	5.2 Kg	5 Pcs.
IW02-A6	800 N.m.	8000 rpm	1/2"	14 mm	Twin Hammer	1/4"	6-8 Kg	0.37 m ³ /min	2.5 Kg	5 Pcs.
IW02-X8	880 N.m.	8000 rpm	1/2"	16 mm	Twin Hammer	1/4"	6-8 Kg	0.37 m ³ /min	1.5 Kg	5 Pcs.

Note : We Shall Not Be Responsible For Any Breakage/Damage In Transit. However, All Spare Parts Remain Available At Extra Cost.

Oil : 20W-40

All Spare Parts Available

E-12



IW 02-S



IW 02-A16



IW 02-B2



IW 03



IW 01



IW 04-P



IW 04-PT



IW 04-PH



IW 04-CL

Model No.	Max. Torque	Free Speed	Size	Bolt Capacity	Mechanism	Air Inlet	Air Pressure	Air Consumption	Weight	Std. Packing
IW02-S	520 N.m.	9000 rpm	1/2"	13 mm	Twin Hammer	1/4"	6-8 Kg	0.22 m³/min	1.6 Kg	5 Pcs.
IW02-A16	520 N.m.	9300 rpm	1/2"	14 mm	Twin Hammer	1/4"	6-8 Kg	0.45 m³/min	1.1 Kg	5 Pcs.
IW02-B2	660 N.m.	8500 rpm	1/2"	16 mm	Twin Hammer	1/4"	6-8 Kg	0.45 m³/min	2.6 Kg	5 Pcs.
IW03	1350 N.m.	6000 rpm	3/4"	32 mm	Twin Hammer	3/8"	6-10 Kg	0.38 m³/min	5.2 Kg	2 Pcs.
IW01	520 N.m.	9000 rpm	3/8"	13 mm	Twin Hammer	1/4"	6-8 Kg	0.22 m³/min	1.6 Kg	5 Pcs.
IW04-P	1700 N.m.	4600 rpm	1"	33 mm	Twin Hammer	1/2"	6-10 Kg	0.40 m³/min	7.3 Kg	2 Pcs.
IW04-PT	2180 N.m.	4500 rpm	1"	41 mm	Pinless Hammer	1/2"	8-12 Kg	0.68 m³/min	12.5 Kg	2 Pcs.
IW04-PH	2400 N.m.	4500 rpm	1"	30 mm	Twin Hammer	1/2"	6-10 Kg	0.80 m³/min	9.0 Kg	2 Pcs.
IW04-CH	1950 N.m.	5000 rpm	1"	41 mm	Twin Hammer	1/2"	8-12 Kg	0.50 m³/min	7.3 Kg	1 Pc.

Note : We Shall Not Be Responsible For Any Breakage/Damage In Transit. However, All Spare Parts Remain Available At Extra Cost.

Oil : 20W-40

All Spare Parts Available

E-13



17500/-

IW 04-L



20000/-

IW 04



20000/-

IW 04-T



23000/-

IW 04-T PLUS



23500/-

IW 04-H



33000/-

IW 04-Y19



35000/-

TU 90-D



37000/-

TU 80-D



7000/-

20 KG

IWT-01

Model No.	Max. Torque	Free Speed	Size	Bolt Capacity	Mechanism	Air Inlet	Air Pressure	Air Consumption	Weight	Std. Packing
IW04-L	2180 N.m.	4200 rpm	1"	41 mm	Pinless Hammer	1/2"	8-12 Kg	0.70 m³/min	14.0 Kg	1 Pc.
IW04	2980 N.m.	3800 rpm	1"	39 mm	Pinless Hammer	1/2"	8-12 Kg	0.70 m³/min	17.0 Kg	1 Pc.
IW04-T	2980 N.m.	3800 rpm	1"	39 mm	Pinless Hammer	1/2"	8-12 Kg	0.70 m³/min	17.0 Kg	1 Pc.
IW04-T PLUS	3200 N.m.	3200 rpm	1"	39 mm	Pinless Hammer	1/2"	8-12 Kg	0.71 m³/min	16.4 Kg	1 Pc.
IW04-H	3800 N.m.	3300 rpm	1"	50 mm	Pinless Hammer	1/2"	8-12 Kg	0.78 m³/min	19.0 Kg	1 Pc.
IW04-Y19	4500 N.m.	4200 rpm	1"	50 mm	Pinless Hammer	1/2"	8-12 Kg	1.05 m³/min	16.8 Kg	1 Pc.
TU90-D	5000 N.m.	2700 rpm	1"	55 mm	Pinless Hammer	1/2"	8-12 Kg	1.24 m³/min	19.2 Kg	1 Pc.
TU80-D	5200 N.m.	3000 rpm	1"	55 mm	Pinless Hammer	1/2"	8-12 Kg	1.24 m³/min	16.8 Kg	1 Pc.

Note : We Shall Not Be Responsible For Any Breakage/Damage In Transit. However, All Spare Parts Remain Available At Extra Cost.

Oil : 20W-40

All Spare Parts Available

E-14



20000/-

IW 04-S



1.5"

65000/-

IW 05-S



4200/-

LSM-01



5000/-

LSM-02



1060/-

FP-01



2000/-

AP-01



2350/-

GGH-01



300/-

GGH-01 RK

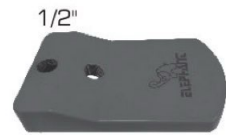

1/2"

700/-



1"

1400/-

ES-01 | ES-02

Model No.	Max. Torque	Free Speed	Size	Bolt Capacity	Mechanism	Air Inlet	Air Pressure	Air Consumption	Weight	Std. Packing
IW 04-S	2980 N.m.	3800 rpm	1"	48 mm	Pinless Hammer	1/2"	8-12 Kg	0.71 m³/min	15.6 Kg	1 Pc.
IW 05-S	7200 N.m.	2800 rpm	1.5"	52 mm	Pinless Hammer	1/2"	6-10 Kg	0.31 m³/min	19.2 Kg	1 Pc.

Model No.	Max. Torque	Size	Length	Bolt Capacity	Mechanism	Weight	Std. Packing
LSM-01	3200 N.m.	1"	360 mm	1:68	Manual	9 Kg	3 Pcs.
LSM-02	3800 N.m.	1"	365 mm	1:88	Manual	10 Kg	3 Pcs.

Model No.	Power Source	Body	Piston Material	Air Nozzle	Air Hose Length	Weight	Std. Packing
FP-01	Manual	M.S.	Cast Iron	Plastic	0.75 Mtr.	2.1 Kg	12 Pcs.
AP-01	DC 12 Volt	ALU	-	Brass	1 Mtr.	1.7 Kg	6 Pcs.

Note : We Shall Not Be Responsible For Any Breakage/Damage In Transit. However, All Spare Parts Remain Available At Extra Cost.

All Spare Parts Available

E-15



TJ-03



TJ-05



ATJ-04H



GBJ-01



JS-3T



BJ-03 | BJ-05



120/-

(Rubber) 60 mm

JG-01
JACK GASKET



140/-

(PU) 60 mm

JG-02
JACK GASKET



120/-

(PU) 45x75x20

BG-01
BOTTLE GASKET

Note : All Size of Trolley Jack & Bottle Jack gasket Available price against Order

Model No.	Capacity	Maximum Height (mm)	Minimum Height (mm)	Plate Size (mm)	Length (mm)	Weight	Price
TJ-2	2 Ton	390	165	6	736	21.95 kg.	8200/-
TJ-2.5	2.5 Ton	460	165	7	762	25.85 kg.	8600/-
TJ-3	3 Ton	460	165	8	762	28.20 kg.	9300/-
TJ-4	4 Ton	525	160	10	890	35.50 kg.	11000/-
TJ-5	5 Ton	455	150	10	1397	74 kg.	28500/-
TJ-10	10 Ton	455	150	12	1447	98 kg.	37000/-
TJ-15	15 Ton	455	150	14	1447	150 kg.	63000/-
TJ-20	20 Ton	455	150	18	1447	180 kg.	70000/-
TJ-25	25 Ton	431	190	23	1447	200 kg.	81000/-
ATJ-03H	3 Ton	456	120	-	-	29.5 kg.	14800/-
ATJ-04H	4 Ton	510	75	-	-	32 kg.	15800/-
GBJ-01	20 mm	762	203	-	812	55 kg.	16000/-
GBJ-02	25 mm	762	203	-	812	66 kg.	18500/-
JS-3T	3 Ton	415	285	-	-	5.2 kg.	2200/-
BJ-03	3 Ton	400	145	-	-	17 kg.	13000/-
BJ-05	5 Ton	400	150	-	-	24 kg.	19500/-

Note : We Shall Not Be Responsible For Any Breakage/Damage In Transit. However, All Spare Parts Remain Available At Extra Cost.

Oil : Hydraulic Oil 68

All Spare Parts Available

E-16

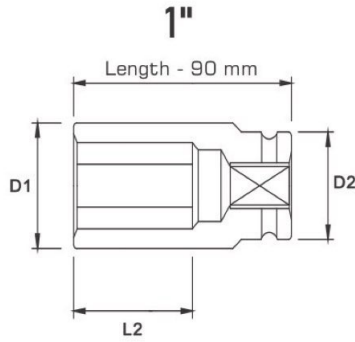

6 Point STD Impact Socket

■ 1" Square Drive ○ 6 Point Sockets

Size (mm)	24	26	27	28	30	32	33
Price-	390	390	390	390	390	390	390
Size (mm)	34	35	36	38	41	45	46
Price-	390	440	440	440	440	900	900
Size (mm)	50	55	60	65	70	75	80
Price-	1000	1100	1400	1600	1800	2000	3000
Size (mm)	85	90	95	100	105	110	
Price-	3500	4800	5400	6500	7500	9500	

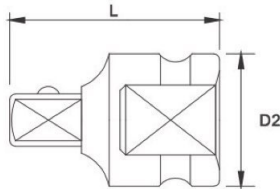

Impact Adaptor

Model no.	IA01	IA02	IA03	IA04	IA05	IA06	IA07	IA08
Female	3/8"	1/2"	1/2"	1/2"	3/4"	3/4"	1"	1"
Male	1/2"	3/8"	3/4"	1"	1/2"	1"	1/2"	3/4"
Price-	300	300	450	650	450	650	650	650



Universal Joint

Model no.	UJ-01	UJ-02	UJ-03
Size	1"	3/4"	1/2"
Price-	3000/-	2000/-	1000/-



SS 01 - 38 MM (15 Pcs.)

8,9,10,11,12,13,14,15
17,19,21,22,24,27,32 mm



SS 02 - 78 MM (15 Pcs.)

8,9,10,11,12,13,14,15
17,19,21,22,24,27,32 mm



SS 03 - 90 MM (14 Pcs.)

17,19,21,22,24,26,27,
28,30,32,34,36,38,41 mm



← 1 PHASE

34000/-

Copper Winding
HPP 01-2.2 HP



← 1 PHASE

57000/-

Copper Winding
HPP 02- 4 HP



← 3 PHASE

99000/-

Copper Winding
HPP 03-7.5 HP



12000/-

HPP-01 Head
WP 01-2.2 HP



25000/-

HPP-02 Head
WP 02- 4 HP



29000/-

HPP-03 Head
WP 03-7.5 HP



8800/-

Copper Winding
V2S-01



7200/-

Aluminium Winding
V2S-02



1110/-

V2S HEAD

Model No.	Motor	Power	Max. Pressure	Voltage	Speed	Flow Rate	Weight
HPP 01	2.2 HP	1650 W	100 bar	220 V	2800 rpm	8 L/min	32 Kg
HPP 02	4 HP	2250 W	120 bar	380 V	1450 rpm	15 L/min	56 Kg
HPP 03	7.5 HP	4100 W	210 bar	380 V	1450 rpm	15 L/min	66.5 Kg
WP 01	2.2 HP	1650 W	100 bar	220 V	2800 rpm	8 L/min	5 Kg
WP 02	4 HP	2250 W	120 bar	380 V	1450 rpm	15 L/min	7.5 Kg
WP 03	7.5 HP	4100 W	210 bar	380 V	1450 rpm	15 L/min	8.5 Kg
V2S-01	2 HP	1500 W	100 bar	220 V	2800 rpm	8 L/min	12 Kg
V2S-02	2 HP	1500 W	100-120 bar	220 V	2800 rpm	8 L/min	12 Kg

Note : We Shall Not Be Responsible For Any Breakage/Damage In Transit. However, All Spare Parts Remain Available At Extra Cost.

Oil : 15W-40

All Spare Parts Available

E-18

35/-



F-01
FILTER

45/-



OC-01
OUTLET CONNECTOR

35/-



IC-01
INLET CONNECTOR

90/-



PCG-11 T
NOZZLE

N T

1/4"x12mm - 140/-
M14x12mm - 140/-
3/8"x15mm - 300/-
M22x15mm - 300/-



C-01,02,03,04
COUPLER

M22x1/2" - 140/-
M22x3/8" - 140/-
M22xM22 - 140/-



HU-01,02,03
HOSE UNION

N T

1/4"x12mm - 115/-
3/8"x12mm - 170/-
3/8"x15mm - 200/-
1/2"x15mm - 200/-
M22x15mm - 200/-



CPM-01,02,03,04,05
COUPLER PIN MALE

N T

1/4"x12mm - 115/-
3/8"x15mm - 200/-
1/2"x15mm - 200/-
M22x15mm - 200/-



CPF-01,02,03,04
COUPLER PIN FEMALE

7 Mtr. - 950/-
10 Mtr. - 1285/-
15 Mtr. - 1875/-
20 Mtr. - 2450/-



V2S-RH01,02,03,04
RUBBER HOSE

10 Mtr. 2600/-
15 Mtr. 3400/-
20 Mtr. 4500/-



22mm Connector

HPP 01- RH01,02,03
RUBBER HOSE

10 Mtr. 3000/-
15 Mtr. 4500/-
20 Mtr. 6000/-



22mm Connector

HPP 02- RH01,02,03
RUBBER HOSE

10 Mtr. 3500/-
15 Mtr. 5000/-
20 Mtr. 7000/-



22mm Connector

HPP 03- RH01,02,03
RUBBER HOSE



8500/-

20 LTR. VACUUM CLEANER

VC-20



9000/-

35 LTR. VACUUM CLEANER

VC-35



26500/-

80 LTR. VACUUM CLEANER

VC-80



3100/-

VM-1500



WITH GUN
FTG-01
FT-25



WITH GUN
FTG-02
FT-26



3500/-

6" AIR PALM SANDER

AT-991LA



1000/-

NRV - 3/4"



AC-4010-04 1/2" - 2550/-
AC-2010-02 1/4" - 1200/-
AF-4000-04 1/2" - 800/-
AF-2000-02 1/4" - 400/-
AR-4000-04 1/2" - 1150/-
AR-2000-02 1/4" - 550/-
AW-4000-04 1/2" - 1800/-
AW-2000-02 1/4" - 825/-

FRL

Model No.	Capacity	Power	Air Flow Rate	Vacuum Suction	Voltage	Length of Cable	Weight	Std. Packing
VC-20	20 Ltr.	1500 W	53 L/s	200 mbar	220-240 V	5 Mtr.	10.65 Kg	1 Pc.
VC-35	35 Ltr.	1500 W	53 L/s	200 mbar	220-240 V	5 Mtr.	11.95 Kg	1 Pc.
VC-80	80 Ltr.	4500 W	120 L/s	200 mbar	220-240 V	5 Mtr.	27.10 Kg	1 Pc.
Model No.	Air Inlet	Air Pressure	Thickness	Weight	Std. Packing			
FT-25	1/4"	1-2 bar	1.2 mm	14.250 kg	1 Pc.			
FT-26	1/4"	1-2 bar	1.5 mm	18 kg	1 Pc.			

Note : We Shall Not Be Responsible For Any Breakage/Damage In Transit. However, All Spare Parts Remain Available At Extra Cost.

All Spare Parts Available

E-20



DOUBLE RUBBER



SUPER D COPPER



5 Layer
8.5 mm



10 mm



13 mm

Note : Welding Cable Available in ISI Marka Also.

Model No.	Gauge	Description	Sq./mm	Wire	Rode Size	Amp.
WC-25 P	38	Popular	25	300	12-10	200
WC-35 P	38	Popular	35	500	12-10	300
WC-50 P	38	Popular	50	700	12-8	400
WC-70 P	38	Popular	70	1000	12-8	500
WC-25 D	36	Deluxe	25	300	12-8	300
WC-35 D	36	Deluxe	35	500	12-8	400
WC-50 D	36	Deluxe	50	700	12-8	500
WC-70 D	36	Deluxe	70	1000	12-8	600

Price Available Against Orders

Model No.	Size	Working Pressure	Layer	Weight	Std. Packing	Price
HPH-8.5	8.5 mm / 13 mm	300 kg / cm ²	5 Layer	14 Kg	200 Mtr.	65/-
HPH-10	10 mm / 16 mm	300 kg / cm ²	5 Layer	17 Kg	200 Mtr.	82/-
HPH-13	13 mm / 19 mm	300 kg / cm ²	5 Layer	22 Kg	100 Mtr.	130/-

Note : Price can be changed without Prior Notice.

OTHER BRAND

PNEUMATIC TOOLS



1/2" Impact Wrench Kit
AT-5004 SG



1/2" Impact Wrench
AT-5040 B



1/2" Air Ratchet Wrench
AT-5059



4" Air Angle Grinder
AT-282



1/4" Mini Air Die Grinder
AT-7032 B



1/4" Mini Air Die Grinder
AT-7032 BK



3/16" Hydraulic Riveter Kit
AT-6015 SG



10 mm Air Belt Sander
AT-480 SG



1/4" Air Screwdriver
AT-W5



Air Stapler
AT-8016



Air Nailer
F-30



Air Nailer
F-50

Price Available Against Orders

Painter

ΕΛΕΦΑΝΤ

This Cancels All Our Previous Price Lists



Scan the QR Code
to download PDF

TERMS & CONDITION

Discounts	As applicable
Taxes	Extra as applicable
Freight	Extra as applicable
Insurance	Extra as applicable