

# Crosby® Wide Body Shackles & Vertical Clamps



- Forged alloy steel from 7 through 300 metric tons. Cast alloy steel from 400 through 1550 metric tons.
- Sizes 300 metric tons and smaller are proof tested to 2 times the Working Load Limit.
- Sizes 400 metric tons and larger are tested to 1.33 times Working Load Limit.
- Shackles, 30t and larger, are RFID EQUIPPED.
- Can be used to connect HIGH STRENGTH Synthetic Web Slings, HIGH STRENGTH Synthetic Round Slings or Wire Rope Slings.
- Increase in shackle bow radius provides minimum 58% gain in sling bearing surface and eliminates need for a thimble.
- Increases usable sling strength minimum of 15%.
- Pin is non-rotating, with weld-on handles for easier use (75t and larger).

- Approved for use at -40 degree C (-40 degree F) to 204 degree C (400 degree F).
- Bow and bolt are Certified to meet Charpy impact testing of 42 joules (31 ft-lbs.) min. ave. at -20 degree C (-4 degree F).
- Shackles requiring ABS, Lloyds and other certifications are available upon special request and must be specified at time of order.
- Shackles 18t and larger have DNV Type Approval to Rules for Certification of Lifting Appliances and are produced in accordance with DNV MSA requirements. Databook is provided that includes required documents.
  - Serialization / Identification
  - Material Testing (Physical / Chemical / Charpy)
  - Proof Testing



## G-2160 Crosby® "Wide Body" Shackles

Working Load Limit (t)*	Stock No.		Weight Each (kg)	Dimensions (mm)												
	G-2160	S-2160		A	B +/- 6.35	C	D +/- .5	E	G	H	J	K	P	R	Effective Body Diameter	
7	1021256	1021548	1.81	105	31.8	17.5	22.4	46.2	31.8	90.4	40.6	31.8	104	149	53.3	
12.5	1021265	1021557	4.54	137	42.9	23.4	28.7	60.5	34.8	118	54.1	41.4	140	194	61.0	
18	1021274	1021566	6.80	170	51.6	29.5	35.1	68.3	38.1	148	63.5	50.8	172	238	71.1	
30	1021283	1021575	11.34	195	60.2	35.1	41.4	88.9	63.5	176	79.5	63.5	216	289	104	
40	1021285	1021584	20.9	236	73.2	42.9	50.8	102	44.4	205	95.3	76.2	270	346	91.4	
55	1021287	1021593	32.21	263	82.6	50.8	57.2	118	66.8	238	114	88.9	311	397	109	
75	1021290	-	45	365	105	53.8	69.9	127	89.0	293	121	92.5	312	468	125	
400	1021334	-	500	772	220	131	160	320	203	575	320	185	690	985	363	
500	1021343	-	650	849	250	146	180	340	205	630	340	225	790	1085	376	
600	1021352	-	860	916	275	158	200	394	330	700	370	247	865	1200	516	
700	1021361	-	1109	990	300	167	215	433	223	735	400	270	940	1275	422	
800	1021254	-	1368	1059	325	185	230	449	248	750	420	277	975	1323	457	
900	1021389	-	1559	1112	350	198	250	478	330	757	440	293	1025	1387	569	
1000	1021370	-	1824	1169	380	212	270	508	261	760	460	308	1075	1405	490	
1250	1021272	-	2598	1278	432	233	300	573	354	1006	530	323	1175	1660	620	
1550	1021281	-	3650	1588	465	282	320	616	318	1075	580	338	1316	1896	693	

## Universal - For Lifting in any Direction

- Available in capacities of .5 thru 30 metric tons (Higher Working Load Limits are available upon request).
- Wide variety of jaw openings available: 0 to 155mm.
- Welded alloy steel body for strength and smaller size. Forged alloy components, where required.
- Individually Proof Tested to 2 times the Working Load Limit with certification.
- Full 180° turning range for material transfer, turning or moving.
  - Lock open, lock closed ability with latch for pretension on material and then release of material.
  - Optional IP-5000 Stinger assembly available (see page 420). Allows for easy connection between the clamp and hoist hook.
  - Minimum WLL of 10% of Maximum WLL.
  - Maintenance replacement kits are available.
  - Manufactured by a ISO 9001 facility.
  - All sizes are RFID EQUIPPED.



## Model IPU10

Model	Working Load Limit (t)*	IPU10 Stock No.	Weight Each (kg.)	Dimensions (mm)										
				Jaw A	B	C	D	E	F	G	H	J	K	
IPU10	0.5	2701675	1.9	0 - 16	44	128	228	40	115	41	28	-	-	11
IPU10	1	2701663	2.4	0 - 20	45	139	222	40	126	41	38	-	-	11
IPU10	2	2701677	8.5	0 - 35	78	201	372	70	190	61	55	-	-	16
IPU10	3	2701665	14.8	0 - 40	100	253	445	75	225	78	60	-	-	20
IPU10	4.5	2701667	16.0	0 - 40	100	253	445	75	232	82	65	-	-	20
IPU10	6	2701669	24.0	0 - 50	126	302	525	80	292	84	95	44	20	20
IPU10/J	6	2702469	30.5	50 - 100	126	302	525	80	342	84	95	44	20	20
IPU10	9	2701671	29.5	0 - 50	126	325	557	80	310	92	105	44	20	20
IPU10/J	9	2701673	30.5	50 - 100	126	325	562	80	360	92	105	44	20	20
IPU10	12	2701679	57.0	0 - 54	160	391	623	80	331	117	137	41	25	25
IPU10/J	12	2701681	59.0	54 - 108	178	439	673	80	415	117	137	41	25	25
IPU10	16	2701683	72.0	5 - 64	178	465	734	88	397	119	153	45	25	25
IPU10/J	16	2701685	85.0	64 - 128	208	521	790	88	472	119	161	45	25	25
IPU10	22.5	2701687	127	5 - 80	222	554	855	110	470	136	186	49	25	25
IPU10/J	22.5	2701689	130	80 - 155	253	628	930	110	575	136	196	49	25	25
IPU10	30	2701691	153	5 - 80	222	545	860	110	470	152	186	54	30	30
IPU10/J	30	2701693	165	80 - 155	250	620	935	110	565	152	196	54	30	30

\*Design Factor based on EN 13155 and ASME B30.20.



# CY 'HINGED' VERTICAL PLATE CLAMPS

The CY plate clamps with hinged hook rings can be used for the safe handling of plate at various angles. It can lift plate from the horizontal and put down in the vertical. The hinged hook ring ensures adequate gripping pressure in every position, but the load capacity is reduced as seen in the diagram below showing the load / force capacities.

The main benefit of the CY hinged plate clamps is that longer plates can be lifted or handled, using two clamps on a two legged chain sling (as shown in illustration), thus eliminating the need for a spreader beam.

NB: The plate surface of the material must have a hardness level below HRC 30/Brinell 300.

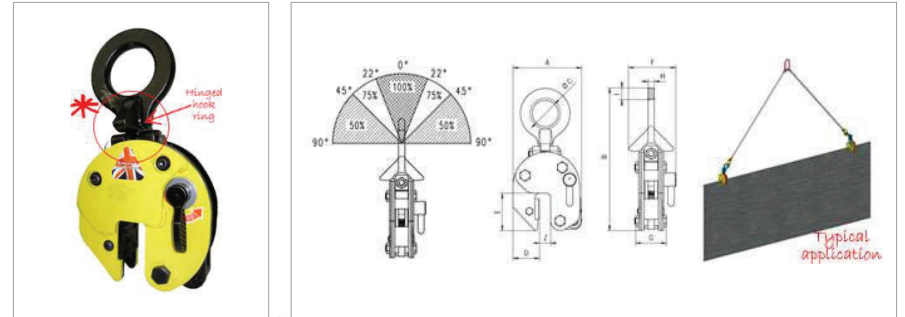

Model	WLL Kg*	Jaw (Z) Capacity mm	A	B	C	D	E	F	G	H	HI	Weight Kgs**
Cyl	200-1000	0-20	126	270	50	49	70	95	95	12	23	4.6
Cyl	400-2000	0-32	192	382	80	75	96	132	92	20	30	14
Cyl	600-3000	0-32	192	382	80	75	96	132	92	20	30	14

\*Per clamp \*\*Weight per clamp with hook ring.

## TPM PERMANENT LIFTING MAGNETS

TPM permanent lifting magnets are ideal tools for easy, quick and economical transport of heavy objects made from ferro-magnetic material. Typical operating areas are workshops and warehouses, loading and unloading of machines as well as construction of jigs and fixtures.

Model	Flat material		Round material		Dimensions					Weight Kgs		
	Maximum capacity SWL kgs**	Minimum thickness to obtain max. SWL mm**	Maximum length of material mm	Maximum capacity SWL kgs**	Diameter mm	Maximum length of material mm	Tear off force kgs	A	B		C	D
TPM 1	100	15	2000	50	200-300	2000	300	122	69	185	160	6
TPM 3	300	19	2500	150	200-300	2500	900	192	95	225	250	15.5
TPM 5	500	25	3000	250	200-300	3000	1500	232	120	270	250	29.5
TPM 8	800	35	3500	400	200-300	3500	2400	302	154	320	450	53
TPM 10	1000	40	3500	500	200-300	3500	3000	332	154	320	450	60



\*\*Maximum lifting capacity is achieved by using mild steels with the noted minimum thickness. Mild steel st37 - Fe 360 to BS EN 10 025 1990 (DIN 17100).



## 92 Series Vertical Plate Clamps

**Camlok**  
Lifting Clamps

- Standard plate clamps with safety lock Working load limit (WLL) 500 - 3000kgs
- These clamps are primarily used for transporting sheet metal and steel plates in the vertical position, as well as lifting and rotating through 1800.
- They can also be used for transporting steel constructions and profiles.
- It is recommended to use a pair of plate clamps in conjunction with a spreader beam for long materials which have a tendency to sag or flex.

### Function

- The jaw is opened and closed with the locking lever except for the 92-500 which uses a positive spring-loaded cam.
- The safety lock spring loads the cam jaw, preventing the clamp from opening even when there is no load.

### Workmanship and parts

- These plate clamps are service-friendly, making it easy to exchange parts, which are readily available. Clamp repairs are available through the factory, or can be done by a competent person.
- The 92-500 is equipped with positive spring-loaded cam, but comes without locking lever.

**NB:** The plate surface of the material must have a hardness level below HRC 30/Brinell 300.

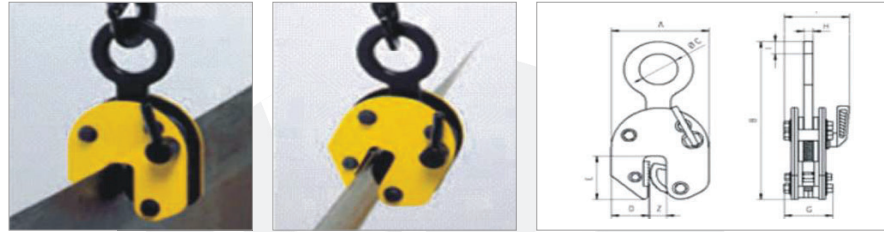

### 92 Series plate clamps

Working load limit 500 - 300kgs

Model	WLL (Kgs)	JAW (Z) Capacity mm	A mm	B mm	C mm	D mm	E mm	F mm	G mm	H mm	I mm	Weight (Kgs)
92-500	50-500	0-16	99	195	29	33	47	50	48	11	15	1.5
92-1500	150-1500	0-20	126	225	50	49	70	82	55	13	20	3.0
92-2000	200-2000	0-32	192	312	80	75	96	100	81	20	24	8
92-3000	300-3000	0-32	192	320	80	75	96	100	81	30	30	12

**PLEASE NOTE:** Units are supplied as standard with a hook ring fitting and chain available on request as a special order.

\*Per clamp \*\*Weight per clamp with hook ring.

## CX 'HINGED' Vertical Plate Clamps

**Camlok**  
Lifting Clamps

### Heavy duty - side loading

- The CX plate clamps shares all the benefits of the CY clamps, but are specifically designed for more heavy duty applications.
- The other benefit that the CX clamps offers over the CY clamps is that vertically racked plates can be turned through 90 (as shown in illustration).
- NB: The plate surface of the material must have a hardness level below HRC 30/Brinell 300.

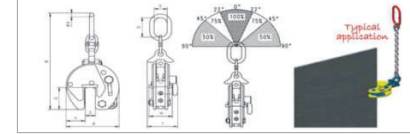

### CX 'HINGED' VERTICAL PLATE CLAMPS

Model	WLL (Kgs)	JAW (Z) Capacity mm	A mm	B mm	C mm	D mm	E mm	F mm	G mm	H mm	I mm	Weight (Kgs)
CX 1500	225-1500	0-20	140	399	63	125	12.5	48	70	57	83	7
CX 3000	450-3000	0-32	197	515	67	138	19	68	93	81	110	12
CX 3000L	450-3000	30-60	227	515	67	138	19	68	93	81	110	15
CX 6000	1200-6000	0-50	292	737	95	176	28	95	143	137	188	38
CX 6000L	1200-6000	50-100	367	785	98	180	28	115	143	135	188	48
CX 8000	1600-8000	0-50	292	737	98	176	28	95	143	136	210	39
CX 8000L	1600-8000	50-100	367	785	98	180	28	115	143	136	210	51
CX 10000	2000-10000	0-50	360	903	110	195	33	125	162	170	223	61
CX 10000L	2000-10000	50-100	446	921	112	195	33	168	162	170	223	76

\*Per clamp. \*\*Weight per clamp with hook ring.

## HG Vertical 'HIGH GRIP' Plate Clamps

Model	WLL (Kgs)	JAW (Z) Capacity mm	A mm	B mm	C mm	D mm	E mm	F mm	G mm	Weight (Kgs)
HG 500	25-500	0-10	42	230	148	10	55	79	50	5
HG 1000	50-1000	0-16	93	297	210	16	75	114	67	12
HG 2000	200-2000	0-20	110	416	305	20	102	159	80	22
HG 3000	300-3000	0-20	110	416	305	20	102	159	80	27
HG 4000	400-4000	0-20	120	335	305	20	102	159	80	32

\*Per clamp. \*\*Weight per clamp with hook ring.

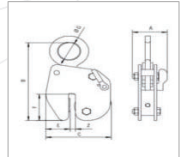

## CZ 'HEAVY DUTY' Plate Clamps



### Working load limit (WLL) 1000 - 3000kgs

- These clamps are primarily used for transporting sheet metal and steel plates in the vertical position, as well as lifting and rotating through 180°
- They can also be used for transporting steel constructions and profiles. It is recommended to use a pair of plate clamps in conjunction with a spreader beam for long materials which have a tendency to sag or flex

### Function

- The jaw is opened and closed with the locking lever. The safety lock spring loads the cam jaw, preventing the clamp from opening even when there is no load.
- Workmanship and parts
- These plate clamps are service-friendly, making it easy to exchange parts, which are readily available. Clamp repairs are available through the factory, or can be done by a competent person.
- NB: The plate surface of the material must have a hardness level below HRC 30/Brinell 300

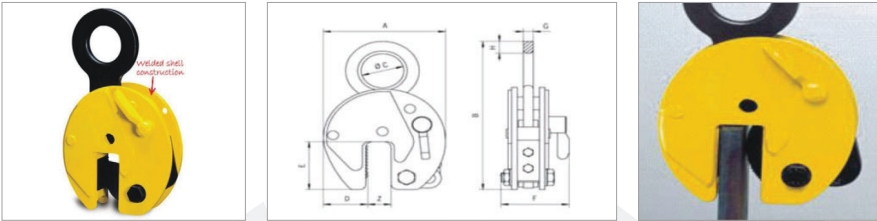

Model	WLL (Kgs)	JAW (Z) Capacity mm	A mm	B mm	C mm	D mm	E mm	F mm	G mm	H mm	Weight (Kgs)
CZ 1	100-1000	0-20	140	254	51	48	70	83	13	19	4
CZ 1L	100-1000	20-40	161	260	51	48	70	83	20	19	5
CZ 2	200-2000	0-32	197	323	67	68	93	110	20	20	11
CZ 2L	200-2000	30-60	228	330	67	68	93	110	20	20	13
CZ 3	300-3000	0-32	197	371	80	68	93	110	20	30	12
CZ 3L	300-3000	30-60	228	390	80	68	93	110	20	30	15
CZ 4	480-4000	0-32	197	371	80	68	93	129	20	30	12
CZ 4L	480-4000	30-60	228	390	80	68	93	129	20	30	18
CZ 6	720-6000	0-50	293	484	89	95	143	129	25	35	21
CZ 6L	720-6000	50-100	362	524	89	95	143	129	25	35	28
CZ 8	960-8000	0-50	293	492	89	95	143	129	25	42	26
CZ 8L	960-8000	50-100	362	524	89	114	143	129	25	42	32
CZ 10	1500-10000	0-50	293	545	110	95	143	139	25	45	30
CZ 10L	1500-10000	50-100	362	545	110	114	143	139	25	45	37
CZ 12	1800-12000	0-50	360	613	130	125	162	154	30	55	54
CZ 12L	1800-12000	50-100	460	678	130	175	162	154	30	55	63
CZ 15	3000-15000	0-50	360	613	130	125	162	204	45	55	75
CZ 15L	3000-15000	50-100	460	678	130	175	162	204	45	55	88
CZ 20	4000-20000	0-65	462	755	130	165	210	235	45	65	123
CZ 20L	4000-20000	65-130	560	805	130	195	210	235	45	65	136
CZ 30	6000-30000	0-65	462	732	60	165	210	295	65	-	195
CZ 30L	6000-30000	65-130	560	797	60	195	210	295	65	-	295

PLEASE NOTE: Units are supplied as standard with a hook ring. Link fitting and chain are available on request as a special order. Also available with 'Sharp Leg' body shell or extra thick shell plates for dragging. Please contact sales team for details and prices.  
\*Per clamp. \*\*Weight per clamp with hook ring.

## LJ 'NON-MARKING' Plate Clamps

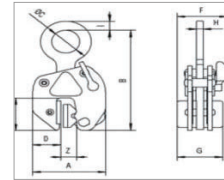

Model	WLL (Kgs*)	Jaw Capacity mm	A mm	B mm	C mm	D mm	E mm	F mm	G mm	H mm	I mm	Weight (Kgs**)
LJ 500	25-500	0 - 10	127	200	55	52	69	86.5	76	13	20	3.5
LJ 1500	180-1500	0 - 20	215	345	85	75	135	131	118	20	24	12

\*Per clamp. \*\*Weight per clamp with hook ring.



## CLT/CLB CLT for top lifting CLB for side lifting

- Working load limit (WLL) 32000 - 56000kgs
- These container lifting lugs are supplied in sets of 4 and are available in with a total lifting capacity of up to 56 tonnes. The CLT and CLB lugs serve as flexible lashing points for the transportation of containers.
- Two types are available dependant on if you want to fasten them to the top or the side of the container:
- The CLT type is vertically mounted in the hole at the top of the container and is locked into place by simply turning the lug 90°. This configuration allows for transportation via the use of a lifting frame in conjunction with cables, chains or slings.
- The CLB model is mounted horizontally to the side of the container at either the top or the bottom fixing holes. This model has a spring loaded bolt to prevent accidental release.

Model	WLL (Kgs)	Type of Lifting	Top Angle Between Chains	A mm	B mm	C mm	D mm	E mm	F mm	G mm	Weight (Kgs)
CLB	32000	Side	50°	152	181	45	37	73	75	40	18
	40000		36°								
	50000		Vertical								
CLT	56000	Top	Vertical	123	217	45	39	57	101	121	28

\*Per clamp. \*\*Weight per clamp with hook ring.

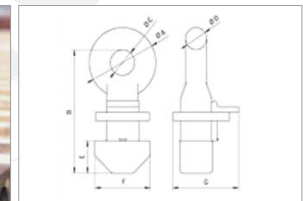
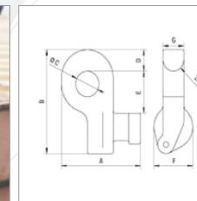

# CH/HH 'INDUSTRY STANDARD', Horizontal Plate Clamps



## Working load limit (WLL) 1000 - 10000kgs

- The CH horizontal plate clamps have been specifically designed to be used, in pairs, for the transportation of plate bundles as well as single plates with a minimum thickness of 5mm.
- A pair of clamps used with a two legged chain sling are suitable for small plates. It is recommended to use two pairs in conjunction with a spreader beam for handling of larger plates. These units are supplied as standard with a smooth jaw. There is also the option of hardened steel teeth for special applications. Please contact our technical department for further details.
- The HH horizontal plate clamps incorporate all of the features of the CH clamps, yet are manufactured from high strength steel giving them exceptionally low tare weights.
- Workmanship and parts
- These plate clamps are service-friendly, making it easy to exchange parts, which are readily available. Clamp repairs are available through the factory, or can be done by a competent person.

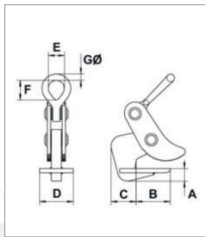
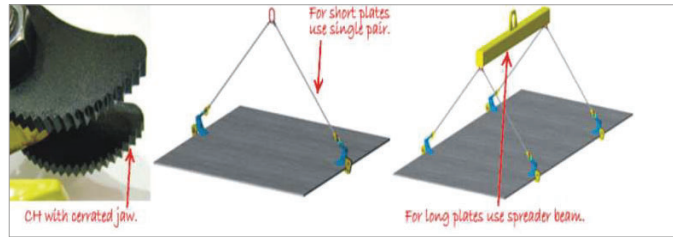

Model	WLL (Kgs)	JAW Capacity mm	A mm	B mm	C mm	D mm	E mm	F mm	G mm	Weight (Kgs)
CH 1	1000	5-32	15	82	60	100	32	44	13	8
CH 2	2000	5-32	30	82	60	100	50	73	18	11
CH 2L	2000	20-50	30	82	60	100	50	73	18	12
CH 4	4000	5-50	40	112	80	100	64	92	25	17
CH 4L	4000	50-100	40	112	80	100	64	92	25	23
CH 6	6000	5-75	55	172	100	130	90	130	35	46
CH 6L	6000	50-125	55	172	100	130	90	130	35	56
CH 8	8000	5-75	55	172	105	130	90	130	35	53
CH 8L	8000	50-125	55	172	105	130	90	130	35	60
CH 10	10000	5-100	65	215	120	150	114	114	35	95
CH 10L	10000	50-150	65	215	120	150	114	114	35	108
HH 8	8000	5-50	55	168	105	130	67	67	24	21
HH 8L	8000	50-100	55	168	105	130	67	67	24	28

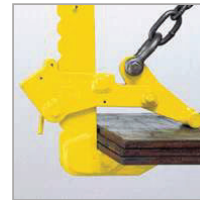

ACH 'Adjustable' Horizontal Plate Clamps



RH/WH/WHL/WHP Horizontal Plate Clamps



SC92 Beam Clamps With Shackle



CR Single Rail Clamps

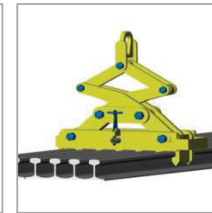

GRAB MRC Interchangeable Multi Rail Grabs

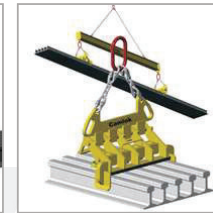

MR Fixed Multi Rail



PH Pipe Hooks



CP Pile Pitching Clamps



TRU Tru Round Stock Grabs



DC500 Drum Clamps

DBT Drum Clamps



DT Horizontal Lifting Drum Tongs



TKG-VHS Crane Forks - Automatic



The MAGNETIC CLAWS



SB Spreader Beams