



Empowering SMEs & MSMEs, Empowering Growth

sme@sme.supply

+91 7506991063

S.S. 304/316

Effective date - 12/12/2024

STAINLESS STEEL 304-A2 HEX SCREW FULL THREAD (DIN 933 / IS 1363)

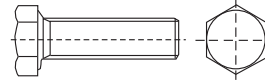

TABLE - 1A

DIA	10	12	16	20	25	30	35	40	45	50	55	60	65	70	75	80	85	90	100
3	178	195	204	226	258	415	500	621	706	722	-	-	-	-	-	-	-	-	-
4	219	225	244	269	302	362	422	589	632	657	717	757	802	848	898	950	1002	1054	1160
5	297	315	337	377	424	485	567	678	743	793	1495	1685	1886	1977	2088	2268	2463	2624	2991
6	408	428	470	512	583	659	721	789	864	920	1082	1132	1236	1294	1439	1492	1672	1707	1904
8	-	-	934	1025	1151	1308	1409	1527	1700	1797	1956	2041	2225	2290	2398	2690	2838	2970	3255
10	-	-	1813	1867	2061	2230	2459	2659	2879	3102	3311	3515	3784	3895	4186	4369	4697	4809	5148
12	-	-	-	2878	3045	3257	3584	3940	4202	4527	4766	5050	5318	5585	5903	6180	6542	6823	7391
14	-	-	-	-	5369	5684	6107	6445	6910	7301	7829	8087	8692	9016	9448	9903	10777	11321	11655
16	-	-	-	-	6593	6752	7273	7798	8294	8846	9380	9968	10358	10646	11256	11987	12466	13088	14247
18	-	-	-	-	-	-	-	12036	12956	13460	14575	15143	16083	16657	17600	18290	19037	19638	20729
20	-	-	-	-	-	-	-	13558	14575	15313	15910	16760	17743	18763	19480	20405	21384	22346	24068
22	-	-	-	-	-	-	-	-	-	25117	26507	27880	29203	30657	31907	33263	34597	34857	37526
24	-	-	-	-	-	-	-	-	-	26346	27805	29245	30633	32158	33469	34891	36291	36563	39363

STAINLESS STEEL 304-A2 HEX SCREW FULL THREAD (BS - 1083)

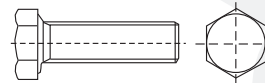

TABLE - 1B

BSW	1/2"	3/4"	1"	1.1/4"	1.1/2"	2"	2.1/2"	3"	3.1/2"	4"	5"	6"	7"	8"
1/8"	265	285	305	525	653	729	-	-	-	-	-	-	-	-
3/16"	283	327	370	446	580	721	1062	1276	-	-	-	-	-	-
1/4"	547	627	724	822	930	1129	1455	1686	1827	2077	-	-	-	-
5/16"	970	1103	1266	1424	1590	1904	2236	2568	3027	3559	4317	-	-	-
3/8"	1509	1714	1936	2177	2419	2894	3365	3843	4311	4793	6386	7758	-	-
7/16"	-	-	3549	3937	4275	4973	5715	6459	7187	7884	9443	10842	-	-
1/2"	-	-	4081	4528	4917	5719	6573	7428	8265	9066	10859	12468	18469	22263
5/8"	-	-	7589	7732	8357	9725	10888	12848	13476	14699	18329	21118	26198	29639
3/4"	-	-	-	-	15684	17298	19403	21534	23644	25853	34237	39128	42680	65231
7/8"	-	-	-	-	-	25759	29547	32827	36470	40038	49782	57405	64400	71906
1"	-	-	-	-	-	37276	41912	46481	50993	56640	69526	79766	90005	100245

STAINLESS STEEL 304-A2 HEX NUT (DIN 934 / IS 1363)

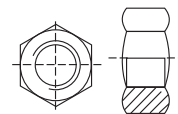

TABLE - 1C

SIZE	M 2	M 2.5	M 3	M 4	M 5	M 6	M 8	M 10	M 12	M 14	M 16	M 18	M 20	M 22	M 24	M 27	M 30	M 33	M 36
304	149	181	90	108	127	215	424	954	1416	2312	2929	5628	5628	9530	9530	21858	32625	45815	52299

STAINLESS STEEL 304-A2 HEX NUT (BS 1083)

TABLE - 1D

BSW	1/8"	5/32"	3/16"	1/4"	5/16"	3/8"	7/16"	1/2"	5/8"	3/4"	7/8"	1"
304	144	151	167	332	468	816	1742	2004	3807	7559	9956	15334

STAINLESS STEEL 304-A2 LONG LENGTH HEX SCREW (DIN 933 / IS 1363)

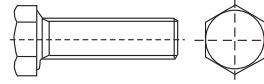
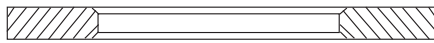

TABLE - 2A

DIA	110	120	125	130	140	150	160	170	175	180	190	200
6	3207	3613	3530	3710	4032	4279	-	-	-	-	-	-
8	3623	3892	4034	4240	4608	4887	8800	11117	11367	11833	13046	13626
10	5784	6371	6648	6823	7248	8046	9778	12352	12630	13148	14495	15140
12	8123	8816	9273	9776	10301	11116	11871	18070	18903	19735	21674	23612
14	14506	15683	16207	16689	17752	19091	20512	23340	24471	25601	26764	27927
16	15473	16729	17287	17802	18935	20364	21879	24896	26102	27308	28549	29789
18	25598	27203	28036	29023	30756	32579	34060	35837	36652	37466	46736	56007
20	27104	28803	29685	30730	32565	34495	36063	37945	38808	39670	49486	59301
22	41530	44298	45704	47203	49931	52671	56201	58841	60291	61742	64592	67441
24	45305	48325	49859	51494	54470	57459	61310	64190	65773	67355	70464	73572

STAINLESS STEEL 304-A2 PLAIN WASHER (DIN 125 / IS 2016)

TABLE - 2B



THICK	1.2MM	1.6MM	2MM	2.5MM	3MM	IS
M3 (1/8")	90	-	-	-	-	90
M4 (5/32")	100	-	-	-	-	100
M5 (3/16")	120	170	-	-	-	120
M6 (1/4")	172	250	340	-	-	250
M8 (5/16")	225	300	365	-	700	300
M10 (3/8")	350	465	600	-	1100	600
M12 (1/2")	460	640	835	1240	1450	1200
M14 (9/16")	547	850	1050	1500	1750	1750
M16 (5/8")	700	980	1225	-	2000	2000
M18	1000	1175	1600	-	2500	2500
M20 (3/4")	1100	1425	1700	-	2800	2800
M22 (7/8")	1400	1600	2000	-	3250	3250
M24 (1")	1560	1900	2500	-	4300	6000
M27 (1.1/8")	-	-	-	-	4800	6650
M30 (1.1/4")	-	-	-	-	6350	8700
M33 (1.3/8")	-	-	-	-	8500	12000
M36 (1.1/2")	-	-	-	-	8850	14600

STAINLESS STEEL 304-A2 SPRING WASHER (DIN 127 / IS 3063)

TABLE - 2C

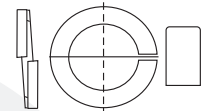

BSW	SQUARE	FLAT
M3 (1/8")	80	120
M4 (5/32")	90	130
M5 (3/16")	100	156
M6 (1/4")	125	250
M8 (5/16")	180	325
M10 (3/8")	300	500
M12 (1/2")	500	750
M14 (9/16")	800	1400
M16 (5/8")	1050	1650
M18	1400	2250
M20 (3/4")	1900	2875
M22 (7/8")	2500	4000
M24 (1")	3920	5250
M27 (1.1/8")	4200	6000
M30 (1.1/4")	5800	7500
M33 (1.3/8")	9800	12800
M36 (1.1/2")	11900	14600

STAINLESS STEEL 304-A2 THREADED ROD 1 MTR LENGTH (DIN 975)

TABLE - 2D

SIZE	M 5	M 6	M 8	M 10	M 12	M 14	M 16	M 20	M22	M24				
304	14004	15275	26114	40913	59657	82882	108901	174273	217040	259260				

STAINLESS STEEL 304-A2 THREADED ROD 1 MTR LENGTH (BS 1083 / ANSI B18.2.1)

TABLE - 2E

SIZE	3/16"	1/4"	5/16"	3/8"	1/2"	5/8"	3/4"	7/8"	1"
304	21000	16573	24061	37100	64307	105890	159000	215769	285153

**STAINLESS STEEL 304-A2 CHEESE HEAD (DIN 84) /
ROUND HEAD SLOTTED SCREW (DIN 85)**

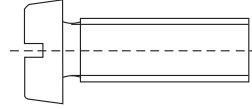

TABLE - 3A

DIA	4	6	8	10	12	16	20	25	30	35	40	50	60	70	80	90	100
2	154	148	148	154	160	190	225	-	-	-	-	-	-	-	-	-	-
2.5	160	154	163	179	190	217	258	359	-	-	-	-	-	-	-	-	-
3	-	163	160	171	186	216	273	341	498	641	625	892	-	-	-	-	-
4	-	235	242	254	276	314	360	426	497	556	651	806	-	-	-	-	-
5	-	348	362	385	430	479	541	627	714	808	924	1121	-	-	-	-	-
6	-	-	-	570	601	707	779	932	1042	1196	1329	1588	1894	2154	2438	2559	2876
8	-	-	-	-	-	1746	1975	2100	2375	2598	2927	3474	3620	4033	4425	4973	5562
10	-	-	-	-	-	-	3069	3439	3874	4306	4697	5497	6442	7425	8211	9116	9696

**STAINLESS STEEL 304-A2 CHEESE HEAD /
ROUND HEAD SLOTTED SCREW (BS 450)**

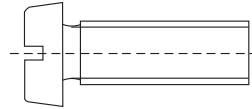

TABLE - 3B

BSW	1/4"	3/8"	1/2"	3/4"	1"	1.1/4"	1.1/2"	2"	2.1/2"	3"
1/8"	178	196	218	266	339	536	679	1020	-	-
5/32"	220	249	279	349	410	480	646	818	-	-
3/16"	278	339	391	483	590	695	806	1009	-	-
1/4"	-	658	712	872	1034	1230	1385	1766	2205	2577
5/16"	-	-	1580	1824	2080	2368	2679	3458	4161	4932
3/8"	-	-	2547	2801	3143	3885	4273	5252	6262	7728

**STAINLESS STEEL 304-A2 COUNTERSUNK (CSK)
SLOTTED HEAD SCREW (DIN 963)**

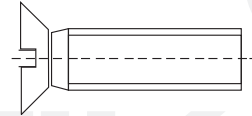

TABLE - 3C

DIA	4	6	8	10	12	16	20	25	30	35	40	50	60	70	80	90	100
2	156	147	147	155	158	188	226	-	-	-	-	-	-	-	-	-	-
2.5	158	155	164	178	188	226	259	299	-	-	-	-	-	-	-	-	-
3	-	146	136	153	175	192	279	318	472	614	-	-	-	-	-	-	-
4	-	191	193	212	221	264	318	378	445	492	605	826	-	-	-	-	-
5	-	256	262	284	315	377	449	532	632	732	841	1039	-	-	-	-	-
6	-	-	-	445	478	529	645	756	884	1027	1148	1435	1762	2038	2248	-	-
8	-	-	-	-	-	1454	1648	1863	2117	2363	2660	3269	3797	4323	4987	-	-
10	-	-	-	-	-	-	2543	2880	3324	3745	4198	5088	5830	7102	7958	9060	9774
12	-	-	-	-	-	-	4395	4682	5247	5627	6492	7786	8833	9297	10989	12260	13385

**STAINLESS STEEL 304-A2 COUNTERSUNK (CSK)
SLOTTED HEAD SCREW (BS 240)**

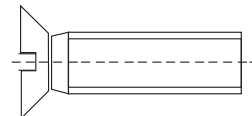

TABLE - 3D

BSW	1/4"	3/8"	1/2"	3/4"	1"	1.1/4"	1.1/2"	2"	2.1/2"	3"	3.1/2"	4"
1/8"	160	179	208	246	327	525	668	1009	-	-	-	-
5/32"	187	219	253	321	399	461	614	795	-	-	-	-
3/16"	-	268	305	398	535	673	778	970	-	-	-	-
1/4"	-	492	607	727	873	1066	1207	1597	2097	2468	-	-
5/16"	-	-	1438	1716	1955	2368	2679	3417	4161	4932	-	-
3/8"	-	-	2547	2510	2853	3512	3840	4824	5755	7392	-	-
1/2"	-	-	-	-	5454	6666	7603	9355	11123	12627	14618	19689

STAINLESS STEEL 304-A2 PAN PHILIPS M/C AS PER (DIN 7985)

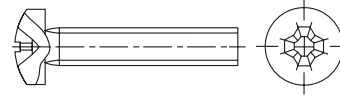

TABLE - 4A

DIA	4	6	8	10	12	16	20	25	30	35	40	50	60	70	80	90	100
2	132	126	126	132	137	163	193	-	-	-	-	-	-	-	-	-	-
2.5	137	132	139	153	163	186	221	307	-	-	-	-	-	-	-	-	-
3	-	124	120	133	148	168	214	268	399	516	501	723	-	-	-	-	-
4	-	191	207	210	228	252	292	357	417	461	553	688	-	-	-	-	-
5	-	293	288	311	339	376	451	515	600	683	778	923	-	-	-	-	-
6	-	-	-	438	481	535	628	727	839	1022	1085	1312	1627	1849	2098	2170	2446
8	-	-	-	-	-	1462	1643	1744	1973	2161	2432	2894	2974	3306	3618	4051	4546
10	-	-	-	-	-	-	2542	2837	3201	3561	3890	4564	5341	6206	6874	7638	8135

STAINLESS STEEL 304-A2 PAN PHILIPS M/C

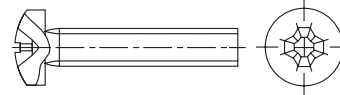

TABLE - 4B

BSW	1/4"	3/8"	1/2"	3/4"	1"	1.1/4"	1.1/2"	2"	2.1/2"	3"		
1/8"	139	152	168	203	260	420	535	809	-	-		
5/32"	182	205	228	283	332	388	529	673	-	-		
3/16"	224	276	318	391	478	565	655	821	-	-		
1/4"	-	531	571	697	824	984	1105	1415	1774	2076		
5/16"	-	-	1308	1497	1700	1930	2181	2828	3400	4039		
3/8"	-	-	2111	2293	2558	3190	3492	4290	5104	6371		

STAINLESS STEEL 304-A2 CSK PHILIPS M/C AS PER (DIN 965)

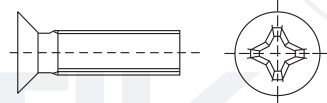

TABLE - 4C

DIA	4	6	8	10	12	16	20	25	30	35	40	50	60	70	80	90	100
2	134	126	126	132	135	161	194	-	-	-	-	-	-	-	-	-	-
2.5	135	132	140	153	161	193	221	256	-	-	-	-	-	-	-	-	-
3	-	118	105	117	127	147	193	245	375	497	-	-	-	-	-	-	-
4	-	163	165	169	182	214	257	318	375	415	510	641	-	-	-	-	-
5	-	214	218	220	240	298	356	436	508	587	692	857	-	-	-	-	-
6	-	-	-	374	386	439	510	602	722	838	935	1172	1437	1664	1834	-	-
8	-	-	-	-	-	1224	1376	1545	1755	1960	2203	2709	3145	3572	4135	-	-
10	-	-	-	-	-	-	2133	2403	2774	3125	3502	4246	4866	5954	6671	7596	8195
12	-	-	-	-	-	-	3680	3901	4335	4635	5353	6419	7258	7637	9028	10073	10991

STAINLESS STEEL 304-A2 CSK PHILIPS

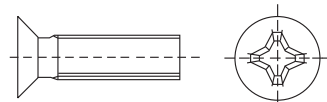

TABLE - 4D

BSW	1/4"	3/8"	1/2"	3/4"	1"	1.1/4"	1.1/2"	2"	2.1/2"	3"	3.1/2	4"
1/8"	124	137	157	184	244	403	516	788	-	-	-	-
5/32"	156	182	208	261	324	374	504	655	-	-	-	-
3/16"	192	222	252	326	436	547	634	790	-	-	-	-
1/4"	-	404	490	587	702	859	970	1286	1689	1989	-	-
5/16"	-	-	1200	1415	1605	1930	2181	2796	3400	4039	-	-
3/8"	-	-	2111	2072	2337	2906	3163	3964	4718	6114	-	-
1/2"	-	-	-	-	4496	5510	6282	7721	9164	10362	12027	13752

STAINLESS STEEL 304-A2 ALLEN CAP SCREW (DIN 912)

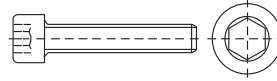

TABLE - 5A

DIA	6	8	10	12	16	20	25	30	35	40	45	50	60	70	75	80	90	100
3	353	341	348	356	396	437	504	666	-	-	-	-	-	-	-	-	-	-
4	418	396	363	372	427	477	513	622	698	847	1007	1167	1585	2107	2444	2781	3643	4735
5	-	460	473	499	558	623	697	803	917	1076	1191	1305	1603	1939	2133	2327	2792	3350
6	-	-	632	637	707	766	854	926	1022	1159	1270	1336	1696	1992	2235	2553	2913	3461
8	-	-	1618	1546	1370	1428	1579	1809	1974	2117	2307	2442	2925	3231	3828	4032	4737	5060
10	-	-	-	-	2796	2533	2834	2992	3317	3553	3802	4087	4613	5233	5540	5845	7186	7895
12	-	-	-	-	-	5078	4739	4797	5079	5461	5914	6242	7034	7509	8237	8866	9614	10571
14	-	-	-	-	-	-	9074	9178	9603	10030	10758	11324	12530	14114	15931	16335	18229	20089
16	-	-	-	-	-	-	-	11345	10369	11349	12294	12721	14217	15793	16778	17518	19240	21070
18	-	-	-	-	-	-	-	-	-	20779	21554	22756	25331	27738	29200	30432	32888	35789
20	-	-	-	-	-	-	-	-	-	21873	22688	23954	26664	29198	30737	32034	34619	37673
22	-	-	-	-	-	-	-	-	-	-	-	42985	47735	50755	54916	56946	61408	66847
24	-	-	-	-	-	-	-	-	-	-	-	54245	58786	63329	64639	67871	72414	76955

STAINLESS STEEL 304-A2 ALLEN CAP SCREW (BS 2470)

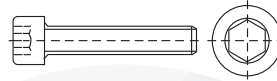

TABLE - 5B

BSW	1/2"	3/4"	1"	1.1/4"	1.1/2"	2"	2.1/2"	3"	3.1/2"	4"
3/16"	724	732	785	870	1013	-	-	-	-	-
1/4"	942	1006	1108	1244	1433	1734	2206	2835	3485	3925
5/16"	1587	1651	1716	1992	2179	2563	3340	3974	-	-
3/8"	-	2429	2518	2825	3199	3891	4706	5650	6456	7001
1/2"	-	-	-	6393	7021	7908	9242	10328	12569	14501
5/8"	-	-	-	-	12603	14452	17218	20414	23944	25467
3/4"	-	-	-	-	26089	28734	35020	36865	41526	45087

STAINLESS STEEL 304-A2 ALLEN CAP SCREW LONG LENGTH (DIN 912)



TABLE - 5C

DIA	110	120	125	130	140	150
8	5952	6414	7038	7459	11250	12966
10	9866	10624	11125	11308	13012	14715
12	14464	15467	16130	16401	18007	19190
14	25346	27156	29019	30883	32413	33943
16	27036	28966	30954	32942	34574	36206
18	41033	44200	45758	47365	50532	53700
20	45944	48416	49650	51492	53337	57471
22	74489	78588	79919	81866	85116	90122
24	86296	91106	90084	92462	97124	101767

STAINLESS STEEL 304-A2 LOCK NUT (DIN 439)



TABLE - 5D

SIZE	M 5	M 6	M 8	M 10	M 12	M 14	M 16	M 20	M 24	M 27	M 30	M 33	M 36		
304	135	176	333	678	992	1888	1991	4446	7912	18730	26855	35288	46187		

STAINLESS STEEL 304-A2 ALLEN CSK CAP SCREW (DIN 7991)

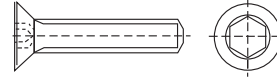

TABLE - 6A

DIA	6	8	10	12	16	20	25	30	35	40	50	60	70	80	90	100	
3	117	117	122	142	180	251	326	-	-	-	-	-	-	-	-	-	
4	164	164	179	183	216	270	313	370	425	500	-	-	-	-	-	-	
5	256	256	241	264	315	373	453	532	609	689	852	-	-	-	-	-	
6	-	-	390	410	476	558	657	775	873	990	1188	1442	1825	2411	2761	3364	
8	-	-	-	-	1008	1040	1263	1455	1677	1848	2177	2552	2870	3253	3822	4114	
10	-	-	-	-	-	2137	2273	2526	2728	3216	3596	4365	4803	5596	5936	6775	
12	-	-	-	-	-	-	5005	5336	5878	6056	6985	7775	8665	9348	10399	11527	
16	-	-	-	-	-	-	-	-	-	9915	11869	13822	15626	17578	19833	22086	
20	-	-	-	-	-	-	-	-	-	17656	24750	26829	31846	34616	39116	43788	

STAINLESS STEEL 304-A2 ALLEN CSK SCREW BSW THREAD AS PER (BS 2470)

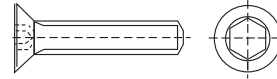

TABLE - 6B

DIA	1/2"	3/4"	1"	1.1/4"	1.1/2"	2"	2.1/2"	3"		
3/16"	724	859	950	1041	1221	1357	-	-		
1/4"	905	905	1041	1131	1312	1493	1855	-		
5/16"	-	2081	2262	2398	2760	3121	3665	4388		
3/8"	-	3439	3439	3619	4162	4705	5429	6515		
1/2"	-	-	7420	8143	10858	14477	17191	18096		

STAINLESS STEEL 304-A2 ALLEN GRUB SCREW (DIN 916)

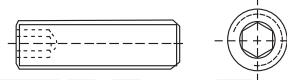

TABLE - 6C

DIA	3	4	5	6	8	10	12	16	20	25	30	35	40	45	50	55	60	65
3	146	132	136	146	169	201	275	549	731	-	-	-	-	-	-	-	-	-
4	198	155	164	178	216	243	293	396	516	705	942	-	-	-	-	-	-	-
5	263	189	198	225	283	340	396	545	705	1016	1269	1598	2023	-	-	-	-	-
6	-	298	262	273	344	426	516	706	905	1205	1512	1811	2264	2898	3622	-	-	-
8	-	-	-	499	589	726	905	1268	1631	2175	2717	3124	3577	4213	4982	5798	6264	-
10	-	-	-	870	870	1047	1290	1830	2395	3136	3874	4703	5660	6531	7404	8273	9580	-
12	-	-	-	-	1567	1610	2623	2700	3527	4573	5617	6792	7838	9143	10451	11757	13498	17416
16	-	-	-	-	-	-	6270	6967	8100	9143	10885	12627	14371	15677	17416	19159	21336	-

STAINLESS STEEL 304-A2 BUTTON HEAD CAP SCREW (ISO 7380)

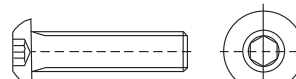
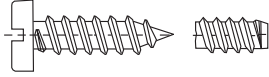

TABLE - 6D

DIA	6	8	10	12	16	20	25	30	35	40	50	60
3	143	143	145	163	204	243	273	-	-	-	-	-
4	174	174	171	192	231	284	331	382	464	562	-	-
5	271	271	270	281	337	401	468	558	651	698	-	-
6	-	-	357	389	462	554	645	762	897	1010	1223	-
8	-	-	-	-	1012	1096	1296	1512	1674	1933	2214	2552
10	-	-	-	-	-	2268	2497	2940	3229	3366	3805	4546
12	-	-	-	-	-	4775	5252	5703	6333	7390	8525	9790

STAINLESS STEEL 304-A2 PAN PHILIPS (DIN 7981) TABLE - 7A
PAN SLOTTED (DIN 7971) SELF TAPPING SCREW



DIA	4	6	8	10	12	14
6.5	119	150	-	-	-	-
9.5	129	167	222	288	441	-
13	136	178	244	318	488	-
16	152	202	278	369	541	718
19	198	237	304	410	541	787
25	-	287	360	485	709	956
32	-	336	436	580	862	1144
38	-	-	517	674	992	1272
50	-	-	716	798	1181	1707
60	-	-	931	1118	1535	-
75	-	-	1211	1453	2149	-
100	-	-	1695	1961	3009	-

STAINLESS STEEL 304-A2 CSK PHILIPS (DIN 7982) TABLE - 7B
CSK SLOTTED (DIN 7972) SELF TAPPING SCREW

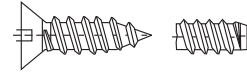

DIA	4	6	8	10	12	14
6.5	103	123	-	-	-	-
9.5	116	140	180	230	343	-
13	129	154	204	255	380	-
16	145	178	234	280	436	544
19	-	210	258	332	493	631
25	-	266	320	414	612	785
32	-	314	397	488	759	999
38	-	-	475	595	771	1142
50	-	-	692	870	1032	1694
60	-	-	899	1218	1341	-
75	-	-	1169	1584	1878	-
100	-	-	1637	2138	2629	-

STAINLESS STEEL 304-A2 DOM NUT (DIN 1587)



TABLE - 7C

SIZE	M 3	M 4	M 5	M 6	M 8	M 10	M 12	M 16	M 20	M 24
304	351	362	433	588	1154	2442	3586	7898	14942	43633

STAINLESS STEEL 304-A2 NYLOCK NUT (DIN 982 / DIN 985)

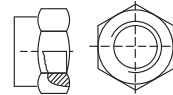

TABLE - 7D

SIZE	M 3	M 4	M 5	M 6	M 8	M 10	M 12	M 16	M 20	M 24	M 27	M 30
304	259	239	304	467	832	1546	2433	5260	16538	50905	70370	92332

STAINLESS STEEL 304-A2 SQUARE NUT (DIN 557) TABLE - 7E

DIA	M5	M6	M8	M10	M12
304Q	351	351	690	1510	2301

STAINLESS STEEL 304-A2 HEX NUT (H=D) TABLE - 7F

SIZE	M6x6	M8x8	M10x10	M12x12	M16x16	M18x18	M20x20	M22x22	M24x24
304Q	323	645	1425	2075	4247	7241	9145	13079	14696

STAINLESS STEEL 304-A2 FLANGE NUT (DIN 6923) TABLE - 7G

DIA	M5	M6	M8	M10	M12
304Q	345	391	777	1390	2450

STAINLESS STEEL 304-A2 WELD NUT (DIN 929) TABLE - 7H

DIA	M5	M6	M8	M10	M12
304Q	365	415	820	1460	2575

STAINLESS STEEL 304-A2 HEAVY HEX NUT (ANSI B18.2.2) TABLE - 7I

DIA	5/16" UNC	3/8" UNC	1/2" UNC	5/8" UNC	3/4" UNC	7/8" UNC
304Q	1375	1926	3000	5210	8804	15610

STAINLESS STEEL 304-A2 WING NUT (DIN 315) LIGHT TABLE - 7J

SIZE	M 3	M 4	M 5	M 6	M 8	M 10	M 12
304	1337	1339	1453	1850	2871	3617	7990

STAINLESS STEEL 304-A2 WING NUT (HEAVY) TABLE - 7K

DIA	M5	M6	M8	M10	M12	M16	M20	M24
HEAVY	5954	6351	10320	13020	21831	33342	67477	98597
DIA	3/16"	1/4"	5/16"	3/8"	1/2"	5/8"	3/4"	1"
HEAVY	5954	6351	10320	13020	21831	33342	67477	98597

STAINLESS STEEL 316-A4 HEX SCREW (DIN 933 / IS 1363)

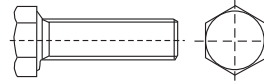

TABLE - 8A

DIA	10	12	16	20	25	30	35	40	45	50	55	60	65	70	75	80	85	90	100
5	630	640	724	819	912	1020	1126	1230	1365	1482	1629	1716	1897	1997	2156	-	-	-	-
6	681	694	782	882	982	1097	1212	1323	1475	1600	1762	1855	2058	2165	2341	2438	2756	2820	3093
8	-	-	1597	1780	1982	2194	2403	2608	2853	3030	3278	3454	3731	3871	4076	4351	4713	4892	5260
10	-	-	3031	3312	3623	3927	4222	4562	4890	5234	5570	5914	6365	6552	7039	7246	7796	7947	8499
12	-	-	-	4939	5348	5813	6314	6797	7092	7764	8050	8722	8979	9678	10200	10691	11019	11725	12713
14	-	-	-	-	8278	8809	9463	9985	10697	11315	12128	12562	13464	13986	14690	15387	16740	17597	18102
16	-	-	-	-	10787	11291	12163	13043	13869	14798	15686	16673	17327	18241	18967	20231	21182	22050	23637
18	-	-	-	-	-	-	-	21418	23024	24190	25133	26476	27908	29504	30771	32234	33489	34847	37372
20	-	-	-	-	-	-	-	22545	24236	25463	26456	27869	29377	31057	32391	33930	35252	36681	39339
22	-	-	-	-	-	-	-	-	-	38759	40905	43023	45065	47310	49237	51328	53390	53789	57908
24	-	-	-	-	-	-	-	-	-	40444	42683	44894	47024	49367	51378	53560	55711	56128	60426

STAINLESS STEEL 316-A4 HEX SCREW (BS - 1083)



TABLE - 8B

BSW	1/2"	3/4"	1"	1.1/4"	1.1/2"	2"	2.1/2"	3"	3.1/2"	4"	5"	6"	7"	8"
1/4"	870	1010	1168	1354	1496	1817	2266	2619	2881	3275	-	-	-	-
5/16"	1542	1774	2036	2294	2560	3072	3603	4134	4793	5819	-	-	-	-
3/8"	2394	2740	3105	3487	3871	4630	5385	6146	6899	7664	9811	11761	-	-
1/2"	-	-	6572	7275	7917	9231	10595	11961	13310	14621	17310	19728	-	-
5/8"	-	-	12027	12454	13457	15724	17686	20694	21701	23647	29207	33563	-	-
3/4"	-	-	-	-	26769	29525	33117	36754	40356	44125	51480	58834	-	-
7/8"	-	-	-	-	-	38586	44260	49176	54632	59976	70431	81215	91109	101730
1"	-	-	-	-	-	51139	57502	63770	69959	77705	90086	103353	116619	129888

STAINLESS STEEL 316-A4 LONG LENGTH HEX SCREW (DIN 933 / IS 1363)

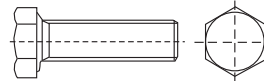

TABLE - 8C

DIA	110	120	125	130	140	150	160	170	175	180	190	200
6	5149	5737	6707	7407	8265	8784	-	-	-	-	-	-
8	5772	6189	6390	6678	7203	7651	-	-	-	-	-	18033
10	9379	10174	10551	10865	11440	12096	13304	16365	16605	17806	18648	19489
12	13322	14406	15063	15748	16641	17834	18917	25663	26748	27833	30359	32885
14	23385	25101	25921	26722	28235	30341	32332	35773	37252	38730	40396	42061
16	25804	27698	28603	29486	31156	33480	35677	39474	41106	42737	44575	46412
18	40022	42532	43834	45377	48086	50937	53252	56031	57304	58577	61423	64269
20	43267	45980	47388	49056	51985	55067	57570	60574	61951	63327	66404	69480
22	64362	68653	70832	73154	77383	81630	85816	89848	92062	94277	98628	102980
24	67160	71638	73912	76335	80747	85179	89547	93754	96065	98376	102917	107457

STAINLESS STEEL 316-A4 HEX NUT (DIN 934 / IS 1363)

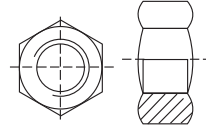

TABLE - 9A

SIZE	M 2	M 2.5	M 3	M 4	M 5	M 6	M 8	M 10	M 12	M 14	M 16	M 18	M 20	M 22	M 24	M 27	M 30	M 33	M 36
316	319	316	128	166	213	364	729	1580	2416	4174	4869	9350	9350	15614	15614	31543	41571	50166	68631

STAINLESS STEEL 316-A4 HEX NUT (BS 1083)

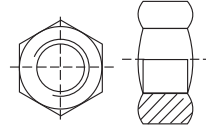

TABLE - 9B

DIA	1/8"	5/32"	3/16"	1/4"	5/16"	3/8"	7/16"	1/2"	5/8"	3/4"	7/8"	1"
316Q	264	289	293	571	823	1368	3159	3569	6413	11918	14093	21695

STAINLESS STEEL 316-A4 LOCK NUT (DIN 439)



TABLE - 9C

SIZE	M 5	M 6	M 8	M 10	M 12	M 14	M 16	M 20	M 24			
316	269	328	664	1132	2192	3527	4386	8688	14633			

STAINLESS STEEL 316-A4 DOM NUT

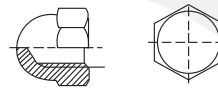

TABLE - 9D

SIZE	M 4	M 5	M 6	M 8	M 10	M 12	M 16	M 20	M 24
316	443	494	887	1730	3646	5302	11378	17828	60745

STAINLESS STEEL 316-A4 HEX NYLOCK NUT (DIN 982 / DIN 985)

TABLE - 9E

DIA	M3	M4	M5	M6	M8	M10	M12	M16	M20	M24
316Q	375	347	441	677	1206	2242	3527	7628	20735	70392

STAINLESS STEEL 316-A4 HEAVY HEX NUT (ANSI B18.2.2)

TABLE - 9F

DIA	5/16" UNC	3/8" UNC	1/2" UNC	5/8" UNC	3/4" UNC	7/8" UNC			
316Q	1926	2559	4420	8730	14905	21196			

STAINLESS STEEL 316-A4 HEIGHT DIA NUT (DIN 5587)

TABLE - 9G

SIZE	M6 X 6	M8 X 8	M10 X 10	M12 X 12	M16 X 16	M18 X 18	M20 X 20	M22 X 22	M24 X 24
316Q	478	986	2069	3029	6244	1251	13250	19829	20869

STAINLESS STEEL 316-A4 THREADED ROD 1 MTR LENGTH (DIN 975)

TABLE - 9H

SIZE	M 5	M 6	M 8	M 10	M 12	M 14	M 16	M 18	M 20	M 22	M 24
316	21873	23982	41584	64526	93801	131343	171753	223108	274783	344756	410962

STAINLESS STEEL 316-A4 THREADED ROD 1 MTR LENGTH (BS 1083 / ANSI B18.2.1)

TABLE - 9I

SIZE	1/4"	5/16"	3/8"	1/2"	5/8"	3/4"	7/8"	1"
304	27075	41480	60457	111969	172017	251100	345663	467800



Empowering SMEs & MSMEs, Empowering Growth

**STAINLESS STEEL 316-A4 PLAIN WASHER
(DIN 125 / IS 2016)**

TABLE - 10A

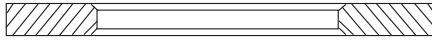

THICK	1.2MM	1.6MM	2MM	2.5MM	3MM	IS
M3 (1/8")	160	-	-	-	-	160
M4 (5/32")	180	-	-	-	-	180
M5 (3/16")	210	-	-	-	-	210
M6 (1/4")	225	300	-	-	-	300
M8 (5/16")	330	425	550	-	875	425
M10 (3/8")	500	700	800	-	1400	800
M12 (1/2")	700	900	1125	1400	1870	1400
M14 (9/16")	775	1200	1500	1900	2050	2050
M16 (5/8")	900	1400	1600	-	2450	2450
M18	-	1600	2000	-	3100	3100
M20 (3/4")	1350	1850	2300	-	3500	3500
M22 (7/8")	-	-	-	-	4000	4000
M24 (1")	-	-	-	-	5000	6600
M27 (1.1/8")	-	-	-	-	6750	8800
M30 (1.1/4")	-	-	-	-	7950	10700
M33 (1.3/8")	-	-	-	-	12200	15000
M36 (1.1/2")	-	-	-	-	12800	18800

STAINLESS STEEL 316-A4 SPRING WASHER (DIN 127 / IS 3063)

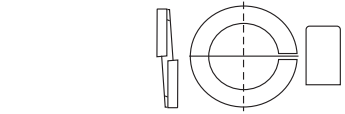

BSW	SQUARE	FLAT
M3 (1/8")	150	200
M4 (5/32")	160	220
M5 (3/16")	200	250
M6 (1/4")	230	275
M8 (5/16")	300	475
M10 (3/8")	500	700
M12 (1/2")	600	1100
M14 (9/16")	950	1400
M16 (5/8")	1400	2325
M18	1600	2800
M20 (3/4")	2500	4067
M22 (7/8")	3300	4600
M24 (1")	5050	6700
M27 (1.1/8")	5500	8200
M30 (1.1/4")	7700	11000
M33 (1.3/8")	14000	16500
M36 (1.1/2")	16200	17800

STAINLESS STEEL 316-A4 ALLEN CAP SCREW (DIN 912)



TABLE - 10C

DIA	6	8	10	12	16	20	25	30	35	40	45	50	60	70	75	80	90	100
3	404	417	425	433	494	547	643	-	-	-	-	-	-	-	-	-	-	-
4	536	536	472	510	573	640	709	881	1000	1164	-	-	-	-	-	-	-	-
5	-	-	654	688	780	867	990	1131	1313	1517	1677	1837	-	-	-	-	-	-
6	-	-	940	966	1072	1163	1275	1431	1559	1806	1992	2118	2577	2886	3183	3512	4073	4866
8	-	-	-	2229	2135	2247	2471	2839	3049	3283	3609	3784	4364	5030	5670	6047	6909	7408
10	-	-	-	-	-	3897	4410	4653	5062	5559	5922	6377	7197	8206	8636	9146	11310	12464
12	-	-	-	-	-	-	7088	7335	7856	8494	9257	9699	10961	11692	12730	13696	14837	16145
16	-	-	-	-	-	-	-	-	16289	17876	19358	20040	22503	24672	26193	28860	31789	34494
20	-	-	-	-	-	-	-	-	-	36680	38298	40779	45124	49770	51904	54201	58778	63378



Empowering SMEs & MSMEs, Empowering Growth



WHY STAINLESS STEEL FASTENERS ?

- ✎ Excellent corrosion resistance
- ✎ High ductility and strength
- ✎ Non-magnetic (Austenitic only)
- ✎ Resistance to unsightly staining
- ✎ Aesthetic surface finish
- ✎ 60% recycled content, 100% recyclable
- ✎ Excellent high and low temperature properties
- ✎ High Resistance to elevated temperature
- ✎ Very low temperature environments prevent brittleness
- ✎ Hassel-free maintenance

